

**BEGIN STP 2936(1) U.S. ROUTE 5
LYNDON STA. 139+49.76 = (MM 2.642)**

TO
ST. JOHNSBURY

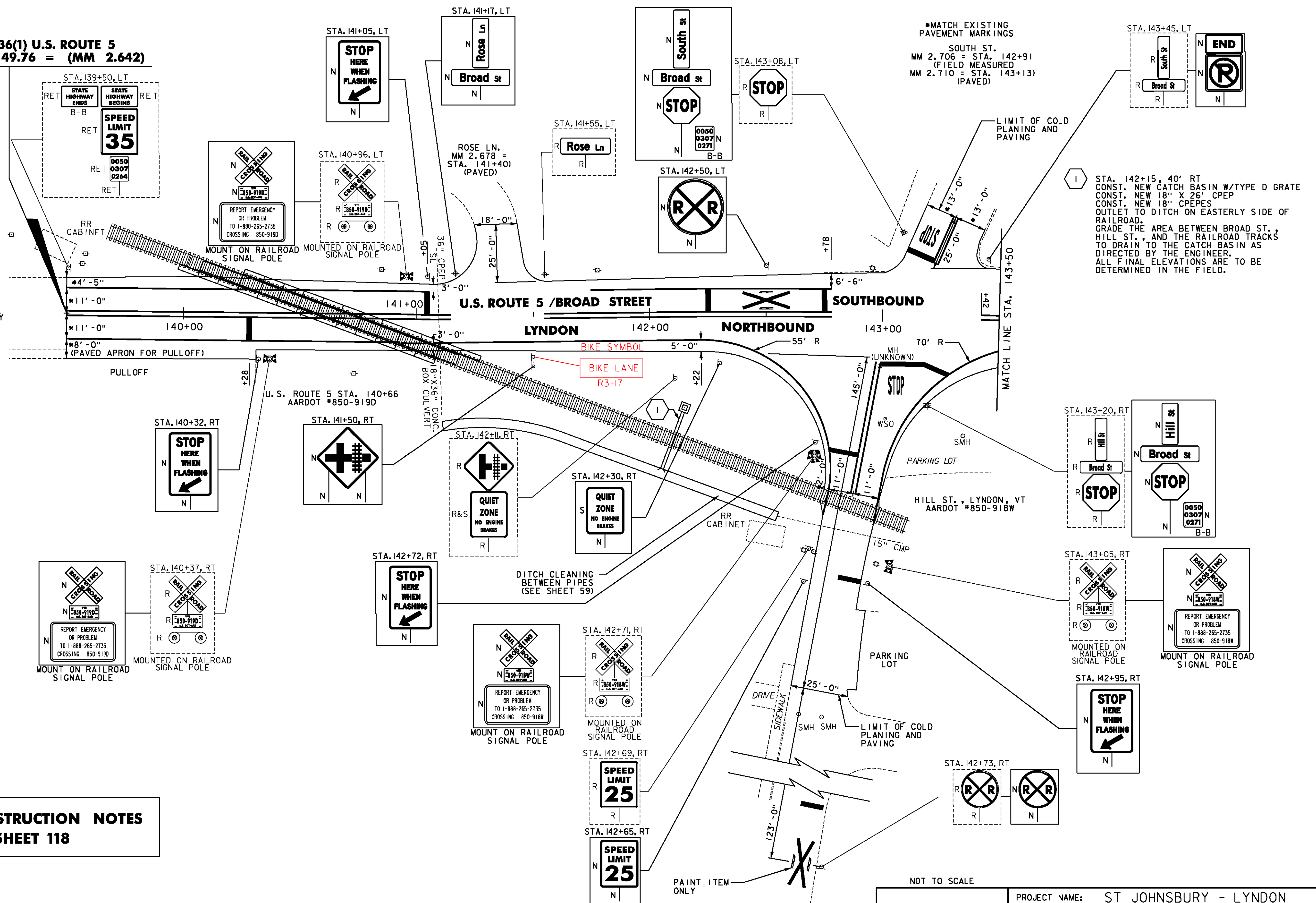

*MATCH EXISTING
PAVEMENT MARKINGS
SOUTH ST.
MM 2.706 = STA. 142+91
(FIELD MEASURED)
MM 2.710 = STA. 143+13
(PAVED)

STA. 142+15, 40' RT
CONST. NEW CATCH BASIN W/TYPE D GRATE
CONST. NEW 18" X 26' CPEP
CONST. NEW 18" CPEPES
OUTLET TO DITCH ON EASTERLY SIDE OF
RAILROAD.
GRADE THE AREA BETWEEN BROAD ST.,
HILL ST., AND THE RAILROAD TRACKS
TO DRAIN TO THE CATCH BASIN AS
DIRECTED BY THE ENGINEER.
ALL FINAL ELEVATIONS ARE TO BE
DETERMINED IN THE FIELD.

**FOR ALL CONSTRUCTION NOTES
SEE SHEET 118**

- NOTES:
- FOR LEGENDS, SEE SHEET 3.
 - ALL EXISTING SIGNS NOT SHOWN ON THE PLANS SHALL BE RETAINED.
 - SEE SHEETS 46-52 FOR RAILROAD CROSSING DETAILS.

HILL ST.
MM 2.700 = STA. 142+61
(FIELD MEASURED)
MM 2.708 = STA. 143+02
(PAVED)



<p>PROJECT LAYOUT SHEET #53A</p>	NOT TO SCALE	
	PROJECT NAME: ST JOHNSBURY - LYNDON	PROJECT NUMBER: STP 2936(1)
	FILE NAME: p11c308.dgn PROJECT LEADER: G. EDWARDS DESIGNED BY: D. DRAPER	PLOT DATE: 5/5/2014 DRAWN BY: D. DRAPER CHECKED BY: J. LITTLE SHEET 117 OF 250