

**BEGIN STP 2936(1) U.S. ROUTE 5
LYNDON STA. 139+49.76 = (MM 2.642)**

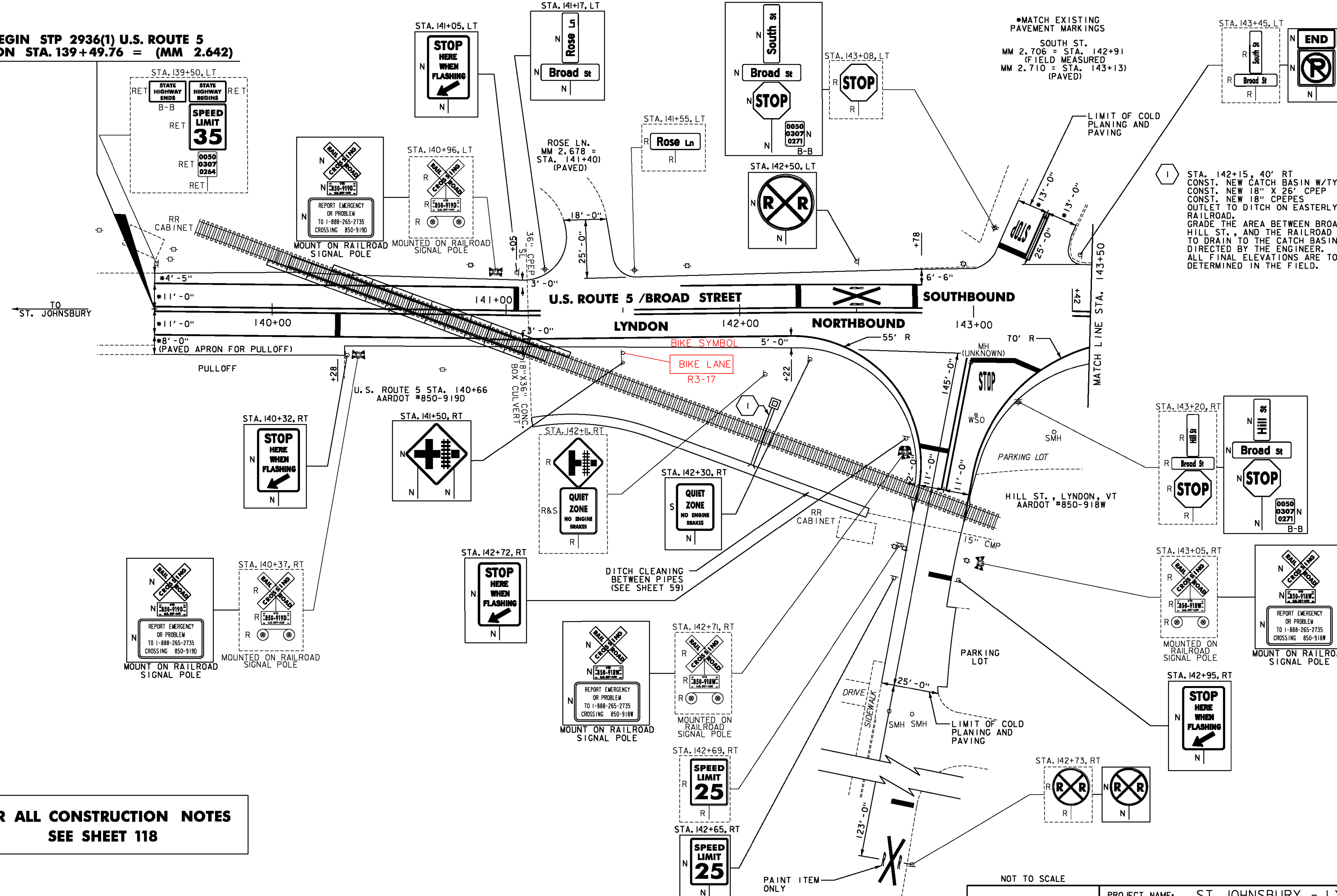

*MATCH EXISTING PAVEMENT MARKINGS
SOUTH ST.
MM 2.706 = STA. 142+91
(FIELD MEASURED)
MM 2.710 = STA. 143+13
(PAVED)

STA. 142+15, 40' RT
CONST. NEW CATCH BASIN W/TYPE D GRATE
CONST. NEW 18" X 26' CPEP
CONST. NEW 18" CPEPES
OUTLET TO DITCH ON EASTERLY SIDE OF RAILROAD.
GRADE THE AREA BETWEEN BROAD ST., HILL ST., AND THE RAILROAD TRACKS TO DRAIN TO THE CATCH BASIN AS DIRECTED BY THE ENGINEER.
ALL FINAL ELEVATIONS ARE TO BE DETERMINED IN THE FIELD.

**FOR ALL CONSTRUCTION NOTES
SEE SHEET 118**

- NOTES:
- FOR LEGENDS, SEE SHEET 3.
 - ALL EXISTING SIGNS NOT SHOWN ON THE PLANS SHALL BE RETAINED.
 - SEE SHEETS 46-52 FOR RAILROAD CROSSING DETAILS.

HILL ST.
MM 2.700 = STA. 142+61
(FIELD MEASURED)
MM 2.708 = STA. 143+02
(PAVED)



<p>PROJECT LAYOUT SHEET #53A</p>	<p>PROJECT NAME: ST JOHNSBURY - LYNDON</p> <p>PROJECT NUMBER: STP 2936(I)</p>
	<p>FILE NAME: pllc308.dgn</p> <p>PROJECT LEADER: G. EDWARDS</p> <p>DESIGNED BY: D. DRAPER</p>
	<p>PLOT DATE: 5/5/2014</p> <p>DRAWN BY: D. DRAPER</p> <p>CHECKED BY: J. LITTLE</p> <p>SHEET 117 OF 250</p>