

THINNING AND TRIMMING FOR SIGNS

STA. 51+59, RT
SEE SHEET 241 (TYP.)

CHANGING ELEVATION OF DIS., CBS OR MHS

SEE SHEET 27

REHAB. DIS., CBS OR MHS, CLASS I, II, OR III

SEE SHEETS 27-28

CHANGING ELEVATION OF SEWER MANHOLES

SEE SHEET 28

CAST-IN-PLACE CONCRETE CURB, TYPE B

STA. 50+75, RT

REMOVAL OF EXISTING CURB

STA. 50+75, RT

PORTLAND CEMENT CONCRETE SIDEWALK, 5 INCH

STA. 50+00, LT
STA. 50+33, LT
STA. 50+55, RT
STA. 50+75, RT
STA. 51+03, LT
STA. 51+13, RT

DETECTABLE WARNING SURFACE

STA. 50+00, LT
STA. 50+33, LT
STA. 50+55, RT
STA. 50+75, RT
STA. 51+03, LT
STA. 51+13, RT

ADJUST ELEVATION OF VALVE BOX

SEE SHEETS 28-29

DURABLE & TEMPORARY 4 INCH WHITE LINE

(ALL LINES WILL INCLUDE EDGE LINE BREAKS AND RADII FOR SIDE ROADS)
STA. 50+00 TO 50+20, DOTTED RT
STA. 50+00 TO 50+98, SOLID LT (LANE LINE)
STA. 50+00 TO 51+33, SOLID LT
STA. 50+20 TO 55+00, SOLID RT
STA. 50+72, SOLID LT (EDGE LINES, MT. PLEASANT ST. TH-310)
STA. 51+64 TO 52+38, SOLID LT
STA. 52+62 TO 53+58, DOTTED LT
STA. 52+94, SOLID LT (EDGE LINES, SUMMER ST. TH-506)
STA. 53+58 TO 55+00, SOLID LT

DURABLE & TEMPORARY 4 INCH YELLOW LINE

(ALL LINES WILL INCLUDE $\frac{1}{2}$ BREAKS FOR SIDE ROADS & CROSSWALKS)
STA. 50+00 TO 50+99, DOUBLE SOLID LT
STA. 50+21, DOUBLE SOLID LT (CLINTON AVE. TH-318)
STA. 50+72, DOUBLE SOLID LT (MT. PLEASANT ST. TH-310)
STA. 51+44 TO 53+58, DOUBLE SOLID LT & RT
STA. 52+94, DOUBLE SOLID LT (SUMMER ST. TH-506)
STA. 53+58 TO 55+00, SOLID LT & RT

DURABLE & TEMPORARY 8 INCH WHITE LINE

STA. 51+48 TO 51+64, LT (GORE & DIAGONALS)
STA. 52+38 TO 52+62, LT (GORE & DIAGONALS)
SEE SHEET 55 (TYP.)

DURABLE & TEMPORARY 8 INCH YELLOW LINE

STA. 51+44 TO 52+72, LT & RT (DIAGONALS)
SEE SHEET 55

DURABLE & TEMPORARY 24 INCH STOP BAR

STA. 50+21, LT (CLINTON AVE. TH-318)
STA. 52+94, LT (SUMMER ST. TH-506)

DURABLE & TEMPORARY LETTER OR SYMBOL

STA. 50+21, LT "STOP" (CLINTON AVE. TH-318)
STA. 50+72, LT YIELD BAR (3) (MT. PLEASANT ST. TH-310)
SEE SHEET 55
STA. 52+94, LT "STOP" (SUMMER ST. TH-506)

DURABLE CROSSWALK MARKING, TYPE A TAPE

STA. 50+21, LT (CLINTON AVE. TH-318)
STA. 50+62, RT (GREEN ST. TH-418)
STA. 51+03, LT TO 51+13, RT
SEE SHEET 55 (TYP.)

TEMPORARY CROSSWALK MARKING, PAINT

STA. 50+21, LT (CLINTON AVE. TH-318)
STA. 50+62, RT (GREEN ST. TH-418)
STA. 51+03, LT TO 51+13, RT
SEE SHEET 55 (TYP.)

REMOVING SIGNS

AS SHOWN - 35

ERECTING SALVAGED SIGNS

AS SHOWN - 1

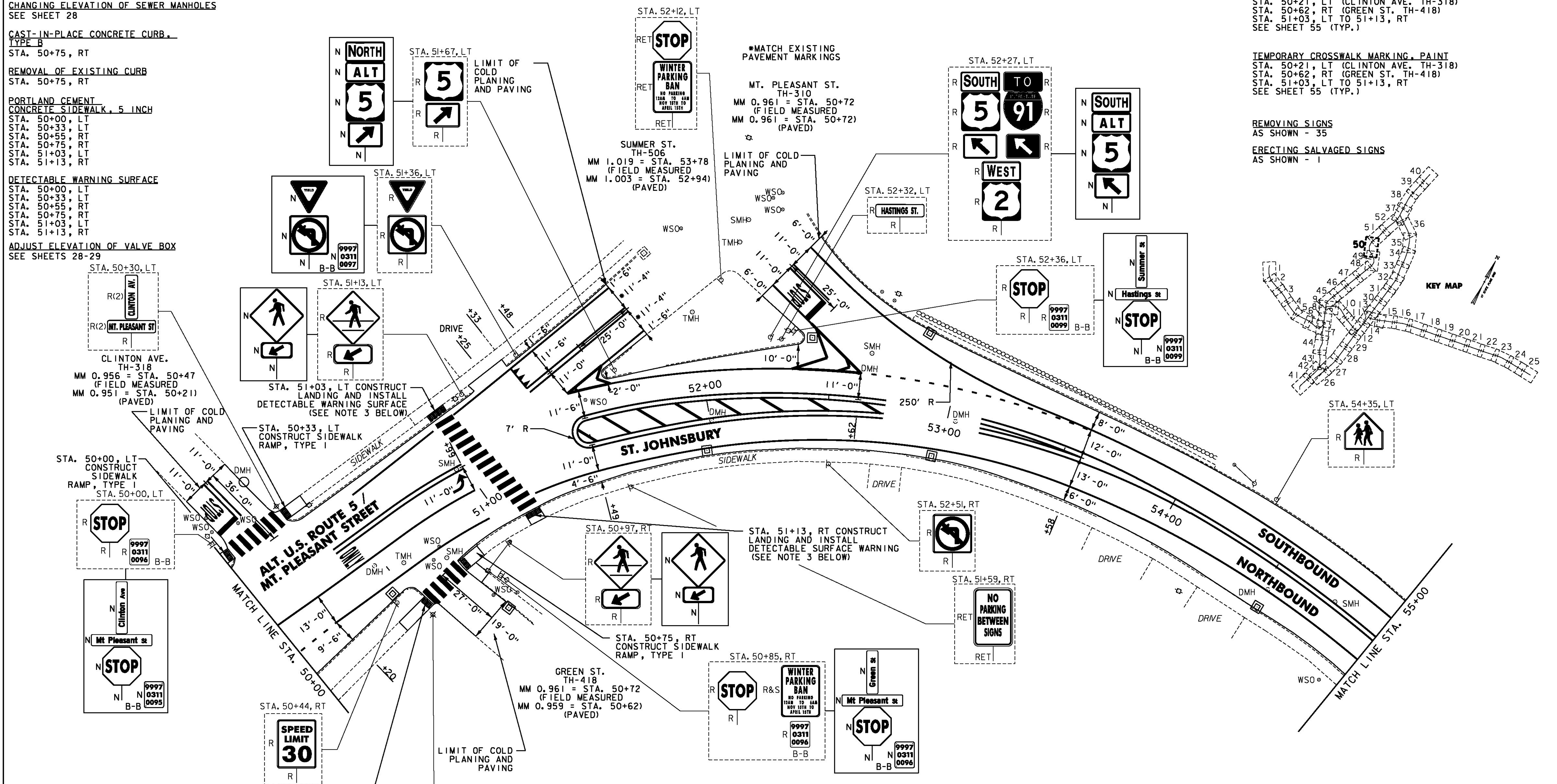

- NOTES:
- FOR LEGENDS, SEE SHEET 3.
 - ALL EXISTING SIGNS NOT SHOWN ON THE PLANS SHALL BE RETAINED.
 - THE SIDEWALK "LANDINGS" NOTED CONSIST OF THE REMOVAL AND REPLACEMENT OF A SINGLE SLAB OF CONCRETE SIDEWALK IN ORDER TO INSTALL A NEW DETECTABLE WARNING SURFACE. SEE SHEETS 12-25.

<p>NOT TO SCALE</p> <p>PROJECT LAYOUT SHEET #50</p>	<p>PROJECT NAME: ST JOHNSBURY - LYNDON</p> <p>PROJECT NUMBER: STP 2936(1)</p>
	<p>FILE NAME: pllc308.dgn</p> <p>PROJECT LEADER: G. EDWARDS</p> <p>DESIGNED BY: D. DRAPER</p>