

CHANGING ELEVATION OF DIS, CBS OR MHS
SEE SHEET 27

REHAB, DIS, CBS OR MHS, CLASS I, II, OR III
SEE SHEETS 27-28

CHANGING ELEVATION OF SEWER MANHOLES
SEE SHEET 28

TREATED TIMBER CURB
STA. 15+00 TO 17+50, RT

PORTLAND CEMENT CONCRETE SIDEWALK, 5 INCH
STA. 20+13, LT
STA. 20+50, LT

DETECTABLE WARNING SURFACE
STA. 20+13, LT
STA. 20+50, LT

STEEL BEAM GUARDRAIL, GALVANIZED
STA. 17+50 TO 17+75, RT

STEEL BEAM GUARDRAIL, GALVANIZED W/8 FEET POSTS
STA. 15+00 TO 17+50, RT

ANCHOR FOR STEEL BEAM RAIL
STA. 17+75, RT

REMOVAL AND DISPOSAL OF GUARDRAIL
STA. 15+00 TO 17+75, RT

ADJUST ELEVATION OF VALVE BOX
SEE SHEETS 28-29

DURABLE & TEMPORARY 4 INCH WHITE LINE
(ALL LINES WILL INCLUDE EDGE LINE BREAKS AND RADIUS FOR SIDE ROADS)
STA. 15+00 TO 21+00, SOLID LT & RT
STA. 20+56, SOLID LT (EDGE LINES, FAIRBANKS DR. TH-364)

DURABLE & TEMPORARY 4 INCH YELLOW LINE
(ALL LINES WILL INCLUDE EDGE LINE BREAKS FOR SIDE ROADS)
STA. 15+00 TO 21+00, SOLID LT & RT
STA. 20+56, DOUBLE SOLID LT (FAIRBANKS DR. TH-364)

DURABLE & TEMPORARY 24 INCH STOP BAR
STA. 20+56, LT (FAIRBANKS DR. TH-364)

DURABLE & TEMPORARY LETTER OR SYMBOL
STA. 19+16, RT "SCHOOL"
STA. 20+56, LT "STOP" (FAIRBANKS DR. TH-364)

DURABLE CROSSWALK MARKING, TYPE A TAPE
STA. 20+56, LT (FAIRBANKS DR. TH-364)
SEE SHEET 55 (TYP.)

TEMPORARY CROSSWALK MARKING, PAINT
STA. 20+56, LT (FAIRBANKS DR. TH-364)
SEE SHEET 55 (TYP.)

REMOVING SIGNS
AS SHOWN - II

ERECTING SALVAGED SIGNS
AS SHOWN - I

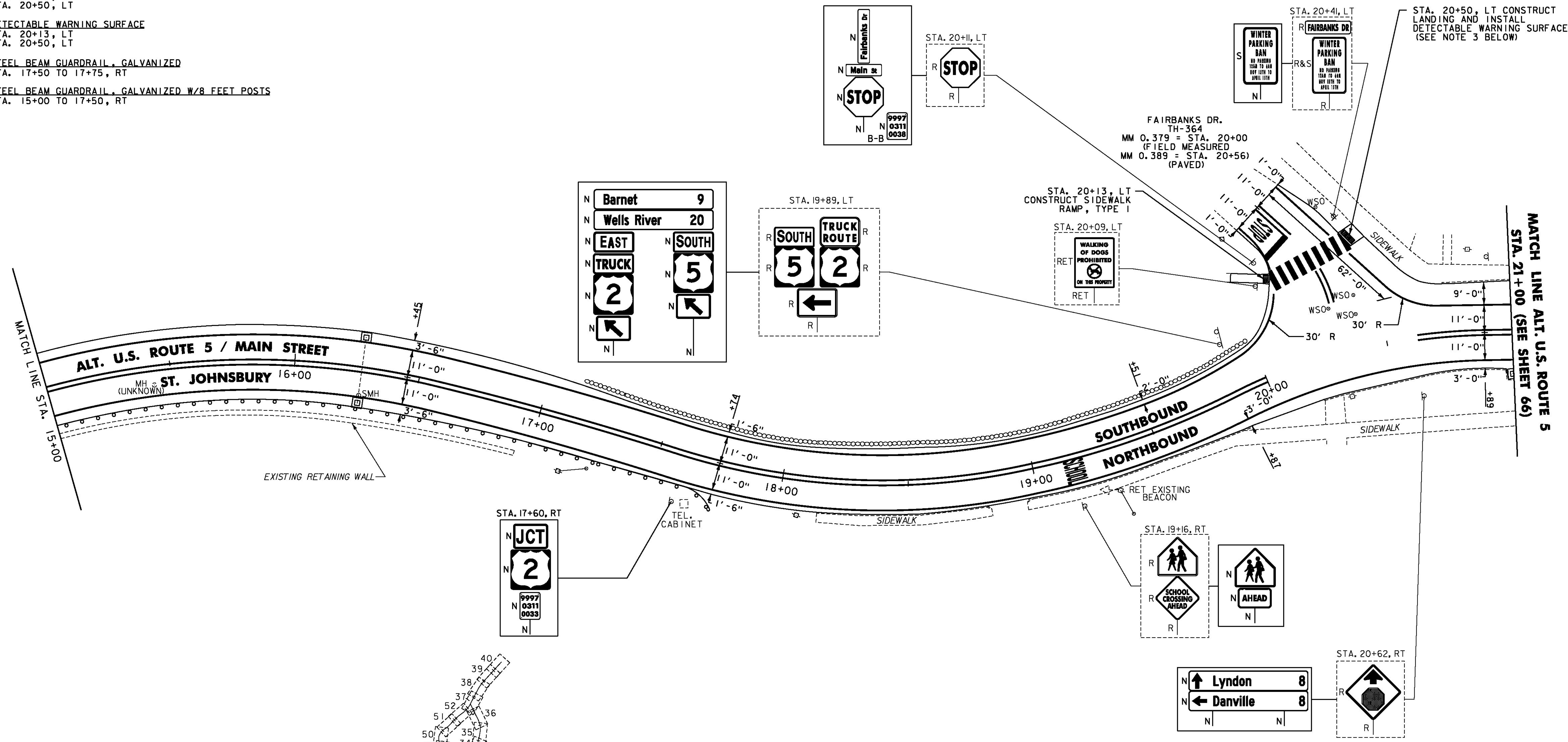

- NOTES:
- FOR LEGENDS, SEE SHEET 3.
 - ALL EXISTING SIGNS NOT SHOWN ON THE PLANS SHALL BE RETAINED.
 - THE SIDEWALK "LANDINGS" NOTED CONSIST OF THE REMOVAL AND REPLACEMENT OF A SINGLE SLAB OF CONCRETE SIDEWALK IN ORDER TO INSTALL A NEW DETECTABLE WARNING SURFACE. SEE SHEETS 12-25.

<p>NOT TO SCALE</p> <p>PROJECT LAYOUT SHEET #44</p>	PROJECT NAME: ST JOHNSBURY - LYNDON
	PROJECT NUMBER: STP 2936(I)
	FILE NAME: pllc308.dgn
DESIGNED BY: D. DRAPER	PLOT DATE: 5/5/2014
CHECKED BY: J. LITTLE	DRAWN BY: D. DRAPER
	SHEET 108 OF 250

