

**RAILROAD CROSSING ROAD CLOSURE PLAN
AARDOT 850-939P
(SEE NOTE 1)**

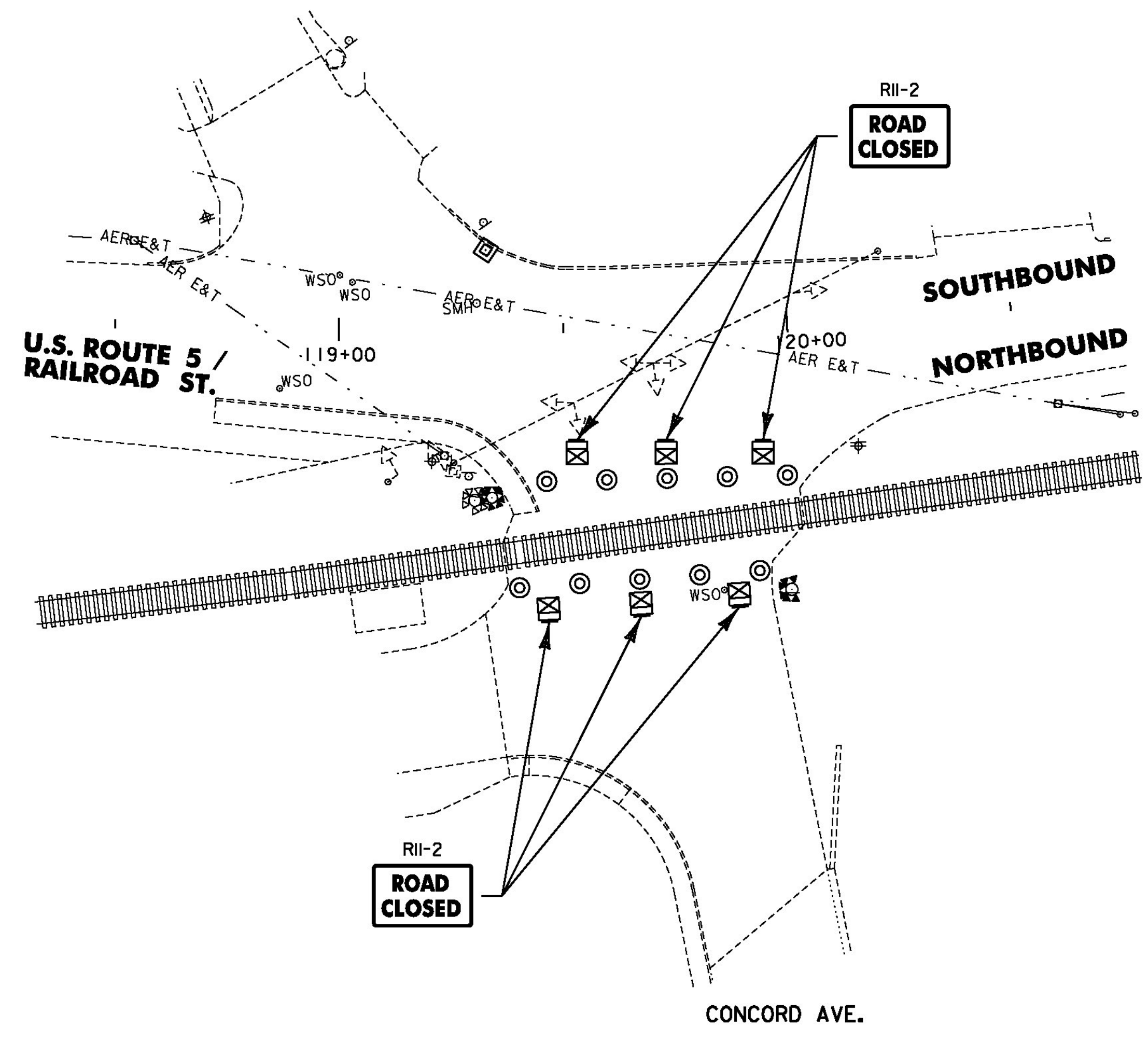

**RAILROAD CROSSING ROAD CLOSURE PLAN
AARDOT 850-938H
(SEE NOTE 1)**

NOTES

1. THIS PLAN SHOWS ROAD CLOSURES FOR THE AARDOT #850-939P AND AARDOT #850-938H CROSSINGS. ONLY ONE ROAD CLOSURE IS ALLOWED AT A TIME.
2. ALL TRAFFIC CONTROL DETAILS MUST BE DESIGNED AND IMPLEMENTED IN ACCORDANCE WITH SECTION 6 OF THE LATEST EDITION OF THE MANUAL ON UNIFORM TRAFFIC CONTROL DEVICES (MUTCD) AND THE MOST RECENT VAOT STANDARDS.
3. THE CONTRACTOR SHALL MAINTAIN PEDESTRIAN ACCESS AT ALL TIMES IN CONFORMANCE WITH MUTCD SECTION 6D AND THE TEMPORARY PEDESTRIAN TRAFFIC CONTROL NOTES ON SHEET 247.
THE CONTRACTOR SHALL MAINTAIN DRIVE ACCESS AT ALL TIMES.
4. ALL WORK DEPICTED ON THIS SHEET SHALL BE INCLUDED IN THE UNIT PRICE BID FOR EITHER ITEM 900.645 SPECIAL PROVISION (TRAFFIC CONTROL, RAIL-HIGHWAY CROSSING) (AARDOT 850-939P) OR ITEM 900.645 SPECIAL PROVISION (TRAFFIC CONTROL, RAIL-HIGHWAY CROSSING) (AARDOT 850-938H) AS APPLICABLE.

LEGEND

- = TYPE 3 BARRICADE
- ⊠ = TYPE 3 BARRICADE (MOD.)
- ⊙ = REFLECTORIZED PLASTIC DRUM

NOT TO SCALE

**RAILROAD
CROSSING
DETAIL
SHEET #5**

**ROAD CLOSURE PLAN FOR CROSSING
AARDOT #850-939P & AARDOT #850-938H**

PROJECT NAME: ST JOHNSBURY - LYNDON	PLOT DATE: 7/25/2014
PROJECT NUMBER: STP 2936(I)	DRAWN BY: D. DRAPER
FILE NAME: pllc308.dgn	CHECKED BY: J. LITTLE
PROJECT LEADER: G. EDWARDS	SHEET 36 OF 250
DESIGNED BY: D. DRAPER	

