

**INDEX OF SHEETS**

- 1 TITLE SHEET
- 2 INDEX OF SHEETS
- 3 ST. JOHNSBURY KEY PLAN SHEET & LEGENDS
- 4-7 PROJECT TYPICAL SECTION SHEETS I-4
- 8-11 QUANTITY SHEETS I-4
- 12-25 ITEM DETAIL SUMMARY SHEETS I-14
- 26 DRIVE DETAIL SHEET
- 27-29 STRUCTURE INVENTORY SHEETS I-3
- 30-31 BRIDGE DETAIL SHEETS I-2
- 32-53 RAILROAD CROSSING DETAIL SHEETS I-22
- 54-58 MISCELLANEOUS DETAIL SHEETS I-5
- 59 DITCH CLEANING DETAIL SHEET
- 60-141 PROJECT LAYOUT SHEETS I-74
- 142-228 TRAFFIC SIGN SUMMARY SHEETS I-87
- 229-241 TRAFFIC SIGN DETAIL SHEETS I-13
- 242-245 TRAFFIC SIGNAL SYSTEMS SHEETS I-4
- 246-247 CONSTRUCTION APPROACH SIGNING SHEETS I-2
- 248-250 RAILROAD STREET ALTERNATIVE LAYOUT SHEETS I-3

**STRUCTURES DETAIL SHEET**

SD-516.10 BRIDGE JOINT ASPHALTIC PLUG

**VAOT STANDARDS**

|        |          |        |          |
|--------|----------|--------|----------|
| B-71   | 07-08-05 | E-145B | 12-23-94 |
| C-2A   | 10-14-05 | E-150  | 05-01-04 |
| C-2B   | 10-14-05 | E-151  | 05-01-04 |
| C-3A   | 03-10-08 | E-163  | 05-20-99 |
| C-3B   | 03-10-08 | E-171A | 08-09-95 |
| C-10   | 02-11-08 | E-171B | 08-09-95 |
| D-3    | 06-01-94 | E-175  | 06-08-09 |
| D-6    | 06-01-94 | E-190  | 06-30-03 |
| D-8    | 01-03-00 | E-191  | 02-01-99 |
| D-9    | 06-01-94 | E-192  | 10-12-00 |
| D-15   | 06-01-94 | E-193  | 08-18-95 |
| D-16   | 06-01-94 | G-1    | 02-10-14 |
| E-121  | 08-08-95 | G-1d   | 02-10-14 |
| E-123  | 03-16-04 | RR-1   | 06-01-94 |
| E-127  | 08-08-95 | T-1    | 08-06-12 |
| E-136B | 08-08-95 | T-10   | 08-06-12 |
| E-140  | 08-30-96 | T-17   | 08-06-12 |
| E-141  | 09-20-95 | T-24   | 08-06-12 |
| E-142  | 09-20-95 | T-28   | 08-06-12 |
| E-143  | 06-15-04 | T-29   | 08-06-12 |
| E-144  | 03-29-99 | T-30   | 08-06-12 |
| E-145A | 12-23-94 | T-31   | 08-06-12 |
|        |          | T-35   | 08-06-12 |
|        |          | T-36   | 08-06-12 |
|        |          | T-44   | 04-09-14 |
|        |          | T-45   | 01-02-13 |

**TRAFFIC DATA**

| LOCATION   | AADT   |        | DHV  |      | ESALS     |           |
|--|--------|--------|------|------|-----------|-----------|
|  | 2014   | 2024   | 2014 | 2024 | 2014-2024 | 2014-2034 |
| <b>ST. JOHNSBURY U.S. ROUTE 2</b>                                |        |        |      |      |           |           |
| BEGIN PROJECT TO BARKER AVENUE (T.H. 360)                        | 5600   | 5700   | 590  | 600  | 1,180,000 | 2,624,000 |
| BARKER AVENUE (T.H. 360) TO NORTH MAIN STREET (ALT U.S. 5)       | 6300   | 6400   | 670  | 680  | 1,704,000 | 3,725,000 |
| NORTH MAIN STREET (ALT U.S. 5) TO RAILROAD STREET (U.S. 5 SOUTH) | 4800   | 4800   | 510  | 510  | 329,000   | 783,000   |
| RAILROAD STREET (U.S. 5 NORTH) TO CONCORD AVENUE                 | 7900   | 8000   | 830  | 840  | 830,000   | 1,930,000 |
| CONCORD AVENUE TO END PROJECT                                    | 6100   | 6200   | 640  | 650  | 1,949,000 | 4,272,000 |
| <b>ST. JOHNSBURY U.S. ROUTE 5</b>                                |        |        |      |      |           |           |
| BEGIN PROJECT TO EASTERN AVENUE (U.S. 2)                         | 4700   | 4700   | 500  | 500  | 834,000   | 1,876,000 |
| EASTERN AVENUE (U.S. 2) TO PORTLAND STREET (U.S. 2)              | 9400   | 9500   | 990  | 1000 | 1,110,000 | 2,600,000 |
| PORTLAND STREET (U.S. 2) TO HASTINGS HILL (ALT U.S. 5)           | 7700   | 7800   | 870  | 880  | 779,000   | 1,805,000 |
| HASTINGS HILL (ALT U.S. 5) TO OLD CENTER ROAD                    | 10,600 | 10,700 | 1200 | 1200 | 1,086,000 | 2,528,000 |
| OLD CENTER ROAD TO END PROJECT                                   | 7500   | 7600   | 850  | 860  | 1,924,000 | 4,089,000 |
| <b>ST. JOHNSBURY ALT U.S. ROUTE 5</b>                            |        |        |      |      |           |           |
| BEGIN PROJECT TO WESTERN AVENUE                                  | 2200   | 2200   | 270  | 270  | 493,000   | 1,069,000 |
| EASTERN AVENUE TO MAPLE STREET                                   | 5100   | 5100   | 580  | 580  | 270,000   | 633,000   |
| MAPLE STREET TO END PROJECT                                      | 4600   | 4600   | 530  | 530  | 707,000   | 1,479,000 |
| <b>LYNDON U.S. ROUTE 5</b>                                       |        |        |      |      |           |           |
| BEGIN PROJECT TO CENTER STREET (ALT VT 122)                      | 13,100 | 13,500 | 1400 | 1400 | 1,908,000 | 4,260,000 |
| CENTER STREET (ALT VT 122) TO MAIN STREET                        | 9500   | 9800   | 1000 | 1000 | 1,803,000 | 4,452,000 |
| MAIN STREET TO END PROJECT                                       | 10,300 | 10,600 | 1100 | 1100 | 1,527,000 | 3,767,000 |
| <b>LYNDON ALT. VT ROUTE 122</b>                                  |        |        |      |      |           |           |
| BEGIN PROJECT TO BACK CENTER ROAD                                | 2,800  | 2,900  | 330  | 340  | 230,000   | 544,000   |
| BACK CENTER ROAD TO COLLEGE ROAD                                 | 3,900  | 4,000  | 450  | 460  | 226,000   | 540,000   |
| COLLEGE ROAD TO END PROJECT                                      | 2,900  | 3,000  | 340  | 350  | 136,000   | 332,000   |

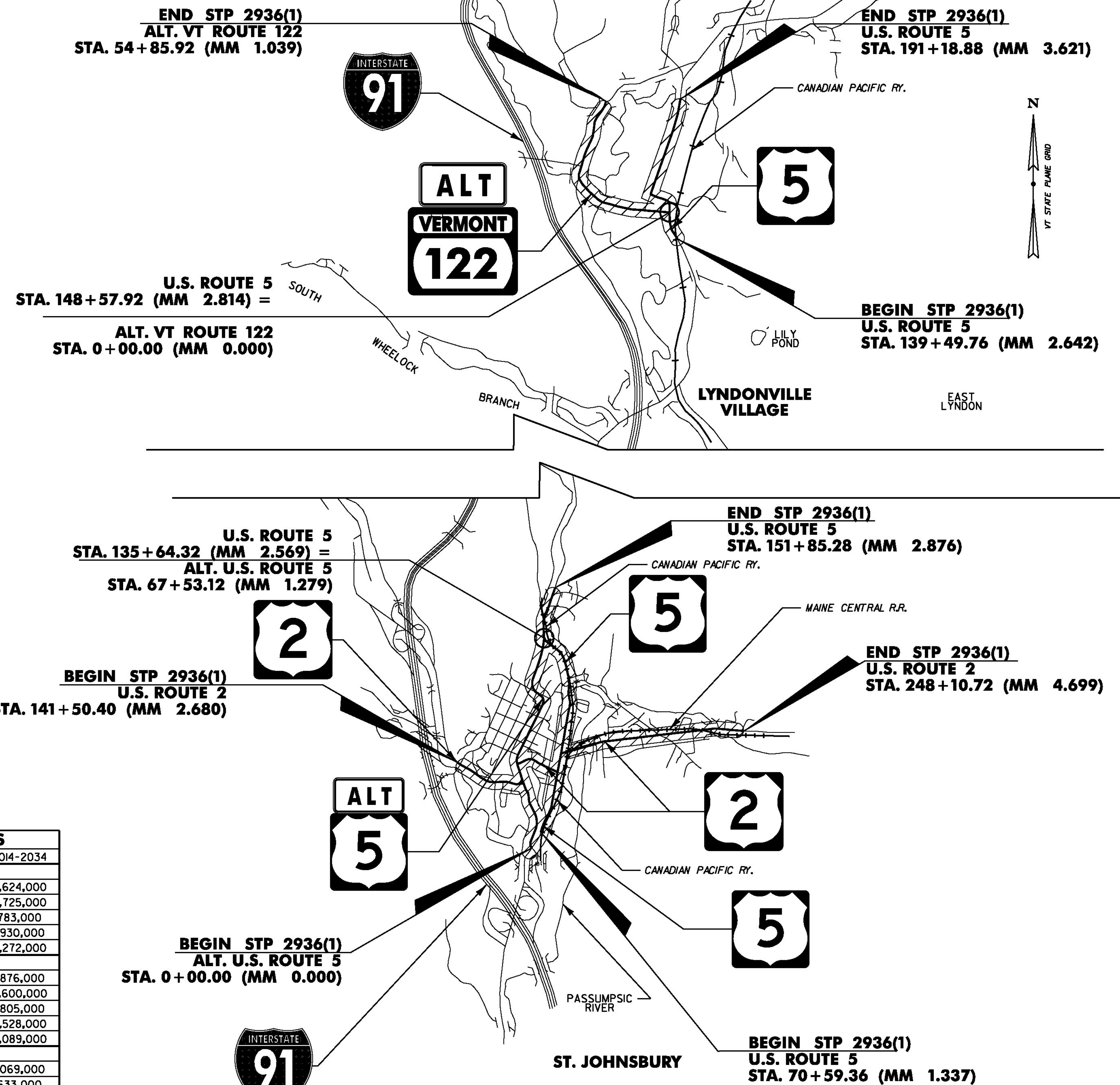

NOT TO SCALE

**INDEX OF SHEETS**

PROJECT NAME: ST JOHNSBURY - LYNDON  
PROJECT NUMBER: STP 2936(1)

FILE NAME: pllc308.dgn  
PROJECT LEADER: G. EDWARDS  
DESIGNED BY: D. DRAPER

PLOT DATE: 7/29/2014  
DRAWN BY: D. DRAPER  
CHECKED BY: J. LITTLE  
SHEET 2 OF 250

