

4 LEVELING PAD DETAIL
Scale: 2" = 1'-0"

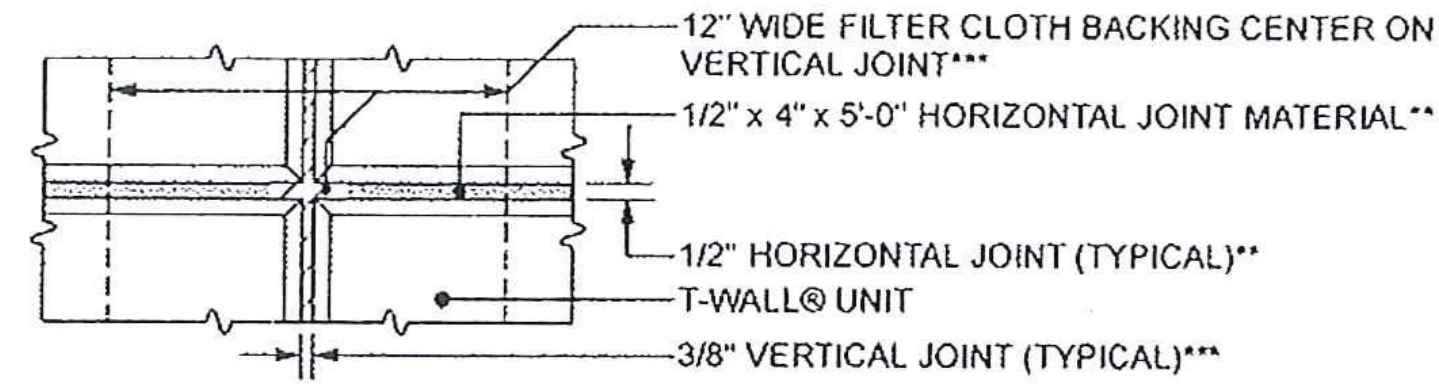

3 HORIZONTAL AND VERTICAL JOINT DETAIL
Scale: 2" = 1'-0"
** SEE GENERAL NOTE 4 ON SHEET 3 FOR ADDITIONAL DETAILS
*** SEE GENERAL NOTE 5 ON SHEET 3 FOR ADDITIONAL DETAILS

NOMENCLATURE NOTE:

THIS SHEET IS PROVIDED FOR GENERAL INFORMATION PURPOSES ONLY, REFERENCING STANDARD DETAILS APPLICABLE TO ANY T-WALL STRUCTURE. THIS SHEET IS NOT INTENDED TO PROVIDE DETAILS SPECIFIC TO THE WALL STRUCTURES CONTAINED IN THIS DRAWING PACKAGE. FOR INFORMATION SPECIFIC TO THESE WALLS, SEE THE APPLICABLE DRAWING SHEETS.

SHEAR KEY NOTES:

1. WALL IS DESIGNED FOR SPECIFIC NUMBER OF SHEAR KEYS AS SHOWN IN "TYPICAL SECTION AT MAXIMUM HEIGHT" FOR SPECIFIC WALLS. LOCATION OF SHEAR KEYS CAN BE ADJUSTED IF NECESSARY AT A SPECIFIC LEVEL.
2. ALL EXTENDED FACE TOP UNITS REQUIRE A MINIMUM OF 2 SHEAR KEYS, OR 1 SHEAR KEY FOR EVERY 6' OF STEM LENGTH (OR FRACTION THEREOF), WHICHEVER IS GREATER.
3. ALL OTHER UNITS REQUIRE 1 SHEAR KEY FOR EVERY 6' OF STEM LENGTH AS SHOWN IN TABLE BELOW.

SHOP DRAWING REVIEW

REVIEWED AS REQUIRED BY THE CONSTRUCTION CONTRACT DOCUMENTS AND APPROVED, BUT ONLY FOR CONFORMANCE TO THE DESIGN CONCEPT OF THE WORK, AND SUBJECT TO FURTHER LIMITATIONS AND REQUIREMENTS CONTAINED IN THE CONSTRUCTION CONTRACT DOCUMENTS.
 REJECTED REVISE AND RESUBMIT FURNISH AS CORRECTED

CORRECTIONS OR COMMENTS MADE ON THE SHOP DRAWINGS DURING THIS REVIEW DO NOT RELIEVE CONTRACTOR FROM COMPLIANCE WITH REQUIREMENTS OF THE DRAWINGS AND SPECIFICATIONS. THIS CHECK IS ONLY FOR REVIEW OF GENERAL CONFORMANCE WITH THE DESIGN CONCEPT OF THE PROJECT AND GENERAL COMPLIANCE WITH THE INFORMATION GIVEN IN THE CONTRACT DOCUMENTS. THE CONTRACTOR IS RESPONSIBLE FOR; CONFIRMING AND CORRELATING ALL QUANTITIES AND DIMENSIONS; SELECTING FABRICATION PROCESSES AND TECHNIQUES OF CONSTRUCTION; COORDINATING HIS WORK WITH THAT OF ALL OTHER TRADES; AND PERFORMING HIS WORK IN A SAFE AND SATISFACTORY MANNER.

VHB Vanasse Hangen Brustlin, Inc.
 7056 US Route 7
 North Ferrisburgh, VT 05473
 802.425.7788

HUBBARDTON
 Job Number: **ER STD 0161(27)**
 Reviewed By: **S. FARNSWORTH**
 Date: **9-29-2012**

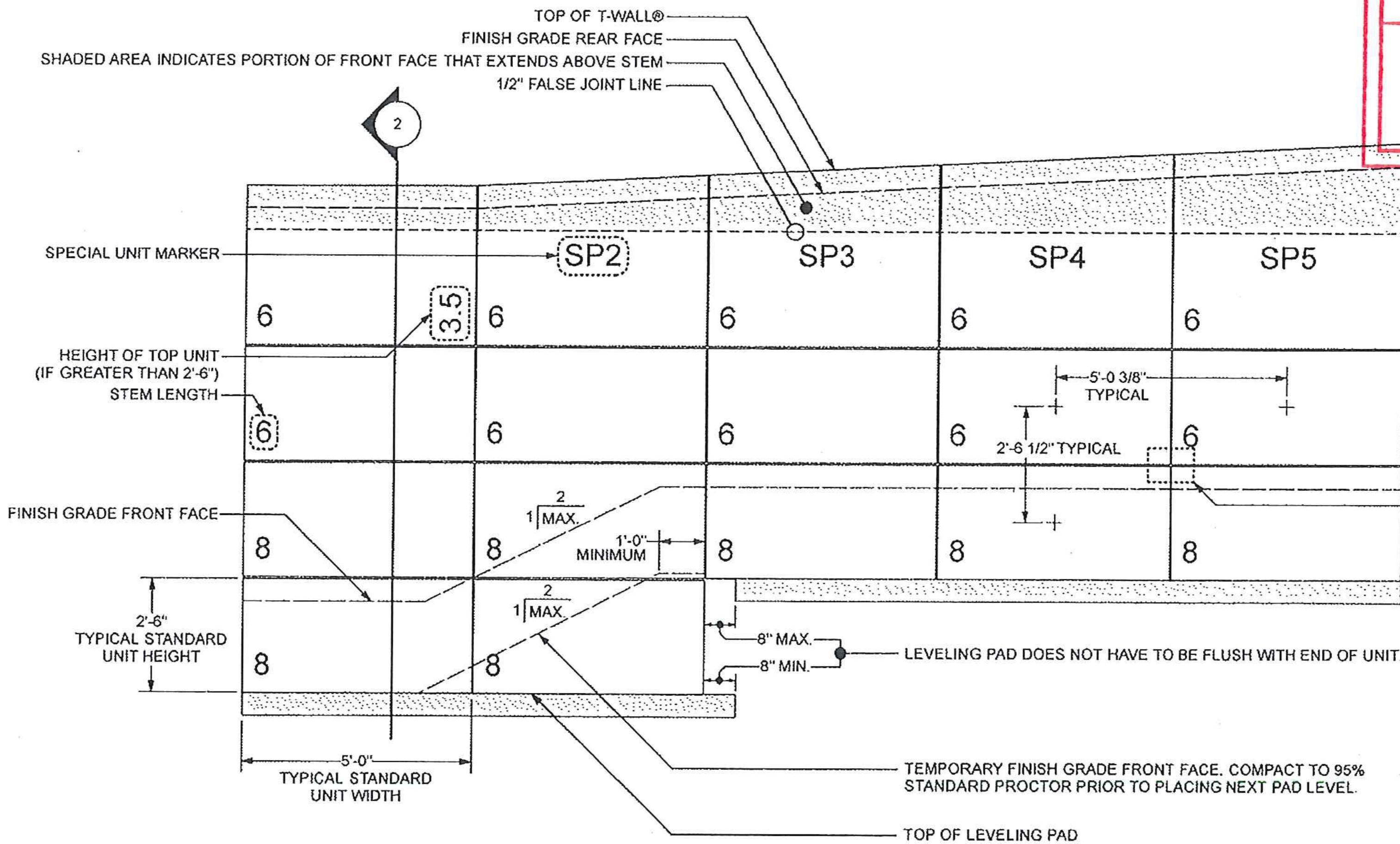

1 PARTIAL ELEVATION SHOWN - TYPICAL DETAILS
Scale: 1/2" = 1'-0"

NOT ALL DETAILS APPLY. SEE SPECIFIC WALL ELEVATIONS

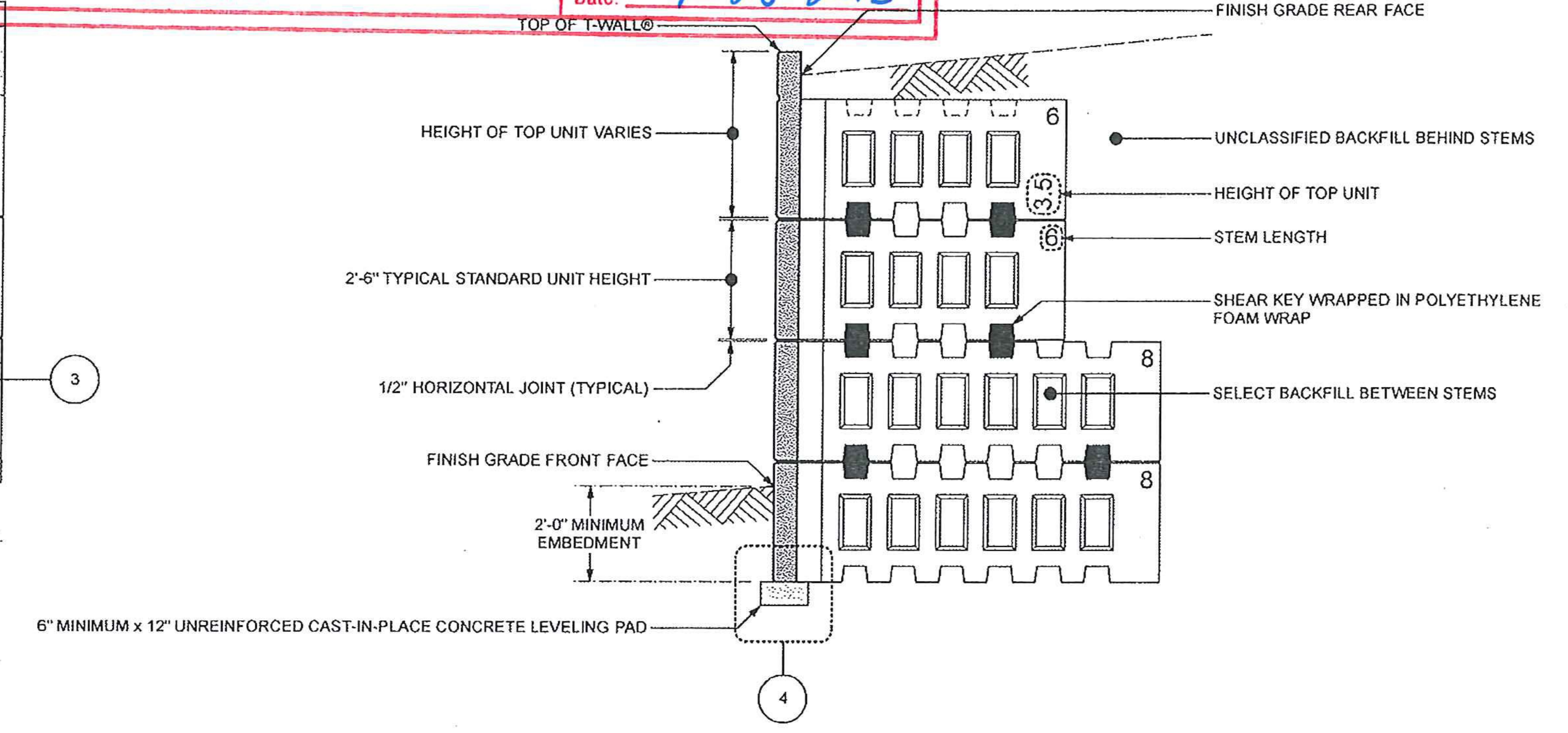

2 PARTIAL ELEVATION SHOWN - TYPICAL DETAILS
Scale: 1/2" = 1'-0"

NOT ALL DETAILS APPLY. SEE SPECIFIC WALL ELEVATIONS



The design contained on these drawings is based upon information provided by the owner. On the basis of this information, The Neel Company has designed, and is responsible for, the internal stability of the structure only. External stability, including foundation and slope stability, is the responsibility of the owner.

This drawing contains information proprietary to The Neel Company. T-WALL® is a registered trademark owned by The Neel Company. ©2012 The Neel Company

PRECASTER: CONCRETE SYSTEMS INC.
 HUDSON, NH
 PROJECT #: T21377

CONTRACTOR: J. A. MCDONALD INC.
 LYNDON CENTER, VERMONT
 PROJECT #:

DESIGNER
THE NEEL COMPANY
 8328-D TRAFORD LANE
 SPRINGFIELD, VIRGINIA 22152
 PH: (703) 913-7858
 FX: (703) 913-7859
 WEB: WWW.NEELCO.COM

PROJECT #: TW4083

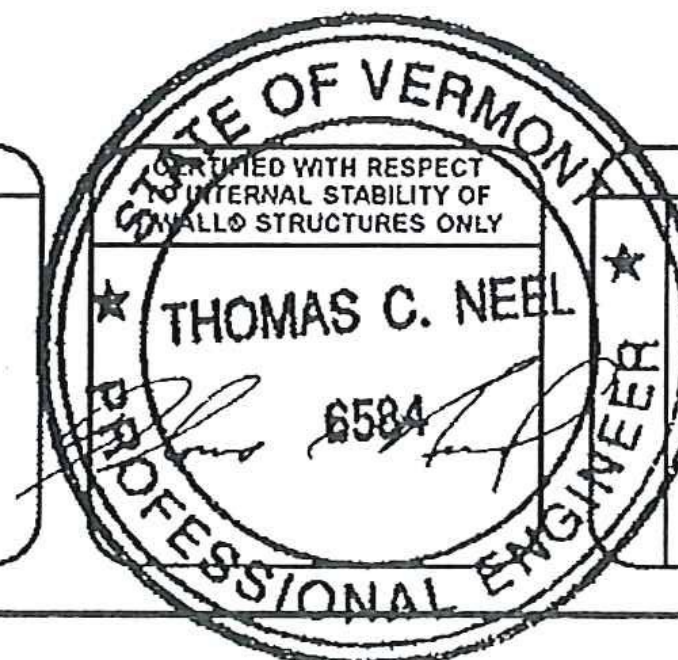

REVISIONS

**RTE. 30 BRIDGE IMPROVEMENTS
 BRIDGE NO. 98**
 TOWN OF HUBBARDTON, VT
 ER STP 0161 (27)
 SHOP DRAWINGS
 T-WALL® NOMENCLATURE AND TYPICAL SYSTEM DETAILS
 T-WALL® RETAINING WALL SYSTEM

SCALE: AS NOTED
 DATE: 9-25-2012
 DESIGNED BY: NN
 DRAWN BY: HS
 CHECKED BY: NN
 SHEET: 2