

SOIL CLASSIFICATION

MACOMBER-TACONIC COMPLEX (42C)
 "K FACTOR" = 0.37
 CLASSIFIED HIGH EROSION POTENTIAL

GEORGIA AND AMENIA SOILS (66B)
 "K FACTOR" = 0.32
 CLASSIFIED MODERATE EROSION POTENTIAL

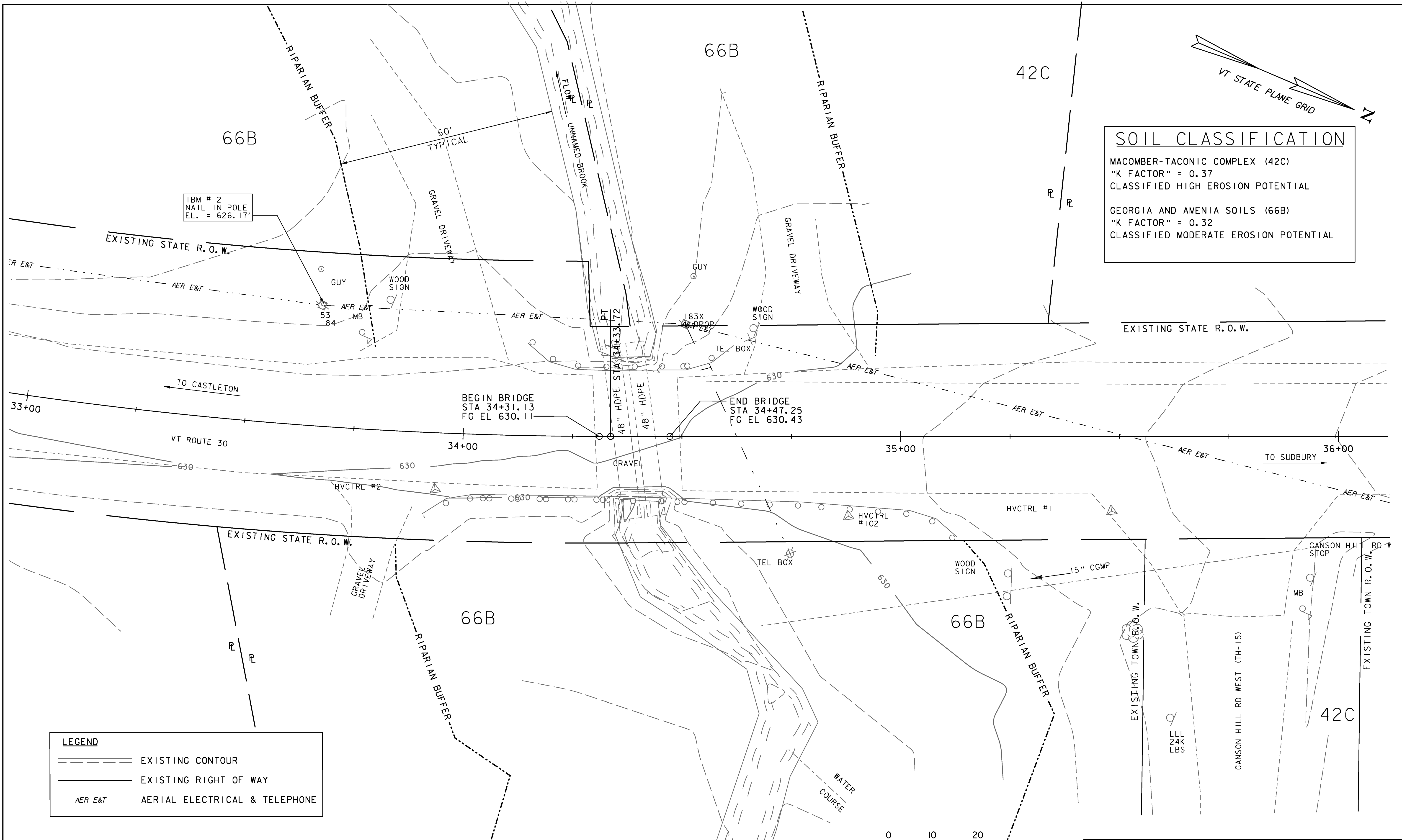

LEGEND

--- EXISTING CONTOUR

— EXISTING RIGHT OF WAY

— AER E&T — AERIAL ELECTRICAL & TELEPHONE

NOTE:

EXISTING SURVEY FEATURES AND EXISTING CONTOURS ARE BASED ON SURVEY CONDUCTED IN DECEMBER 2011. THE ORIGINAL 1957 4" x 8" CULVERT HAS SINCE BEEN REPLACED WITH TWO (2) 48" DIAMETER HDPE CULVERTS AND THE SLOPES REGRADED.

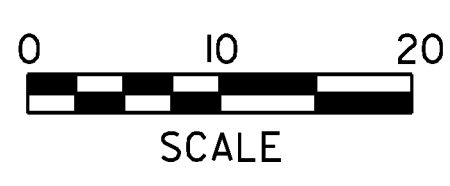

VHB Vanasse Hangen Brustlin, Inc.

PROJECT NAME: HUBBARDTON
 PROJECT NUMBER: ER STP 016(27)

FILE NAME: zllc290ero.dgn
 PROJECT LEADER: M.A. COLGAN
 DESIGNED BY: S.G. FARNSWORTH
 EPSC EXISTING CONDITIONS SITE PLAN

PLOT DATE: 7/16/2012
 DRAWN BY: C.L. CILLEY
 CHECKED BY: S.G. FARNSWORTH
 SHEET 52 OF 70