

REMOVED 6' 3" THRIE BEAM TO HD STEEL BEAM TRANSITION AND REPLACED IT WITH A 12' 6" HD-STEEL BEAM, R=16', PANEL

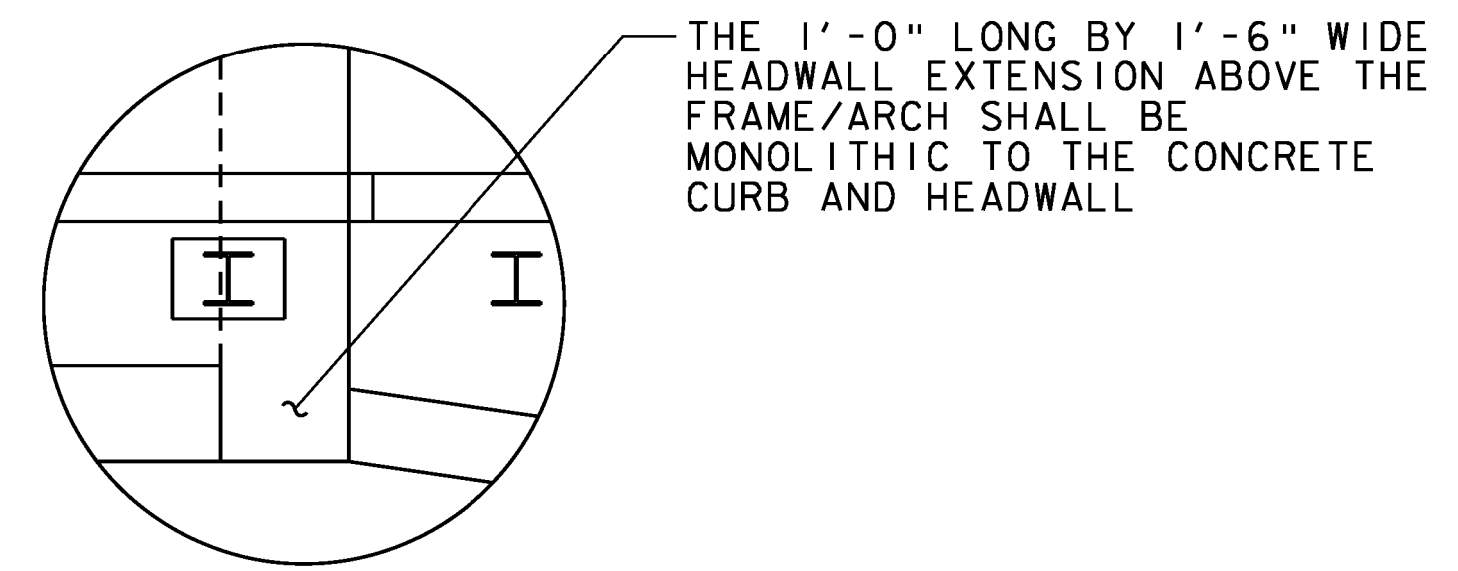

THE 1'-0" LONG BY 1'-6" WIDE HEADWALL EXTENSION ABOVE THE FRAME/ARCH SHALL BE MONOLITHIC TO THE CONCRETE CURB AND HEADWALL

BRIDGE AND APPROACH RAIL LAYOUT
SCALE 1/4" = 1'-0"



PROJECT NAME: HUBBARDTON	PLOT DATE: 7/16/2012
PROJECT NUMBER: ER STP 0161(26)	DRAWN BY: E.A. FIALA
FILE NAME: zllc288brall.dgn	CHECKED BY: S.G. FARNSWORTH
PROJECT LEADER: M.A. COLGAN	SHEET 31 OF 70
DESIGNED BY: S.G. FARNSWORTH	
BRIDGE AND APPROACH RAILING	