

STA. 33+11, LT. TO STA. 34+48.5, LT.  
 STA. 34+41, RT. TO STA. 34+53.5, RT.  
 STA. 35+48.5, LT. TO STA. 36+48.5, LT.  
 STA. 35+53.5, RT. TO STA. 36+66, RT.

STA. 34+48.5, LT. TO STA. 34+86, LT.  
 STA. 34+53.5, RT. TO STA. 34+91, RT.  
 STA. 35+11, LT. TO STA. 35+48.5, LT.  
 STA. 35+16, RT. TO STA. 35+53.5, RT.

621.20 - STEEL BEAM GUARDRAIL, GALVANIZED  
 STA. 33+11.03, LT. TO STA. 34+50.00, LT.  
 STA. 34+41.44, RT. TO STA. 34+50.00, RT.  
 STA. 35+50.00, LT. TO STA. 36+49.20, LT.  
 STA. 35+50.00, RT. TO STA. 36+61.45, RT.

646.400- DURABLE 4 INCH WHITE LINE  
 STA. 33+55.00, RT. TO STA. 36+47.00, RT.  
 STA. 33+55.00, LT. TO STA. 36+47.00, LT.  
 646.410- DURABLE 4 INCH YELLOW LINE  
 STA. 33+55.00, CL. TO STA. 36+47.00, CL. (DYEL)

675.50 - REMOVING SIGNS  
 STA. 33+22, LT.  
 STA. 35+70, LT.  
 675.60 - ERECTING SALVAGED SIGNS  
 STA. 33+22, LT.  
 STA. 35+70, LT.

621.21 - HD STEEL BEAM GUARDRAIL, GALVANIZED  
 STA. 34+50.0, LT. TO STA. 34+87.5, LT.  
 STA. 34+50.0, RT. TO STA. 34+87.5, RT.  
 STA. 35+12.5, LT. TO STA. 35+50.0, LT.  
 STA. 35+12.5, RT. TO STA. 35+50.0, RT.

CURVE DATA  
 DELTA = 14°50'31.6"  
 D = 5°12'31.4"  
 R = 1100.00'  
 T = 143.28'  
 L = 284.95'  
 E = 9.29'

621.216 - HD STEEL BEAM GUARDRAIL, GALVANIZED/NESTED  
 STA. 34+87.5, LT. TO STA. 35+12.5, LT.  
 STA. 34+87.5, RT. TO STA. 35+12.5, RT.

621.60 - ANCHOR FOR STEEL BEAM RAIL  
 STA. 33+11.03, LT. STA. 33+11, LT.  
 STA. 34+41.44, RT. STA. 34+41, RT.  
 STA. 36+49.20, LT. STA. 36+48.5, LT.  
 STA. 36+61.45, RT. STA. 36+66, RT.

621.80 - REMOVAL AND DISPOSAL OF GUARDRAIL  
 STA. 33+12.71, LT. TO STA. 36+05.57, LT.  
 STA. 34+48.75, RT. TO STA. 35+86.30, RT.

675.20 - TRAFFIC SIGNS, TYPE A  
 675.341 SQUARE TUBE SIGN POST AND ANCHOR  
 STA. 34+81, RT.  
 STA. 35+18, LT.

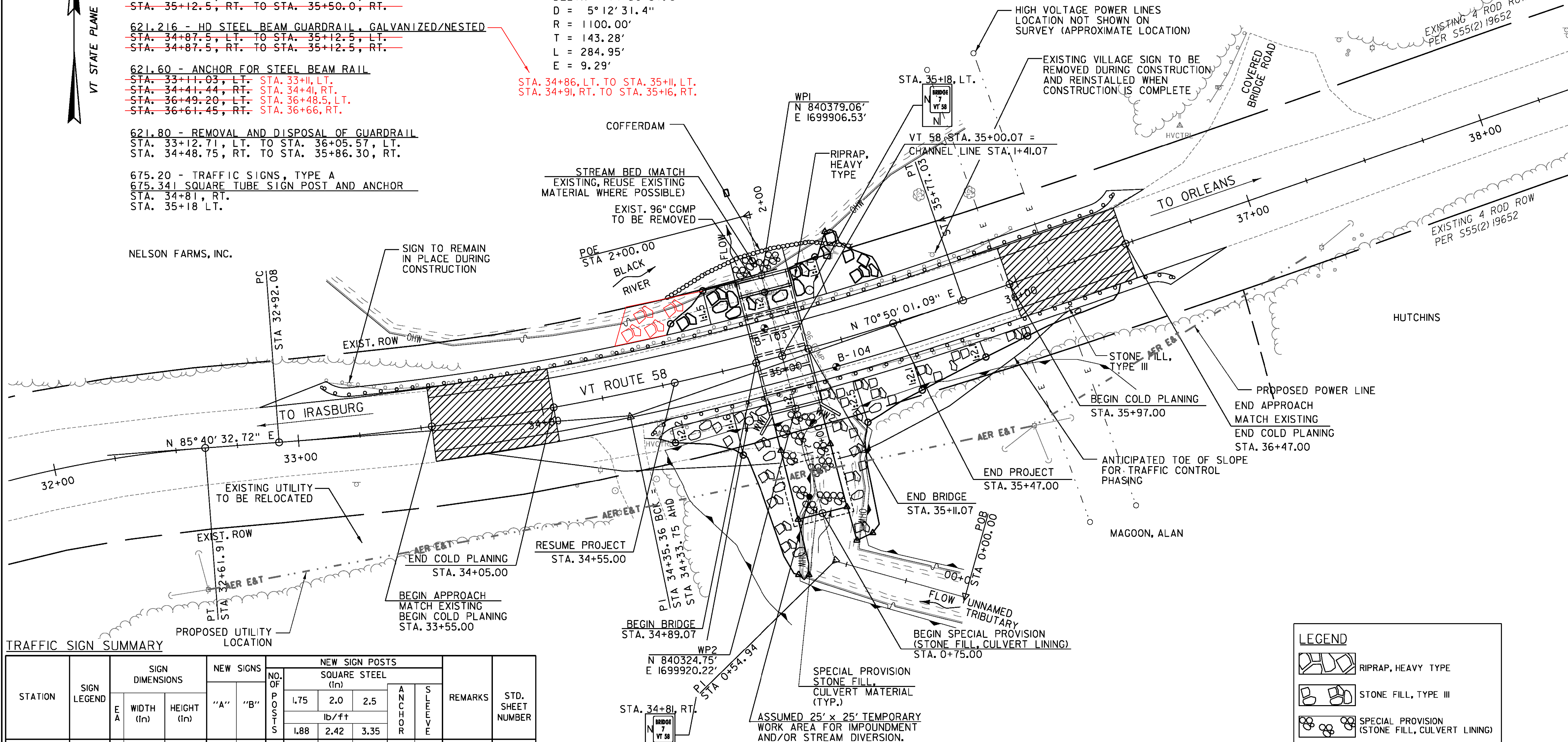
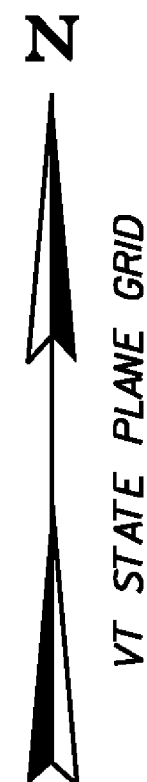

TRAFFIC SIGN SUMMARY

STATION	SIGN LEGEND	SIGN DIMENSIONS		NEW SIGNS		NO. OF POSTS	NEW SIGN POSTS SQUARE STEEL (in)			REMARKS	STD. SHEET NUMBER		
		E	A	WIDTH (in)	HEIGHT (in)		"A"	"B"	1.75			2.0	2.5
									lb/ft			lb/ft	lb/ft
33+81, RT	BRIDGE 7 VT 58			6	8	0.33				X		VR-701	T-42
35+18, LT	BRIDGE 7 VT 58			6	8	0.33				X		VR-701	T-42
<b>TOTALS</b>				SF	SF				FT				
				0.66					30				

FINAL POST LENGTHS ARE TO BE DETERMINED IN THE FIELD. POST SIZES ARE COMPUTED BASED ON INFORMATION FURNISHED ON THE STANDARD SHEETS AND THE VTRANS "SIGN POST DESIGN GUIDELINE."

LEGEND	
	RIPRAP, HEAVY TYPE
	STONE FILL, TYPE III
	SPECIAL PROVISION (STONE FILL, CULVERT LINING)

NOTES:  
 1. GRADE IN ACCORDANCE WITH TYPICAL ROADWAY SECTION AND ROADWAY CROSS SECTIONS UNLESS NOTED OTHERWISE.

PROJECT NAME:	IRASBURG	FILE NAME:	zllc266bdr_br7.dgn	PLOT DATE:	10/21/2014
PROJECT NUMBER:	STP CULV(30)	PROJECT LEADER:	M. CHENETTE	DRAWN BY:	L. BUXTON
		DESIGNED BY:	J. HUNGERFORD	CHECKED BY:	M. CHENETTE
		PLAN LAYOUT SHEET - BR7		SHEET	35 OF 55

