

PROFILE ALONG VT ROUTE 58

HORIZONTAL SCALE: 1' = 20' VERTICAL SCALE: 1" = 10'

NOTE:
 ELEVATIONS SHOWN TO THE NEAREST TENTH ARE EXISTING GROUND ALONG PROPOSED CENTERLINE.
 ELEVATIONS SHOW TO THE NEAREST HUNDRETH ARE FINISHED GRADE ALONG PROPOSED CENTERLINE.

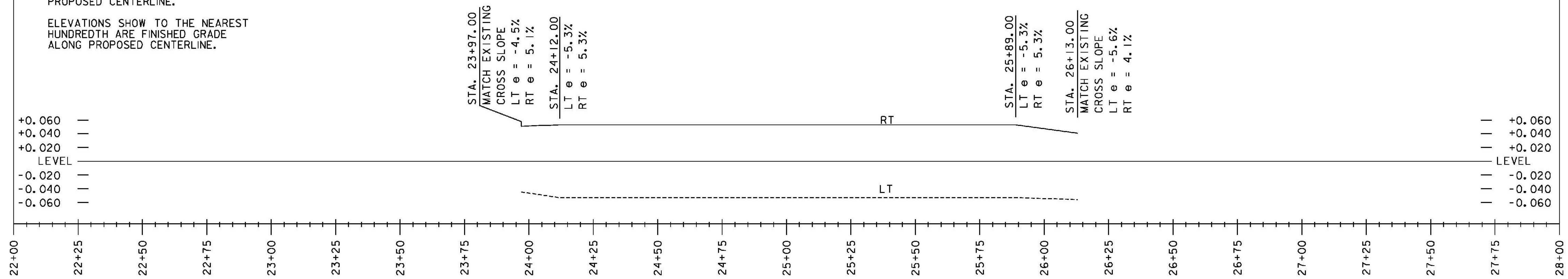

BANKING DIAGRAM

HORIZONTAL SCALE: 1' = 20' VERTICAL SCALE: N. T. S.

NOTE:
 STATIONING IN FEET AND SUPERELEVATIONS IN PERCENTAGES

PROJECT NAME: IRASBURG	PLOT DATE: 9/26/2014
PROJECT NUMBER: STP CULV(30)	DRAWN BY: L. BUXTON
FILE NAME: zllc266pro.dgn	CHECKED BY: M. CHENETTE
PROJECT LEADER: M. CHENETTE	SHEET 15 OF 55
DESIGNED BY: J. HUNGERFORD	
ROADWAY PROFILE - BR6	

