

678.15 - TRAFFIC CONTROL SIGNAL SYSTEM, INTERSECTION
SEE SIGNAL PLAN 2

- MAST ARM POLES**
 STA. 72+45 LT. (55' LT.)
 STA. 30+75 RT. (40' RT.)
 STA. 29+15 LT. (40' LT.)
 STA. 73+30 RT. (55' RT.)
 STA. 73+42 RT. (55' RT.)
CONTROLLER / CABINET
 STA. 30+50 LT. (55' LT.)
- POWER STANCHION**
 STA. 30+75.00 LT. (40.00' LT.)

- 678.25 - PULL BOX, STANDARD**
 STA. 30+60 LT. (45' LT.) STA. 30+47 (55' LT.) PB1
 STA. 30+85 RT. (40' RT.) STA. 30+86 (41' RT.) PB2
 STA. 72+55 LT. (55' LT.) STA. 72+55 (60' LT.) PB3
 STA. 72+00 RT. (55' RT.) STA. 72+00 (62' RT.) PB4
 STA. 29+50 RT. (45' RT.) STA. 73+14 (55' RT.) PB5

- 900.640 - SPECIAL PROVISION (HORIZONTAL DIRECTION DRILLING) (10" CASING PIPE)**
 (S) STA. 30+62 LT. - STA. 30+84 RT. (74')
 (S) STA. 72+03 RT. - STA. 72+53 LT. (112')
 (S) STA. 29+12 LT. - STA. 29+47 RT. (80')

- 679.47 - BRACKET ARM**
 STA. 72+45 LT. (55' LT.)
 STA. 30+75 RT. (40' RT.)
 STA. 29+15 LT. (40' LT.)
 STA. 73+30 RT. (55' RT.)

- 900.620 - SPECIAL PROVISION (LUMINAIRE, LED)**
 STA. 72+45 LT. (55' LT.)
 STA. 30+75 RT. (40' RT.)
 STA. 29+15 LT. (40' LT.)
 STA. 73+30 RT. (55' RT.)

- 900.620 - SPECIAL PROVISION (REMOVE EXISTING LIGHT POLE)**
 STA. 71+54 LT. (46' LT.)
 STA. 74+26 RT. (46' RT.)
 STA. 74+31 LT. (85' LT.)
 STA. 29+42 RT. (57' RT.)

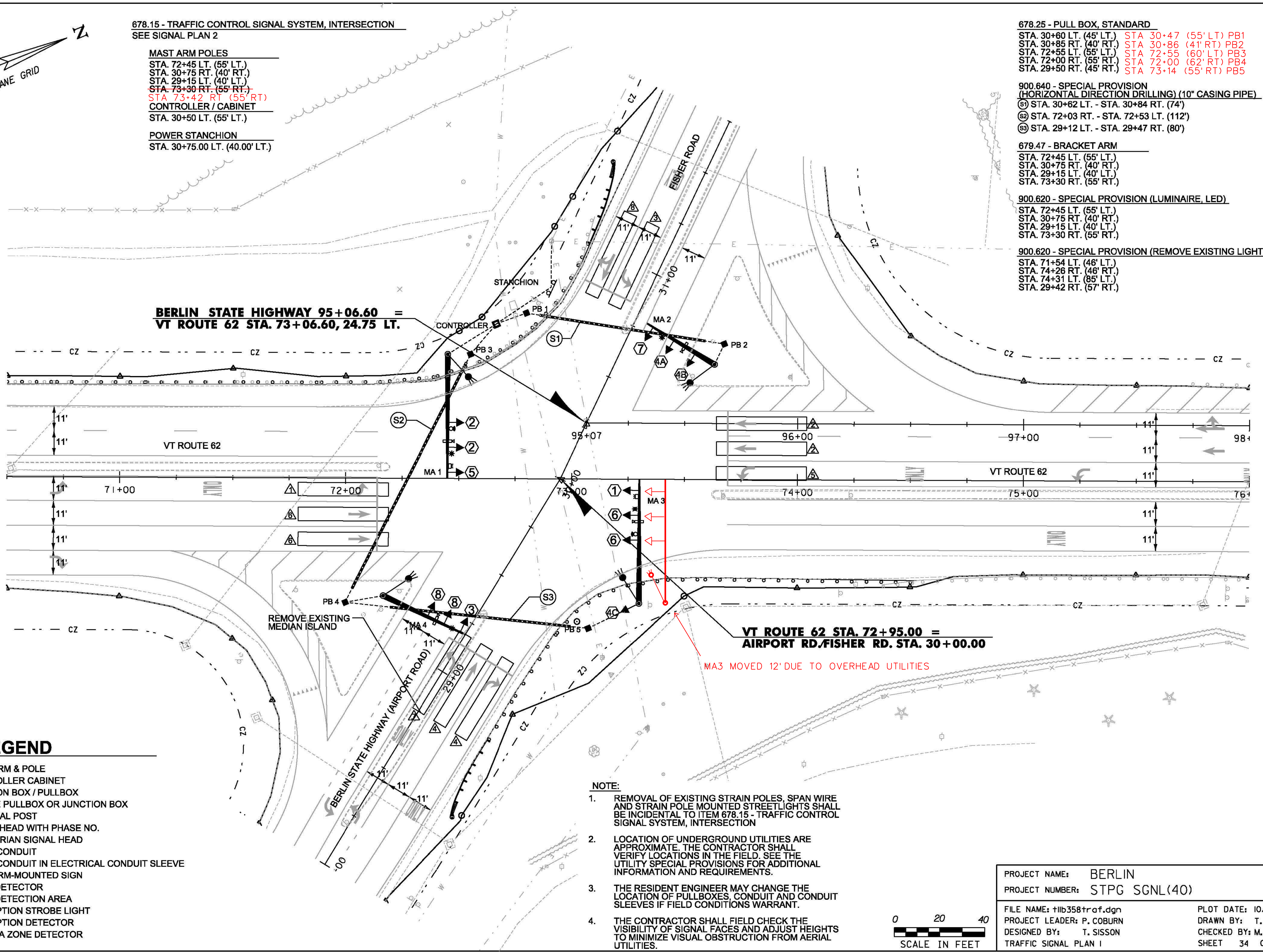

LEGEND

- MAST ARM & POLE
- CC CONTROLLER CABINET
- DPB JUNCTION BOX / PULLBOX
- DPB DOUBLE PULLBOX OR JUNCTION BOX
- PP PEDESTAL POST
- SIGNAL HEAD WITH PHASE NO.
- PEDESTRIAN SIGNAL HEAD
- WIRED CONDUIT
- WIRED CONDUIT IN ELECTRICAL CONDUIT SLEEVE
- MAST ARM-MOUNTED SIGN
- VIDEO DETECTOR
- VIDEO DETECTION AREA
- * PREEMPTION STROBE LIGHT
- PREEMPTION DETECTOR
- DILEMMA ZONE DETECTOR

- NOTE:**
1. REMOVAL OF EXISTING STRAIN POLES, SPAN WIRE AND STRAIN POLE MOUNTED STREETLIGHTS SHALL BE INCIDENTAL TO ITEM 678.15 - TRAFFIC CONTROL SIGNAL SYSTEM, INTERSECTION
 2. LOCATION OF UNDERGROUND UTILITIES ARE APPROXIMATE. THE CONTRACTOR SHALL VERIFY LOCATIONS IN THE FIELD. SEE THE UTILITY SPECIAL PROVISIONS FOR ADDITIONAL INFORMATION AND REQUIREMENTS.
 3. THE RESIDENT ENGINEER MAY CHANGE THE LOCATION OF PULLBOXES, CONDUIT AND CONDUIT SLEEVES IF FIELD CONDITIONS WARRANT.
 4. THE CONTRACTOR SHALL FIELD CHECK THE VISIBILITY OF SIGNAL FACES AND ADJUST HEIGHTS TO MINIMIZE VISUAL OBSTRUCTION FROM AERIAL UTILITIES.

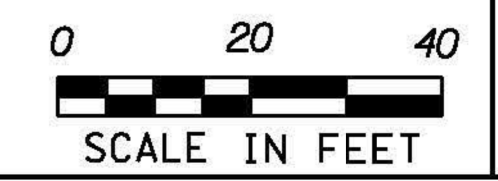

PROJECT NAME:	BERLIN	PLOT DATE:	10/20/2014
PROJECT NUMBER:	STPG SGNL(40)	DRAWN BY:	T. SISSON
FILE NAME:	t11b358traf.dgn	CHECKED BY:	M. LACROIX
DESIGNED BY:	T. SISSON	SHEET	34 OF 123
TRAFFIC SIGNAL PLAN 1			