

VT ROUTE 62			
Element: Curve #2	PC	79+79.79	626974.7874 1624965.3744
	PI	88+20.58	627753.0646 1625313.5193
	CC		626685.7223 1625702.5135
	PT	92+52.90	627294.9416 1625241.5838
	Radius:	763.94	
	Delta:	95°29'01.37"	Right
	Degree of Curvature(Arc):	7°30'00.13"	
	Length:	1273.11	
	Tangent:	840.79	
	Chord:	1130.82	
	Middle Ordinate:	250.21	
	External:	372.08	
	Tangent Direction:	N 22°14'01.72" E	
	Radial Direction:	S 67°45'58.28" E	
	Chord Direction:	N 69°58'32.41" E	
	Radial Direction:	S 27°43'03.09" W	
	Tangent Direction:	S 62°16'56.91" E	

BERLIN STATE HIGHWAY			
Element: Curve #1	PC	101+79.79	626984.1525 1624972.4646
	PI	102+85.37	627081.8800 1625012.4138
	CC		626685.7223 1625702.5135
	PT	103+89.70	627165.6594 1625076.6603
	Radius:	788.69	
	Delta:	15°14'56.66"	Right
	Degree of Curvature(Arc):	7°15'52.84"	
	Length:	209.91	
	Tangent:	105.58	
	Chord:	209.29	
	Middle Ordinate:	6.97	
	External:	7.04	
	Tangent Direction:	N 22°14'01.72" E	
	Radial Direction:	S 67°45'58.28" E	
	Chord Direction:	N 29°51'30.05" E	
	Radial Direction:	S 52°31'01.62" E	
	Tangent Direction:	N 37°28'58.38" E	

BERLIN STATE HIGHWAY			
Element: Curve #3	PC	105+59.85	627324.1429 1625129.3944
	PI	106+19.27	627383.5518 1625128.6955
	CC		627328.5718 1625505.8683
	PT	106+77.71	627440.2889 1625146.3248
	Radius:	376.50	
	Delta:	17°56'06.10"	Right
	Degree of Curvature(Arc):	15°13'04.81"	
	Length:	117.85	
	Tangent:	59.41	
	Chord:	117.37	
	Middle Ordinate:	4.60	
	External:	4.68	
	Tangent Direction:	N 00°40'26.40" W	
	Radial Direction:	N 89°19'33.60" E	
	Chord Direction:	N 08°17'36.65" E	
	Radial Direction:	N 72°44'20.30" E	
	Tangent Direction:	N 17°15'39.70" E	

BERLIN STATE HIGHWAY			
Element: Curve #2	PC	103+89.70	627165.6594 1625076.6603
	PI	104+78.07	627235.7819 1625190.4339
	CC		627321.1374 1624873.9120
	PT	105+59.85	627324.1429 1625129.3944
	Radius:	255.5	
	Delta:	38°09'24.78"	Left
	Degree of Curvature(Arc):	22°25'29.67"	
	Length:	170.15	
	Tangent:	88.37	
	Chord:	167.03	
	Middle Ordinate:	14.03	
	External:	14.85	
	Tangent Direction:	N 37°28'58.38" E	
	Radial Direction:	S 52°31'01.62" E	
	Chord Direction:	N 18°24'15.99" E	
	Radial Direction:	N 89°19'33.60" E	
	Tangent Direction:	N 00°40'26.40" E	

BERLIN STATE HIGHWAY			
Element: Curve #4	PC	106+77.71	627440.2889 1625146.3248
	PI	108+23.18	627579.2086 1625189.4898
	CC		628195.455 1622715.9443
	PT	109+88.33	627722.142 1625216.5442
	Radius:	2545	
	Delta:	06°32'34.42"	Left
	Degree of Curvature(Arc):	02°15'04.71"	
	Length:	290.63	
	Tangent:	145.47	
	Chord:	290.47	
	Middle Ordinate:	4.15	
	External:	4.15	
	Tangent Direction:	N 17°15'39.70" E	
	Radial Direction:	S 72°44'20.30" E	
	Chord Direction:	N 13°59'22.49" E	
	Radial Direction:	S 79°16'54.72" E	
	Tangent Direction:	N 10°43'05.28" E	

**LIMITS OF CONSTRUCTION  
STA. 109+68.33**

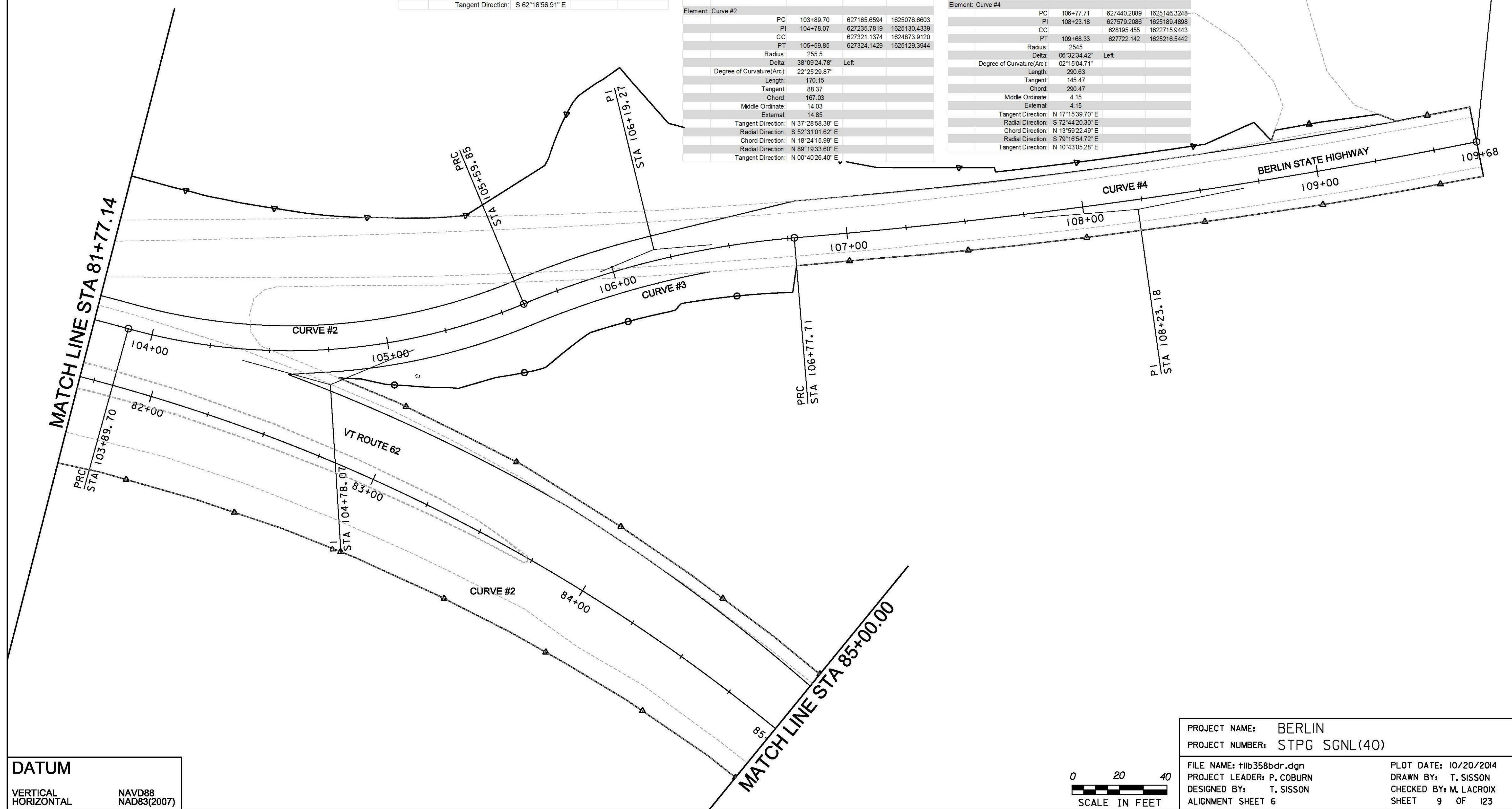

**DATUM**  
VERTICAL NAVD88  
HORIZONTAL NAD83(2007)

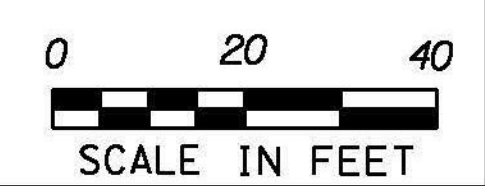

PROJECT NAME: BERLIN  
PROJECT NUMBER: STPG SGNL(40)  
FILE NAME: +lib358bdr.dgn PLOT DATE: 10/20/2014  
PROJECT LEADER: P. COBURN DRAWN BY: T. SISSON  
DESIGNED BY: T. SISSON CHECKED BY: M. LACROIX  
ALIGNMENT SHEET 6 SHEET 9 OF 123