

VT ROUTE 62

Element: Linear	POB	65+92.66	625698.2971	1624453.8098
	PC	66+98.88	625792.9349	1624502.0513
	Tangent Direction:	N 27°00'36.51" E		
	Tangent Length:	106.22		
Element: Curve #1	PC	66+98.88	625792.9349	1624502.0513
	PI	66+12.32	625894.0007	1624553.5694
	CC	627028.2180	1622078.7321	
	PT	69+25.63	625999.0052	1624596.4932
	Radius:	2720		
	Delta:	4°46'34.79" Left		
	Degree of Curvature(Arc):	2°06'23.26"		
	Length:	226.75		
	Tangent:	113.44		
	Chord:	226.68		
	Middle Ordinate:	2.36		
	External:	2.36		
	Tangent Direction:	N 27°00'36.51" E		
	Radial Direction:	S 62°59'23.49" E		
	Chord Direction:	N 24°37'19.11" E		
	Radial Direction:	S 67°45'58.28" E		
	Tangent Direction:	N 22°14'01.72" E		
Element: Linear	PT	69+25.63	625999.0052	1624596.4932
	PC	79+79.79	626974.7874	1624995.3744
	Tangent Direction:	N 22°14'01.72" E		
	Tangent Length:	1054.16		

**BEGIN PROJECT
BERLIN STPG SGNL (40)
STA. 65+92.66**

VT ROUTE 62
TO BERLIN CORNERS

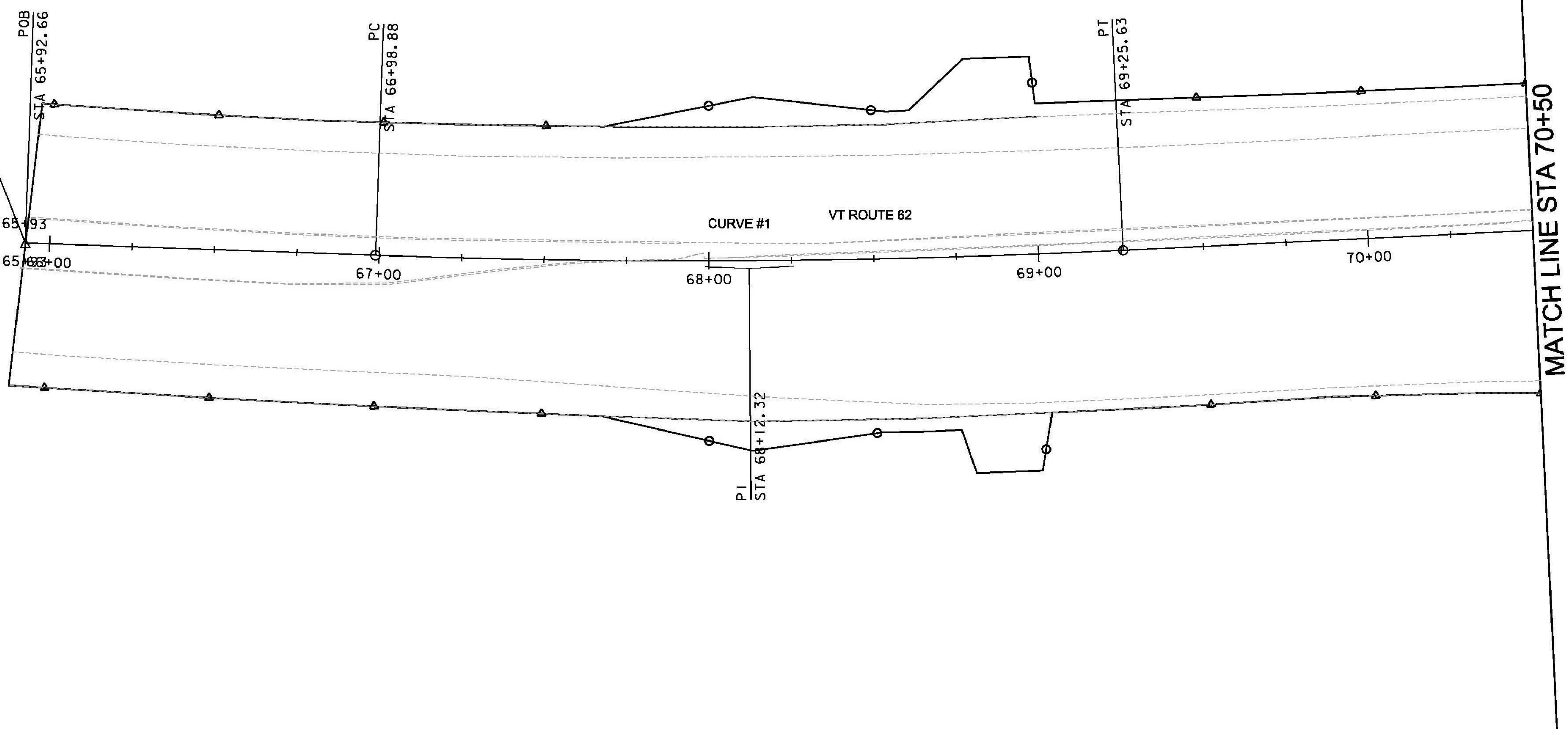

DATUM
VERTICAL: NAVD88
HORIZONTAL: NAD83(2007)



PROJECT NAME:	BERLIN	PLOT DATE:	10/20/2014
PROJECT NUMBER:	STPG SGNL(40)	DRAWN BY:	T. SISSON
FILE NAME:	+lib358bdr.dgn	CHECKED BY:	M. LACROIX
PROJECT LEADER:	P. COBURN	ALIGNMENT SHEET I	SHEET 4 OF 123
DESIGNED BY:	T. SISSON		