

# STATE OF VERMONT AGENCY OF TRANSPORTATION

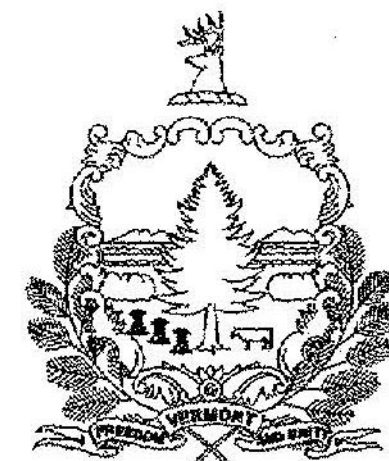

## PROPOSED IMPROVEMENT TOWN OF BERLIN COUNTY OF WASHINGTON VT ROUTE 62 - (PRINCIPAL ARTERIAL)

RECORD PLANS	
CONTRACTOR:	ENGINEERS CONSTRUCTION, INC. - S. BURLINGTON, VT
RESIDENT ENGINEER:	SANDY SCHMITT
CONSTRUCTION BEGAN:	MAY 11, 2015
CONSTRUCTION COMPLETE:	OCTOBER 9, 2015
RECORD PLANS BY:	SANDY SCHMITT & CHIP PIERCE
I HEREBY CERTIFY THAT ALL THE CONSTRUCTION REQUIRED BY THIS SET OF DRAWINGS HAS BEEN ACCOMPLISHED AS INDICATED HEREIN.	
BY:	<i>Sandy Schmitt</i> RESIDENT ENGINEER
DATE:	03-13-17
NOTE: Any further information concerning final quantities, amounts or other details relative to this project may be found at Central Files in the electronic archives.	

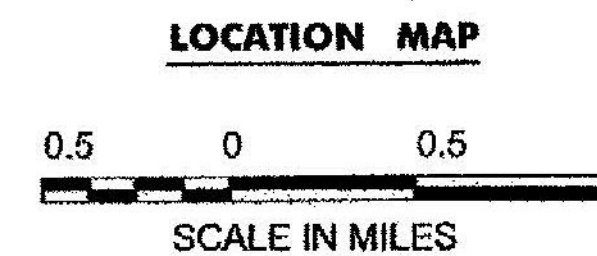
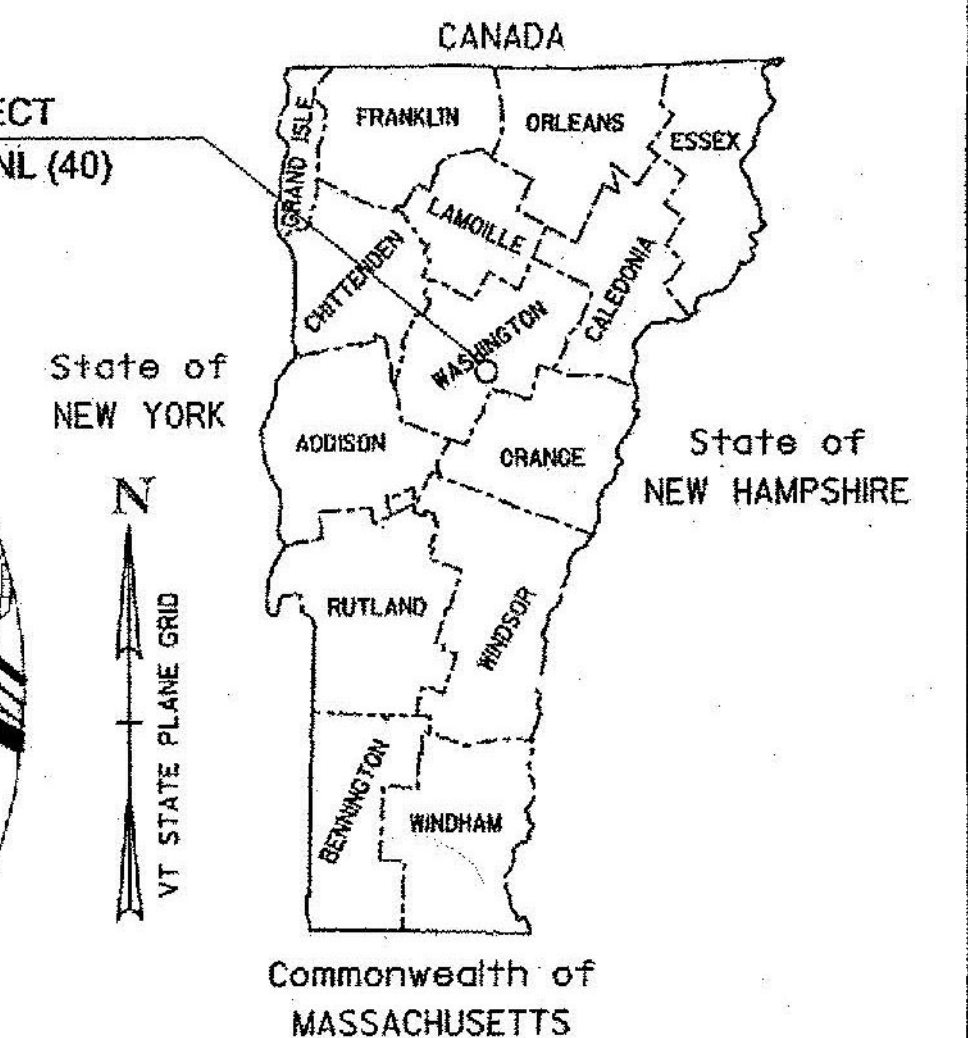
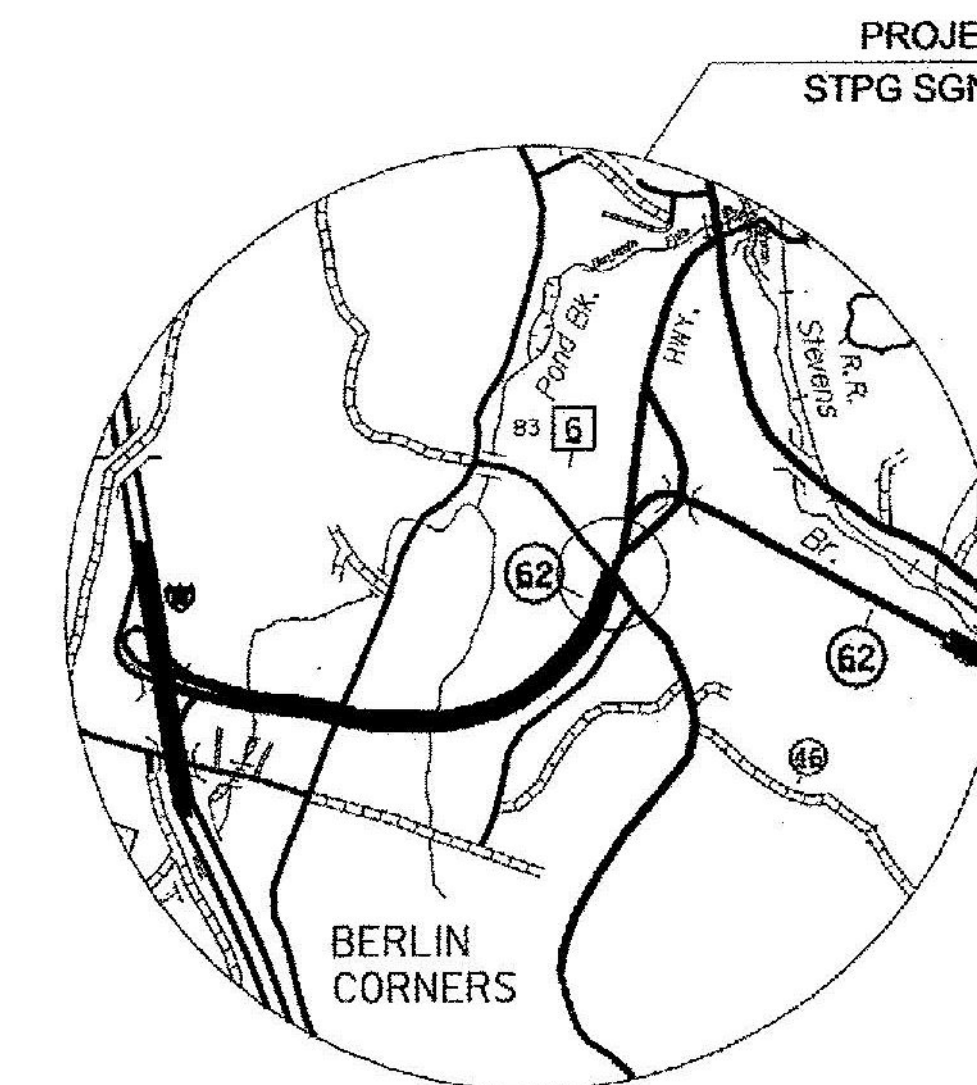

BEGINNING IN THE TOWN OF BERLIN ON VT ROUTE 62 AT A POINT (MM 1.230) AND EXTENDING APPROXIMATELY 3,607 FEET EASTERLY ON VT 62 WITH APPROACHES 500 FEET NORTHERLY ON FISHER RD., 500 FEET SOUTHERLY ON AIRPORT RD., AND 650 FEET EASTERLY ON BERLIN STATE HIGHWAY.

LENGTH OF PROJECT: 3607.34 FEET = 0.683 MILES

THE PROJECT SHALL CONSIST OF THE INSTALLATION OF NEW TRAFFIC SIGNAL EQUIPMENT, RESURFACING, ADDITION OF A LEFT TURN LANE ON AIRPORT RD., REALIGNMENT OF BERLIN STATE HIGHWAY, LANE TAPER ON VT ROUTE 62, TRAFFIC SIGNS, SIGN BRIDGE, PAVEMENT MARKINGS, AND OTHER HIGHWAY RELATED ITEMS.

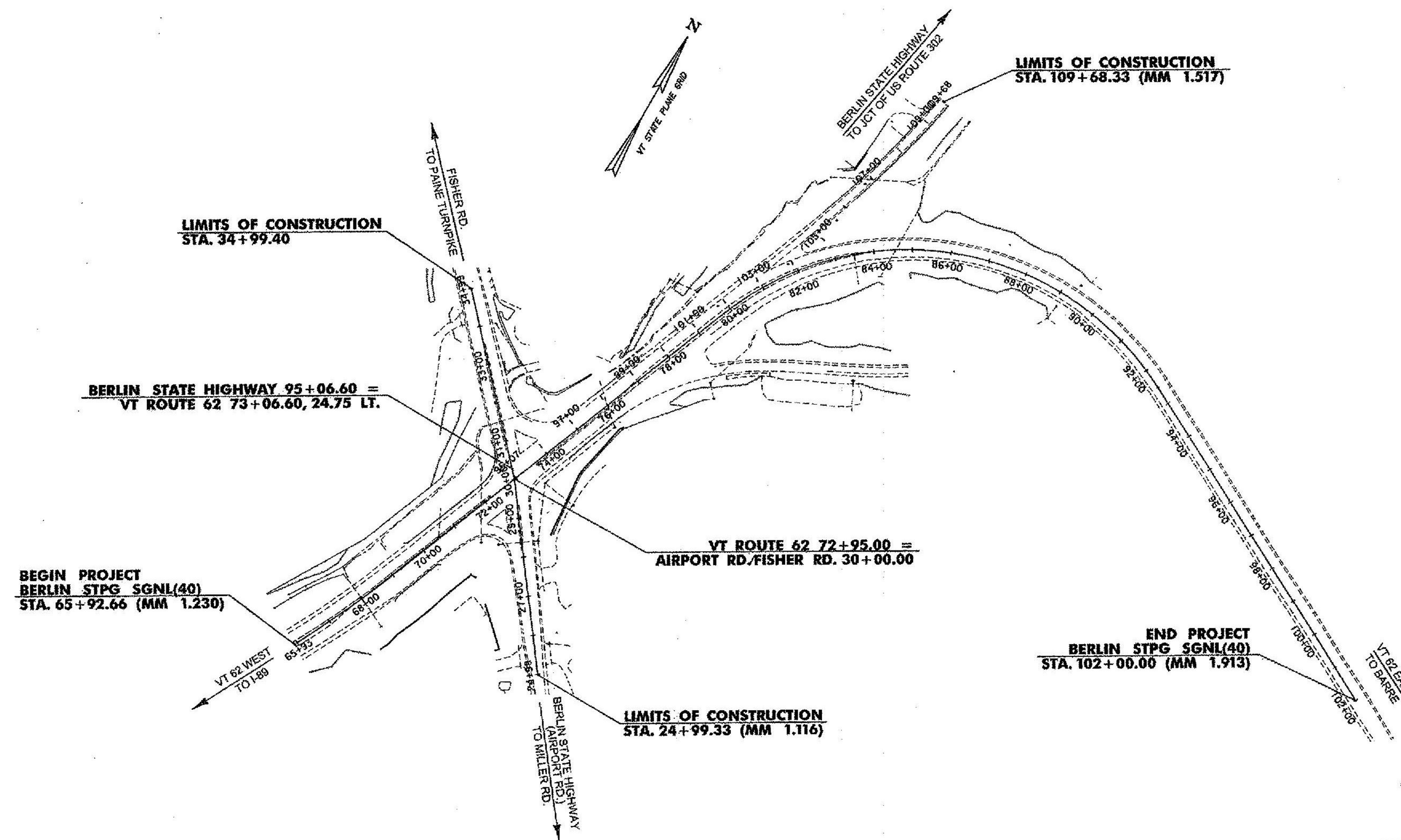

CONSTRUCTION IS TO BE CARRIED ON IN ACCORDANCE WITH THESE PLANS AND THE STANDARD SPECIFICATIONS FOR CONSTRUCTION DATED 2011, AS APPROVED BY THE FEDERAL HIGHWAY ADMINISTRATION ON JULY 20, 2011 FOR USE ON THIS PROJECT, INCLUDING ALL SUBSEQUENT REVISIONS AND SUCH REVISED SPECIFICATIONS AND SPECIAL PROVISIONS AS ARE INCORPORATED IN THESE PLANS.

QUALITY ASSURANCE PROGRAM: LEVEL 2

SURVEYED BY:	VTRANS
SURVEYED DATE:	4/25/11
<b>DATUM</b>	
VERTICAL	NAVD88
HORIZONTAL	NAD83 (2007)

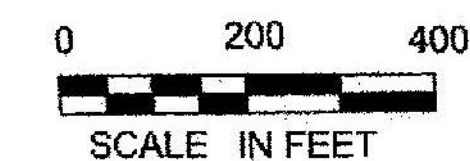

DIRECTOR OF PROJECT DELIVERY	
APPROVED:	<i>[Signature]</i> DATE: 10/17/2014
PROJECT MANAGER:	PATRICIA COBURN, P.E.
PROJECT NAME:	BERLIN
PROJECT NUMBER:	STPG SGNL (40)
SHEET 1 OF 123 SHEETS	