

# STATE OF VERMONT AGENCY OF TRANSPORTATION

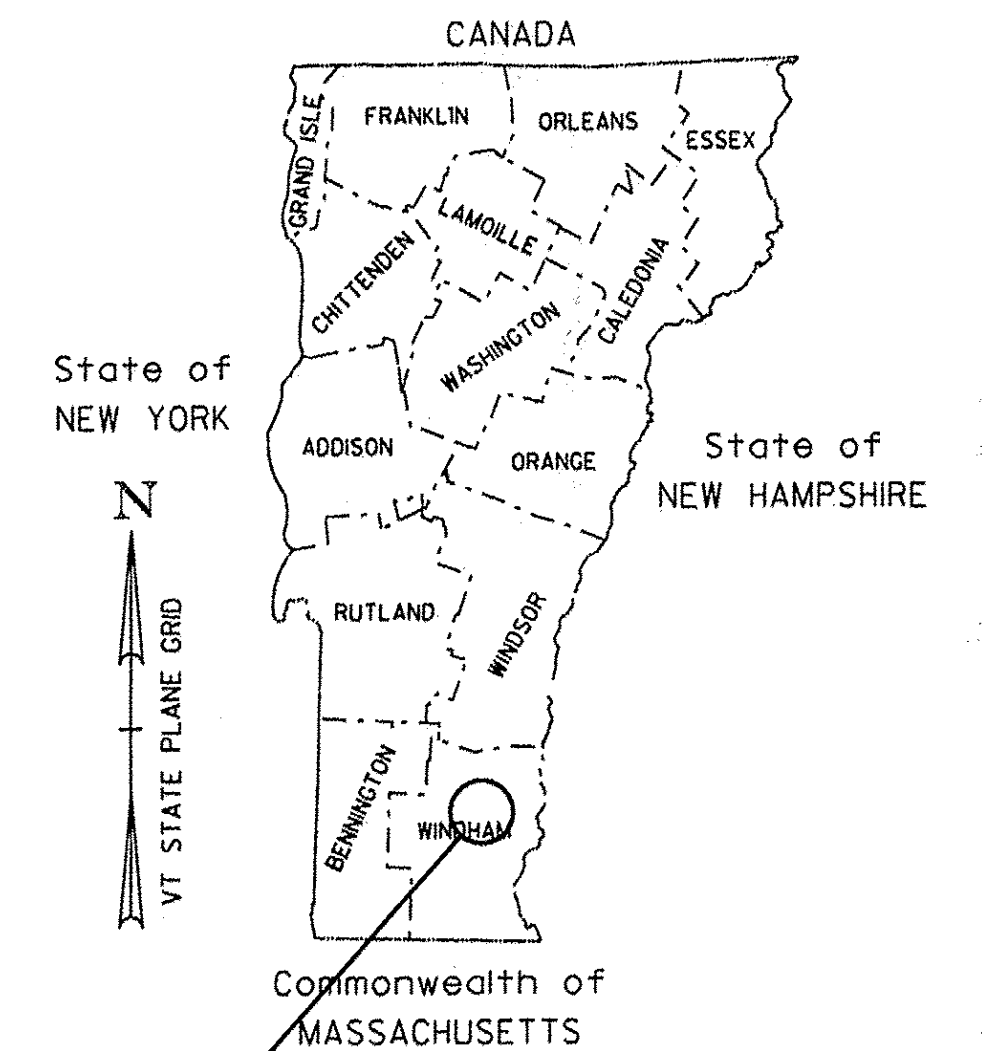

## PROPOSED IMPROVEMENT BRIDGE PROJECT

TOWN OF JAMAICA  
COUNTY OF WINDHAM

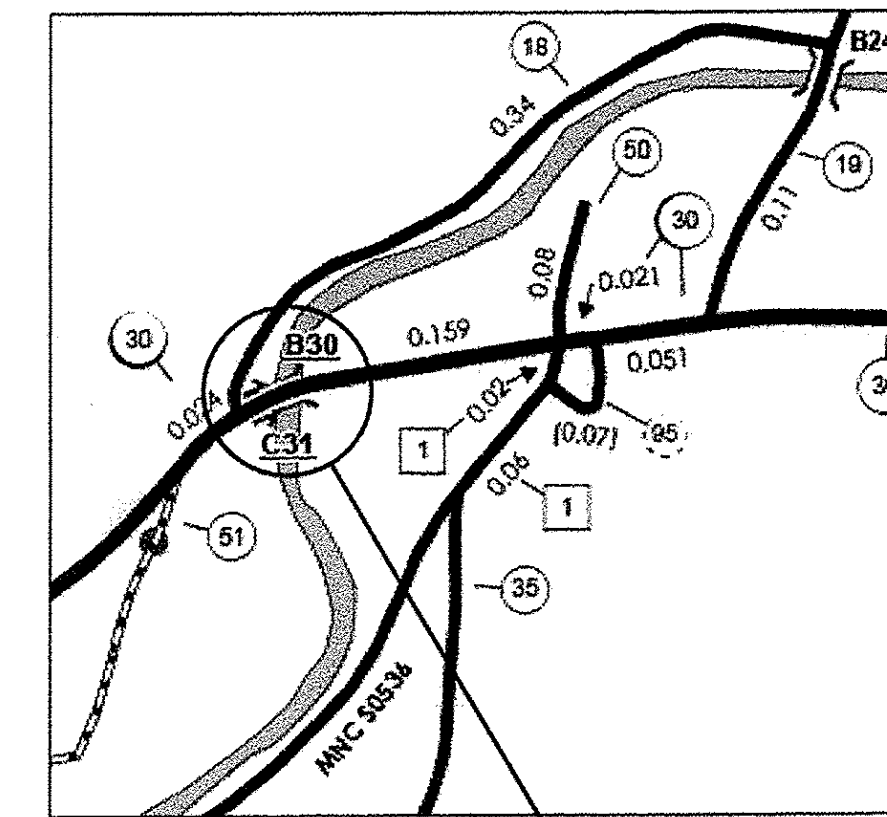

JAMAICA  
ER-BRF 015-1 (23)

RECORD PLANS	
CONTRACTOR:	MILLER CONSTRUCTION, INC - WINDSOR, VT
RESIDENT ENGINEER:	CHAD GREENWOOD
CONSTRUCTION BEGAN:	APRIL 16, 2013
CONSTRUCTION COMPLETE:	SEPTEMBER 20, 2014
RECORD PLANS BY:	CHAD GREENWOOD & KEVIN KING
I HEREBY CERTIFY THAT ALL THE CONSTRUCTION REQUIRED BY THIS SET OF DRAWINGS HAS BEEN ACCOMPLISHED AS INDICATED HEREIN.	
BY <u>Chad C. Greenwood</u>	RESIDENT ENGINEER
DATE <u>5/19/16</u>	
NOTE: Any further information concerning final quantities, amounts or other details relative to this project may be found at Central Files in the electronic archives.	

ROUTE NO : VT RTE 30 (MINOR ARTERIAL) BRIDGE NO : 30

PROJECT LOCATION : LOCATED 4.8 MILES SOUTH OF THE NORTHERN JUNCTION OF VT 100 AND VT 30 AT MILE MARKER 3.99 (STA 209+75) AND PROCEEDS SOUTHWESTERLY FOR 375 FEET TO MILE MARKER 4.06 (STA 213+50).

PROJECT DESCRIPTION : REPLACE EXISTING BRIDGE AND BOX CULVERT WITH RELATED ROADWAY APPROACH AND CHANNEL WORK.

LENGTH OF STRUCTURE : 131.66 FEET.  
 LENGTH OF ROADWAY : 243.34 FEET.  
 LENGTH OF PROJECT : 375.00 FEET.

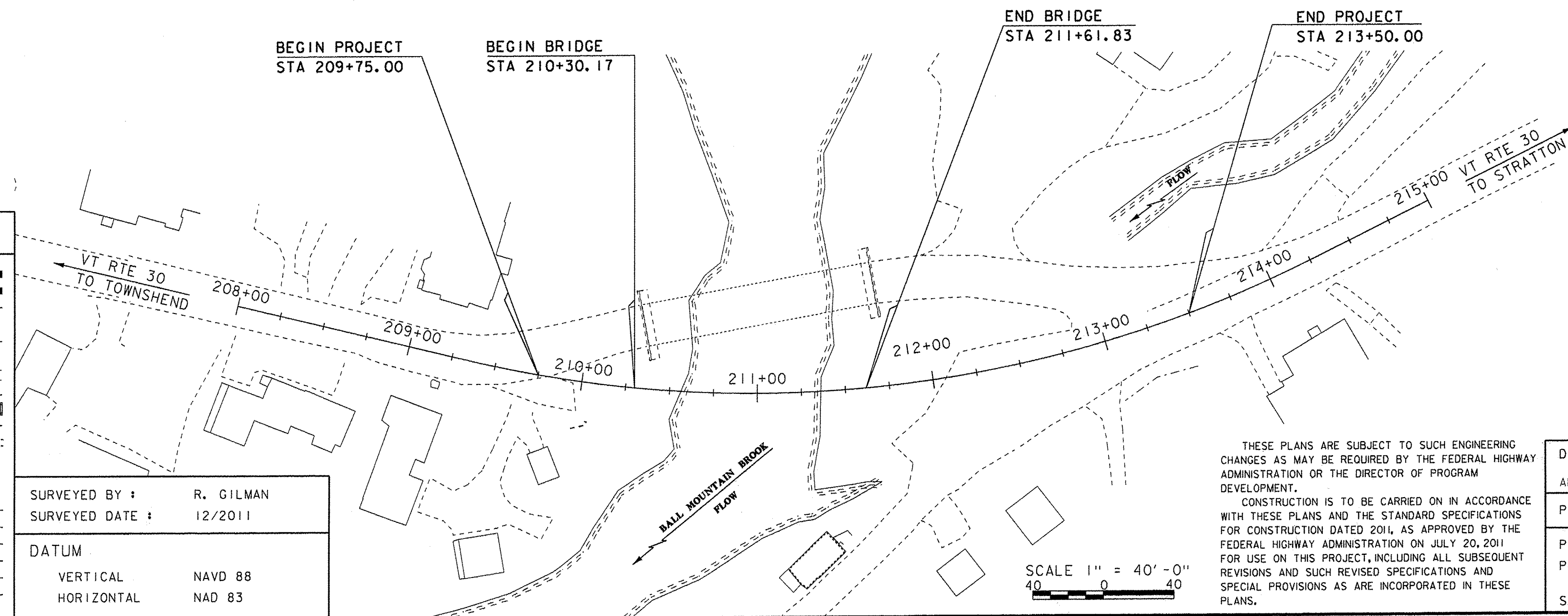

QUALITY ASSURANCE PROGRAM: LEVEL 2

CONVENTIONAL SYMBOLS	
COUNTY LINE	
TOWN LINE	
LIMITS OF ACCESS	
POINT OF ACCESS	
FENCE LINE	
STONE WALL	
TRAVELED WAY	
GUARD RAIL	
RAILROAD	
SURVEY LINE	
CULVERT	
POWER POLE	
TELEPHONE POLE	
TREES	
CONTROL OF ACCESS	
PROPERTY LINE	
R.O.W. TAKING LINE	
SLOPE RIGHTS	
TOP OF CUT	
TOE OF SLOPE	

SURVEYED BY : R. GILMAN  
 SURVEYED DATE : 12/2011  
 DATUM  
 VERTICAL : NAVD 88  
 HORIZONTAL : NAD 83

THESE PLANS ARE SUBJECT TO SUCH ENGINEERING CHANGES AS MAY BE REQUIRED BY THE FEDERAL HIGHWAY ADMINISTRATION OR THE DIRECTOR OF PROGRAM DEVELOPMENT.  
 CONSTRUCTION IS TO BE CARRIED ON IN ACCORDANCE WITH THESE PLANS AND THE STANDARD SPECIFICATIONS FOR CONSTRUCTION DATED 2011, AS APPROVED BY THE FEDERAL HIGHWAY ADMINISTRATION ON JULY 20, 2011 FOR USE ON THIS PROJECT, INCLUDING ALL SUBSEQUENT REVISIONS AND SUCH REVISED SPECIFICATIONS AND SPECIAL PROVISIONS AS ARE INCORPORATED IN THESE PLANS.

DIRECTOR OF PROGRAM DEVELOPMENT  
 APPROVED Richard Johnson DATE 11-29-12  
 PROJECT MANAGER : KRISTIN HIGGINS  
 PROJECT NAME : JAMAICA  
 PROJECT NUMBER : ER-BRF 015-1 (23)  
 SHEET 1 OF 82 SHEETS

SCALE 1" = 40'-0"

