

STATE OF VERMONT AGENCY OF TRANSPORTATION

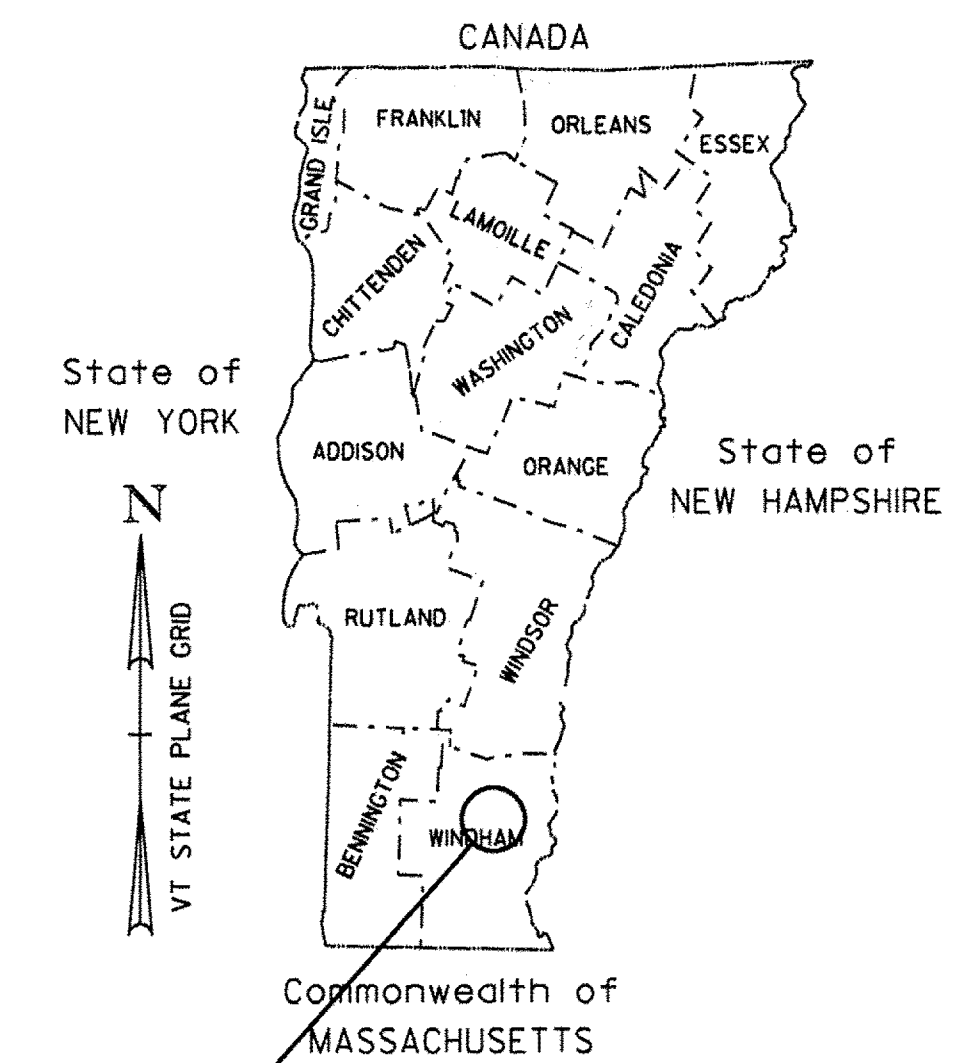

PROPOSED IMPROVEMENT BRIDGE PROJECT

TOWN OF JAMAICA
COUNTY OF WINDHAM

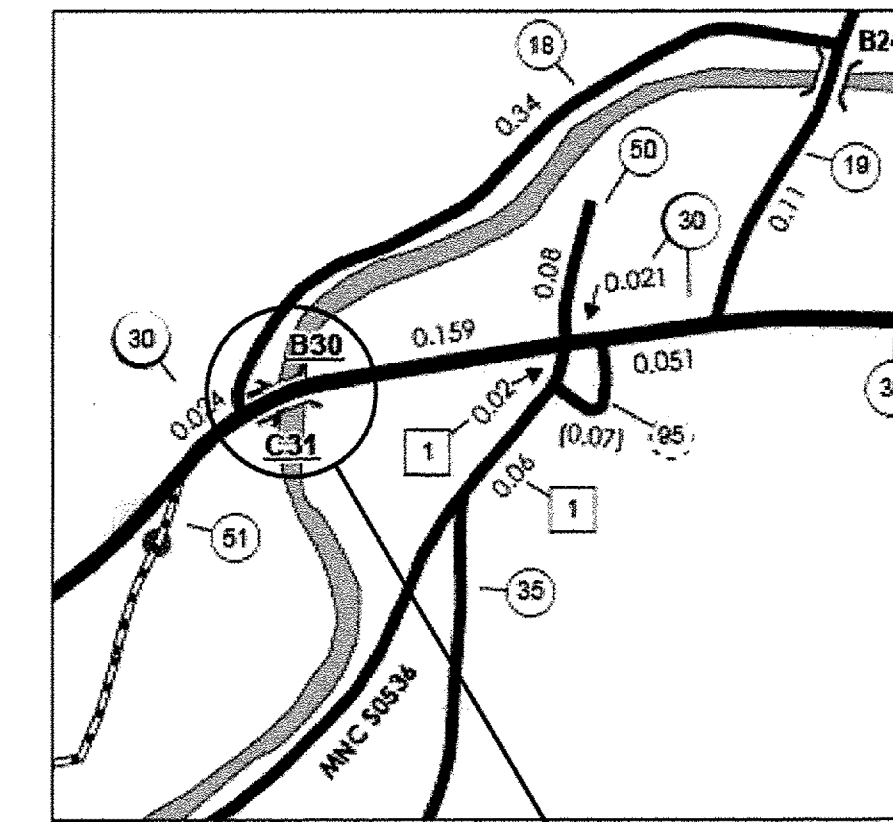

JAMAICA
ER-BRF 015-1 (23)

ROUTE NO : VT RTE 30 (MINOR ARTERIAL) BRIDGE NO : 30

PROJECT LOCATION : LOCATED 4.8 MILES SOUTH OF THE NORTHERN JUNCTION OF VT 100 AND VT 30
AT MILE MARKER 3.99 (STA 209+75) AND PROCEEDS SOUTHWESTERLY FOR
375 FEET TO MILE MARKER 4.06 (STA 213+50).

PROJECT DESCRIPTION : REPLACE EXISTING BRIDGE AND BOX CULVERT WITH RELATED ROADWAY APPROACH AND CHANNEL WORK.

LENGTH OF STRUCTURE : 131.66 FEET.
LENGTH OF ROADWAY : 243.34 FEET.
LENGTH OF PROJECT : 375.00 FEET.

BEGIN PROJECT
STA 209+75.00

BEGIN BRIDGE
STA 210+30.17

END BRIDGE
STA 211+61.83

END PROJECT
STA 213+50.00

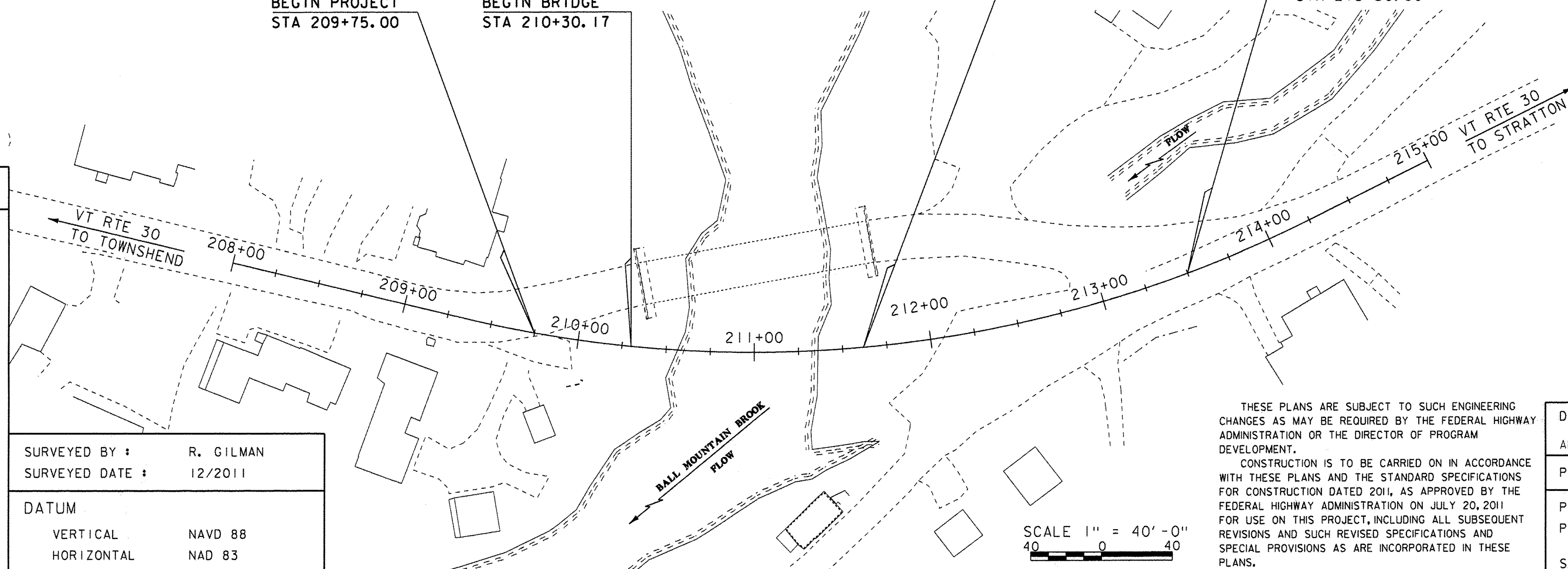

QUALITY ASSURANCE PROGRAM: LEVEL 2

CONVENTIONAL SYMBOLS

COUNTY LINE	
TOWN LINE	
LIMITS OF ACCESS	
POINT OF ACCESS	
FENCE LINE	
STONE WALL	
TRAVELED WAY	
GUARD RAIL	
RAILROAD	
SURVEY LINE	
CULVERT	
POWER POLE	
TELEPHONE POLE	
TREES	
CONTROL OF ACCESS	
PROPERTY LINE	
R.O.W. TAKING LINE	
SLOPE RIGHTS	
TOP OF CUT	
TOE OF SLOPE	

SURVEYED BY : R. GILMAN
SURVEYED DATE : 12/2011

DATUM
VERTICAL NAVD 88
HORIZONTAL NAD 83

SCALE 1" = 40' - 0"
40 0 40

THESE PLANS ARE SUBJECT TO SUCH ENGINEERING CHANGES AS MAY BE REQUIRED BY THE FEDERAL HIGHWAY ADMINISTRATION OR THE DIRECTOR OF PROGRAM DEVELOPMENT.
CONSTRUCTION IS TO BE CARRIED ON IN ACCORDANCE WITH THESE PLANS AND THE STANDARD SPECIFICATIONS FOR CONSTRUCTION DATED 2011, AS APPROVED BY THE FEDERAL HIGHWAY ADMINISTRATION ON JULY 20, 2011 FOR USE ON THIS PROJECT, INCLUDING ALL SUBSEQUENT REVISIONS AND SUCH REVISED SPECIFICATIONS AND SPECIAL PROVISIONS AS ARE INCORPORATED IN THESE PLANS.

DIRECTOR OF PROGRAM DEVELOPMENT	
APPROVED	DATE 11-29-12
PROJECT MANAGER :	KRISTIN HIGGINS
PROJECT NAME :	JAMAICA
PROJECT NUMBER :	ER-BRF 015-1 (23)
SHEET 1 OF 82 SHEETS	

