

RICHFORD SNTH 139 /RIVER STREET INTERSECTION

ITEM 900.620 SPECIAL PROVISION (REMOVE & REPLACE FLASHING BEACON, AERIAL MOUNTED) RICHFORD STA. 15+26		
QUANTITY	UNIT	DESCRIPTION
1	EA	FLASHING BEACON SIGNAL HEAD (4 SINGLE SECTIONS WITH MOUNTING HARDWARE)

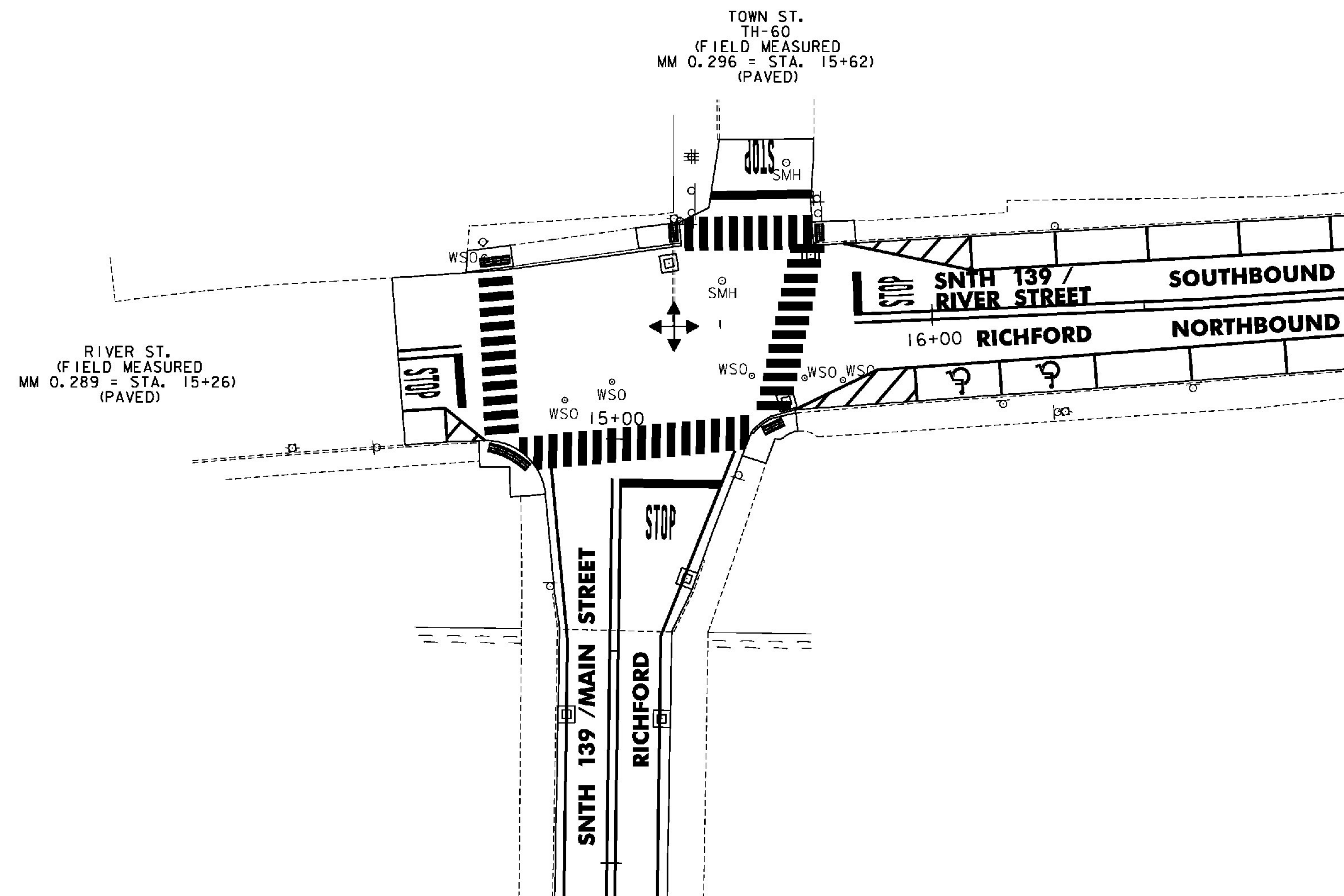

LEGEND	
DESCRIPTION	
-----	EXISTING CONDUIT
□	EXISTING JUNCTION BOX
[CT]	EXISTING CONTROLLER CABINET
⊕	EXISTING POLE
□	EXISTING VIDEO DETECTION AREA
□	VIDEO DETECTION AREA
⊕	EXISTING VIDEO DETECTOR CAMERA
⊕	PROPOSED VIDEO DETECTOR CAMERA
⊕	EXISTING VEHICLE SIGNAL
⊕	PROPOSED VEHICLE SIGNAL
[PB]	EXISTING PULL BOX
⊕	EXISTING PEDESTRIAN SIGNAL
⊕	PROPOSED COUNT-DOWN PEDESTRIAN SIGNAL

NOTES:

1. THIS PLAN SHEET IS NOT TO SCALE AND SHALL ONLY BE USED AS A GUIDE FOR THE PLACEMENT OF HARDWARE LISTED. THE CONTRACTOR SHALL CONFIRM ALL LOCATIONS IN THE FIELD WITH THE ENGINEER PRIOR TO INSTALLATION. LOCATIONS MAY BE REVISED AS A RESULT OF THE SITE SURVEY.
2. ALL EXISTING FLASHING BEACON SIGNAL HEADS SHALL BE REPLACED WITH NEW SIGNAL HEADS AS SHOWN.
3. UNIFORMED TRAFFIC OFFICERS CAN DIRECT TRAFFIC AND FLAGGERS CAN ONLY STOP AND RELEASE TRAFFIC.

NOT TO SCALE

TRAFFIC SIGNAL SYSTEM SHEET

PROJECT NAME: ENOSBURG-RICHFORD
PROJECT NUMBER: STP 2939(I)

FILE NAME: p11b312.dgn
PROJECT LEADER: J. LITTLE
DESIGNED BY: J. LITTLE
IPARM FILE: p11b312tsss.i

PLOT DATE: 3/19/2014
DRAWN BY: D. DRAPER
CHECKED BY: J. LITTLE
SHEET 112 OF 115

