

THINNING AND TRIMMING FOR SIGNS
 STA. 131+01, LT
 SEE SHEET 19

DURABLE & TEMPORARY 4 INCH WHITE LINE
 (ALL LINES WILL INCLUDE EDGE LINE BREAKS
 AND RADII FOR SIDE ROADS)
 STA. 130+00 TO 133+53.12, SOLID LT & RT

DURABLE & TEMPORARY 4 INCH YELLOW LINE
 (ALL LINES WILL INCLUDE $\frac{1}{2}$ BREAKS FOR SIDE ROADS)
 STA. 130+00 TO 133+53.12, SOLID LT & RT

GRUBBING MATERIAL
 STA. 131+57 TO 133+53.12, LT

REMOVING SIGNS
 AS SHOWN - 7

~~STONE FILL, TYPE 1~~
~~STA. 131+57 TO 133+53.12, LT~~

STEEL BEAM GUARDRAIL, GALVANIZED
 STA. 130+00 TO 130+12, LT

STEEL BEAM GUARDRAIL, GALVANIZED
 W/ 8 FEET POSTS
 STA. 130+12 TO 133+89, LT

REMOVAL AND DISPOSAL OF GUARDRAIL
 STA. 130+00 TO 133+89, LT

**END STP 2939(1) VT ROUTE 105
 RICHFORD STA. 133+53.12 = (MM 2.529)**

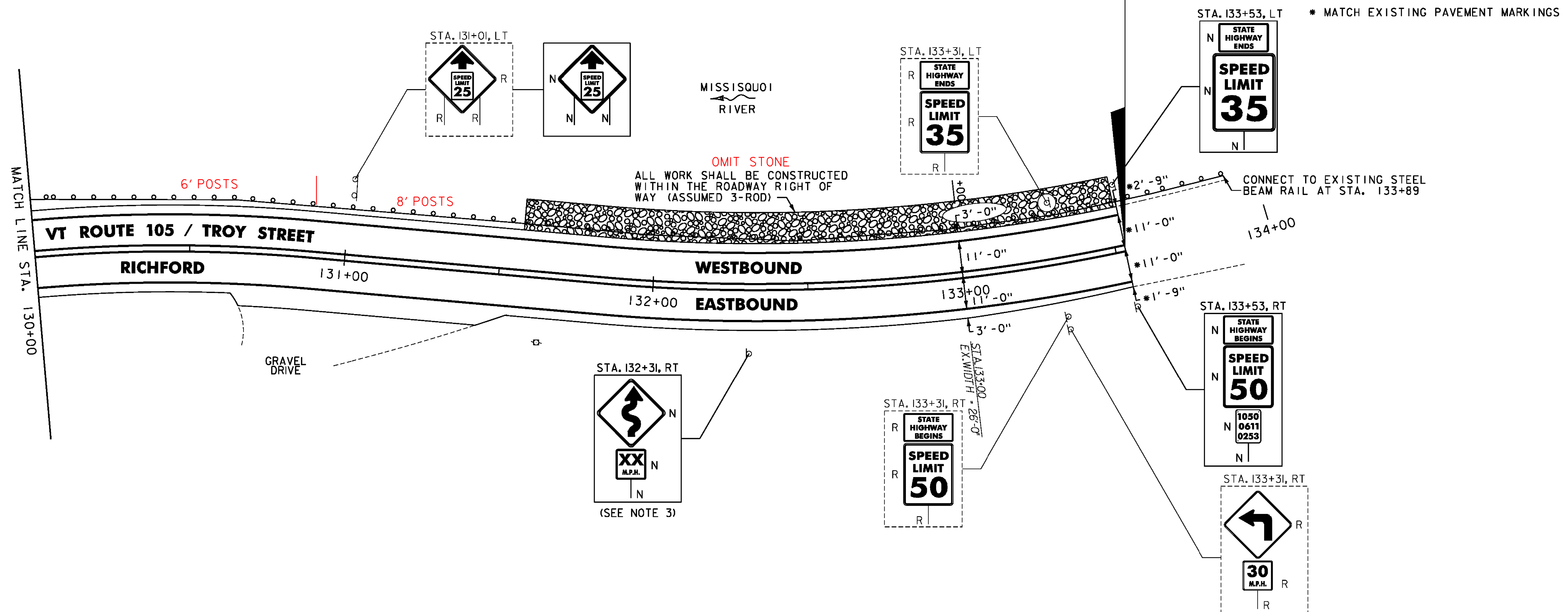

NOTES:

- FOR LEGENDS, SEE SHEET 22.
- ALL EXISTING SIGNS NOT SHOWN SHALL BE RETAINED.
- THE ADVISORY SPEED SHALL BE DETERMINED USING AN ESTABLISHED ENGINEERING PRACTICE AS LISTED IN SECTION 2C.08 OF THE MUTCD.

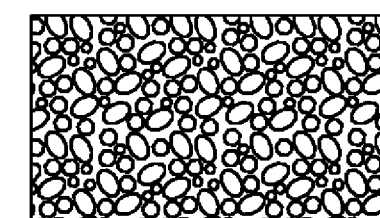

PROPOSED SLOPE EROSION REPAIR AREAS
 SEE SHEET 18 FOR DETAIL

NOT TO SCALE

**PROJECT LAYOUT
 SHEET #33**



PROJECT NAME: ENOSBURG-RICHFORD
 PROJECT NUMBER: STP 2939(1)

FILE NAME: p11b312.dgn
 PROJECT LEADER: J. LITTLE
 DESIGNED BY: J. LITTLE
 IPARM FILE: p11b312133.i

PLOT DATE: 3/19/2014
 DRAWN BY: D. DRAPER
 CHECKED BY: J. LITTLE
 SHEET 54 OF 115