

CHANGING ELEVATION OF SEWER MANHOLES
 STA. 82+04, LT
 STA. 84+61, LT

BITUMINOUS CONCRETE GUTTERS AND TRAFFIC ISLANDS
 STA. 84+84 TO 86+00, LT

ADJUST ELEVATION OF VALVE BOX
 STA. 84+03, RT
 STA. 84+52, RT
 STA. 84+55, RT

DURABLE & TEMPORARY 4 INCH WHITE LINE
 (ALL LINES WILL INCLUDE 6" BREAKS FOR SIDE ROADS)
 STA. 80+09.76 TO 86+00, SOLID LT & RT

DURABLE & TEMPORARY 4 INCH YELLOW LINE
 (ALL LINES WILL INCLUDE 6" BREAKS FOR SIDE ROADS)
 STA. 80+09.76 TO 86+00, SOLID LT & RT
 STA. 84+65, DOUBLE SOLID LT (MAPLE ST.)

DURABLE & TEMPORARY 24 INCH STOP BAR
 STA. 84+65, LT (MAPLE ST.)

DURABLE & TEMPORARY LETTER OR SYMBOL
 STA. 84+65, LT "STOP" (MAPLE ST.)

REMOVING SIGNS
 AS SHOWN - 13

ERECTING SALVAGED SIGNS
 AS SHOWN - 1

**BEGIN STP 2939(1) VT ROUTE 105
 RICHFORD STA. 80+09.76 = (MM 1.517)**

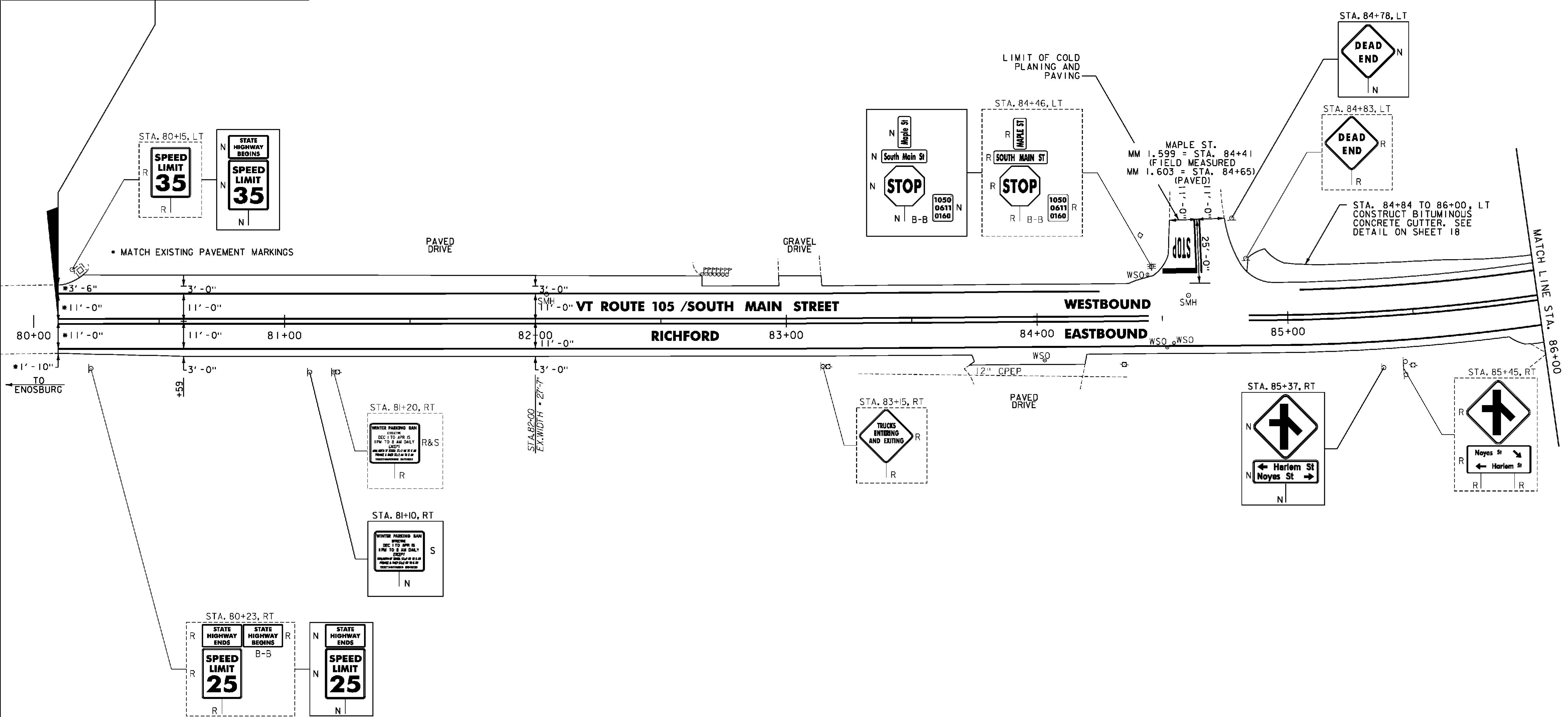

- NOTES:
- FOR LEGENDS, SEE SHEET 22.
 - ALL EXISTING SIGNS NOT SHOWN SHALL BE RETAINED.



NOT TO SCALE

PROJECT LAYOUT SHEET #23

PROJECT NAME: ENOSBURG-RICHFORD	PLOT DATE: 3/19/2014
PROJECT NUMBER: STP 2939(1)	DRAWN BY: D. DRAPER
FILE NAME: p11b312.dgn	CHECKED BY: J. LITTLE
PROJECT LEADER: J. LITTLE	SHEET 44 OF 115
DESIGNED BY: J. LITTLE	
IPARM FILE: p11b312123.i	