

**BEGIN STP 2939(1) VT ROUTE 105
ENOSBURG STA. 24+49.92 = (MM 0.464)**

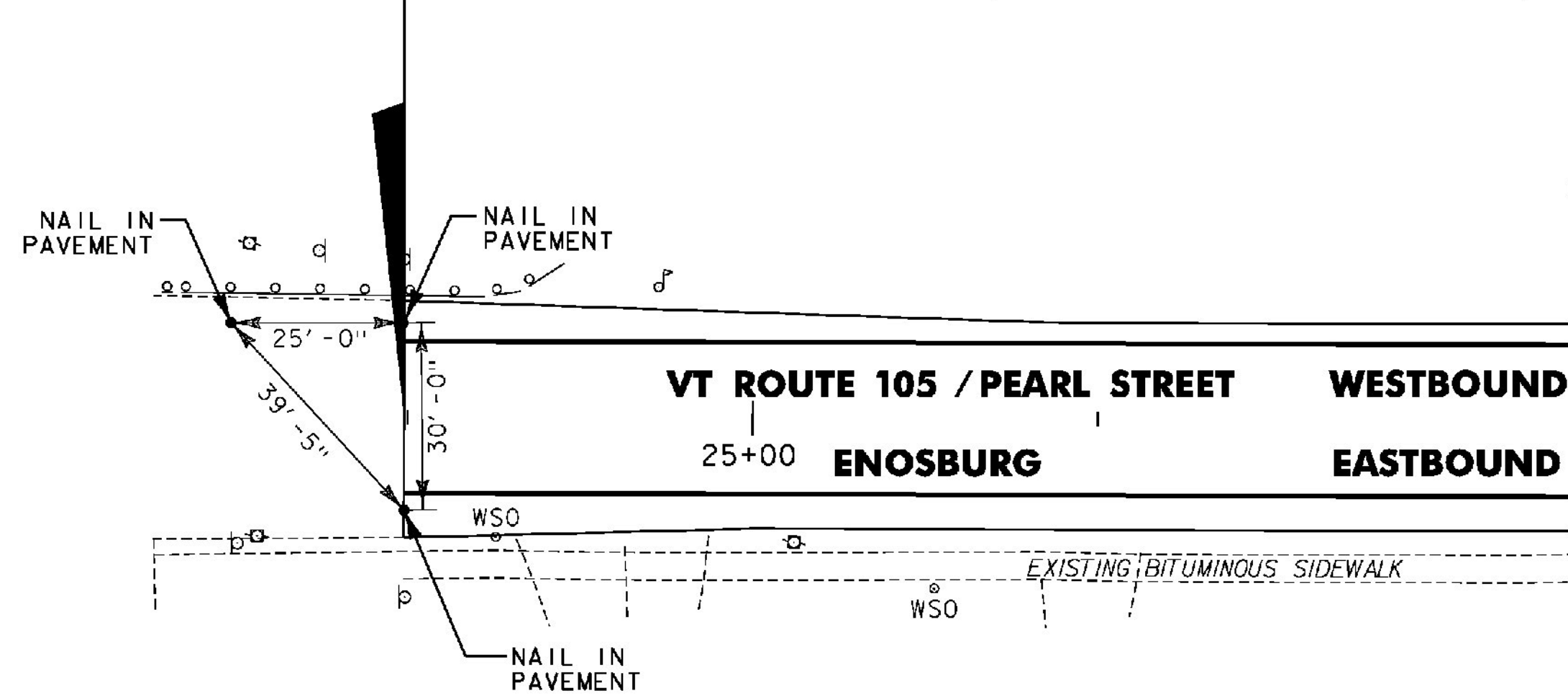

VT ROUTE 105 ENOSBURG BEGIN PROJECT LOCATION TIES

**BEGIN STP 2939(1) VT ROUTE 108
ENOSBURG STA. 237+44.16 = (MM 4.497)**

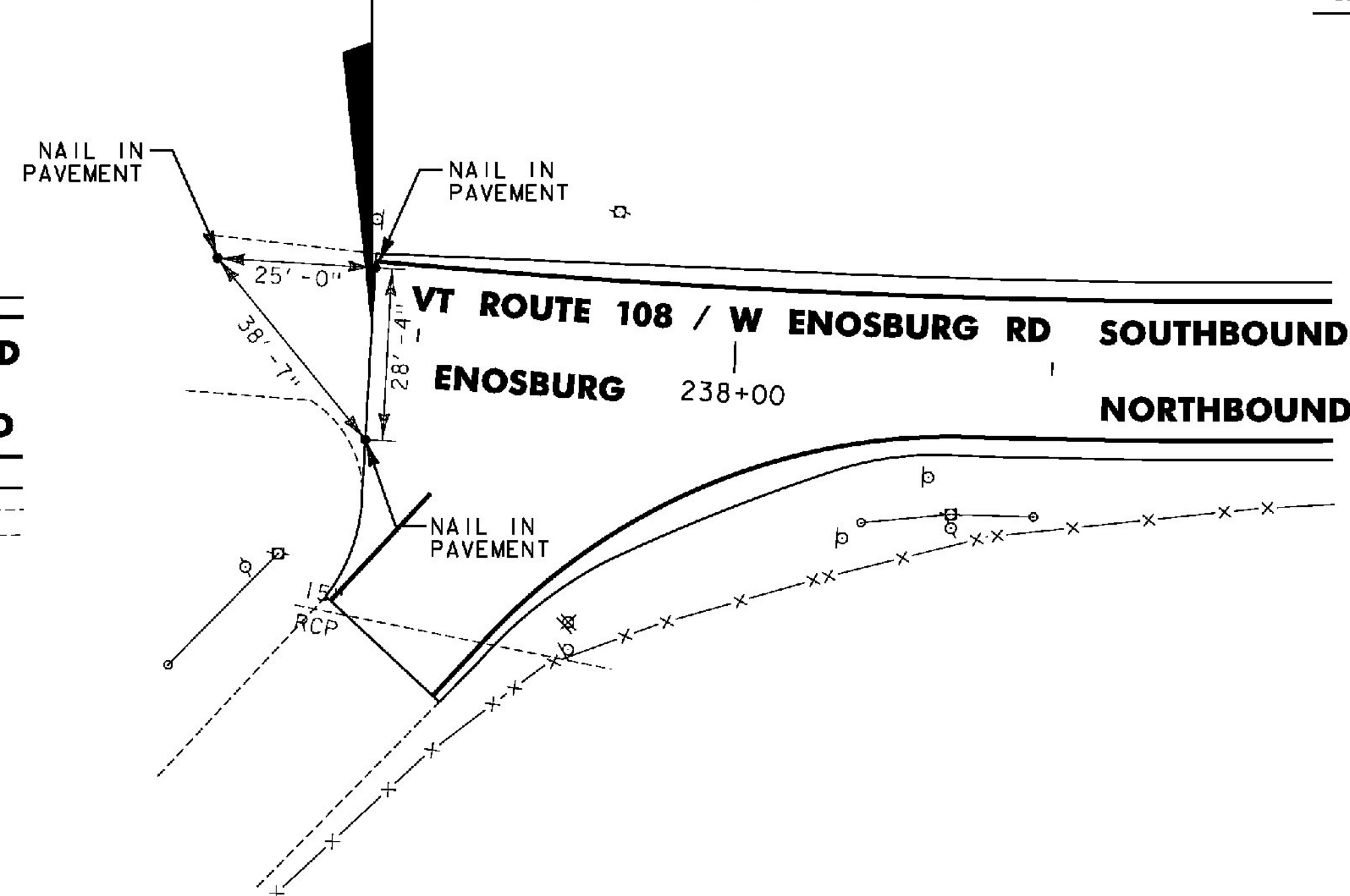

VT ROUTE 108 ENOSBURG BEGIN PROJECT LOCATION TIES

**BEGIN STP 2939(1) VT ROUTE 105
RICHFORD STA. 80+09.76 = (MM 1.517)**

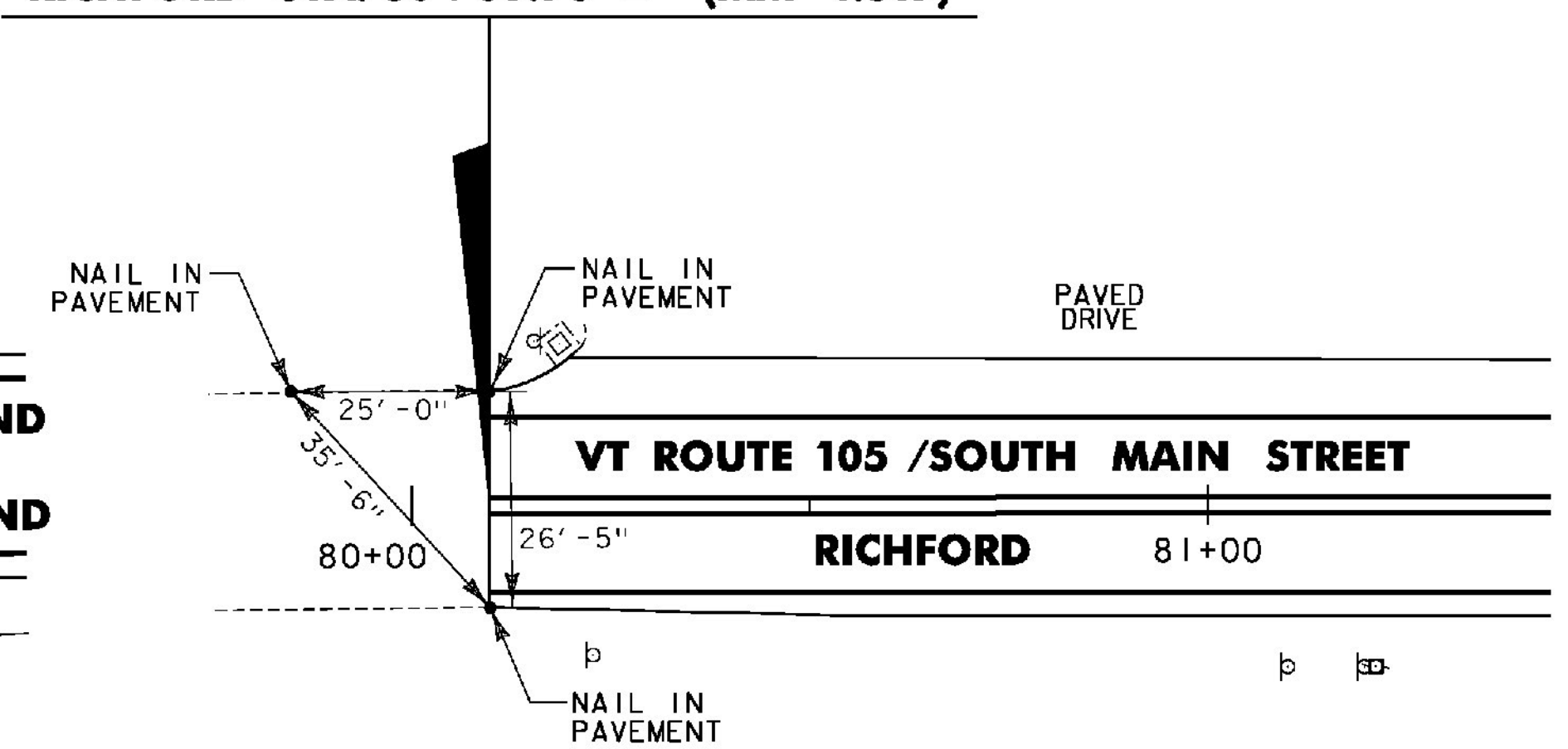

VT ROUTE 105 RICHFORD BEGIN PROJECT LOCATION TIES

**END STP 2939(1) VT ROUTE 105
ENOSBURG STA. 80+73.12 = (MM 1.529)**

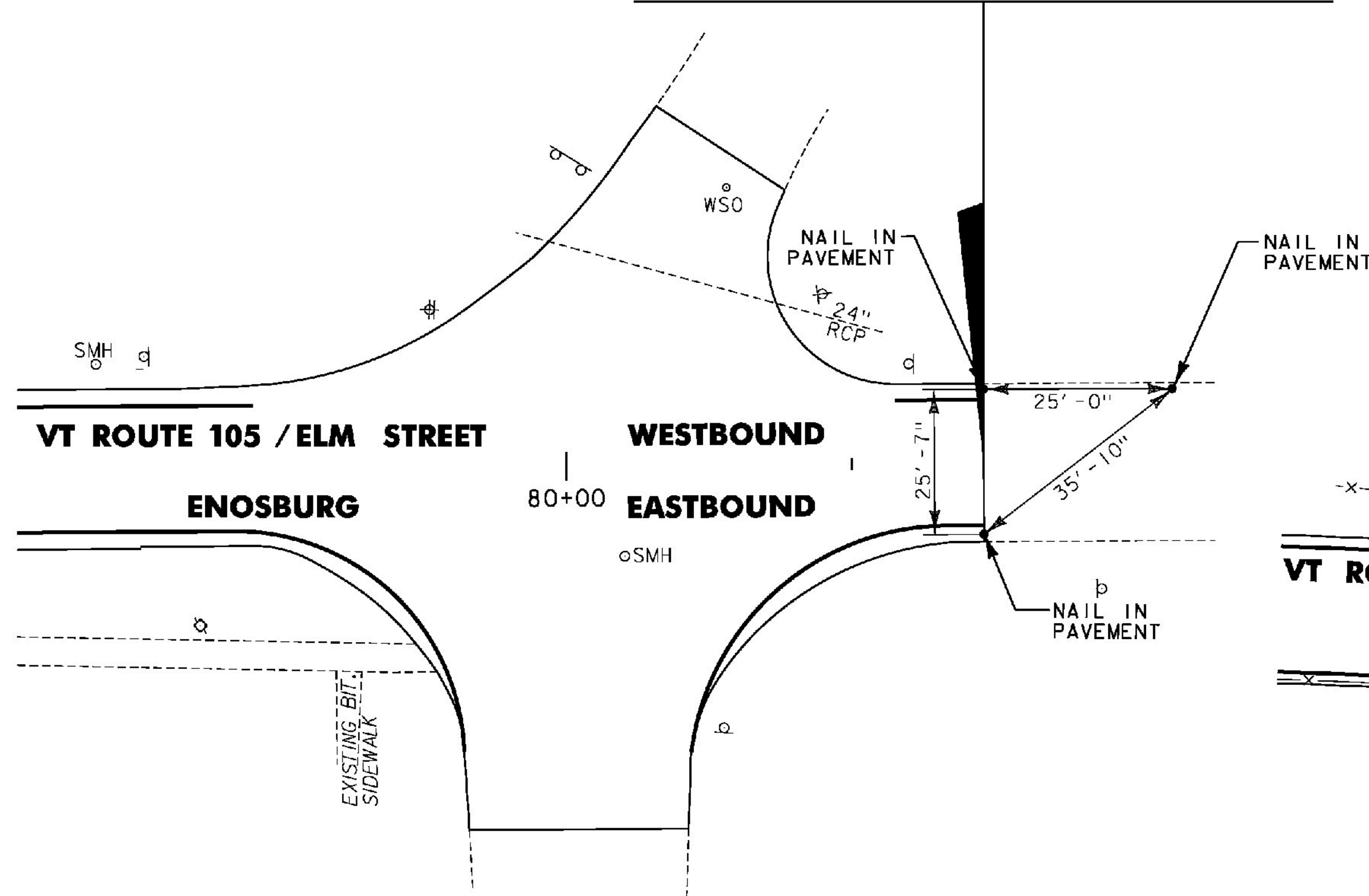

VT ROUTE 105 ENOSBURG END PROJECT LOCATION TIES

**END STP 2939(1) VT ROUTE 108
ENOSBURG STA. 311+62.56 = (MM 5.902)**

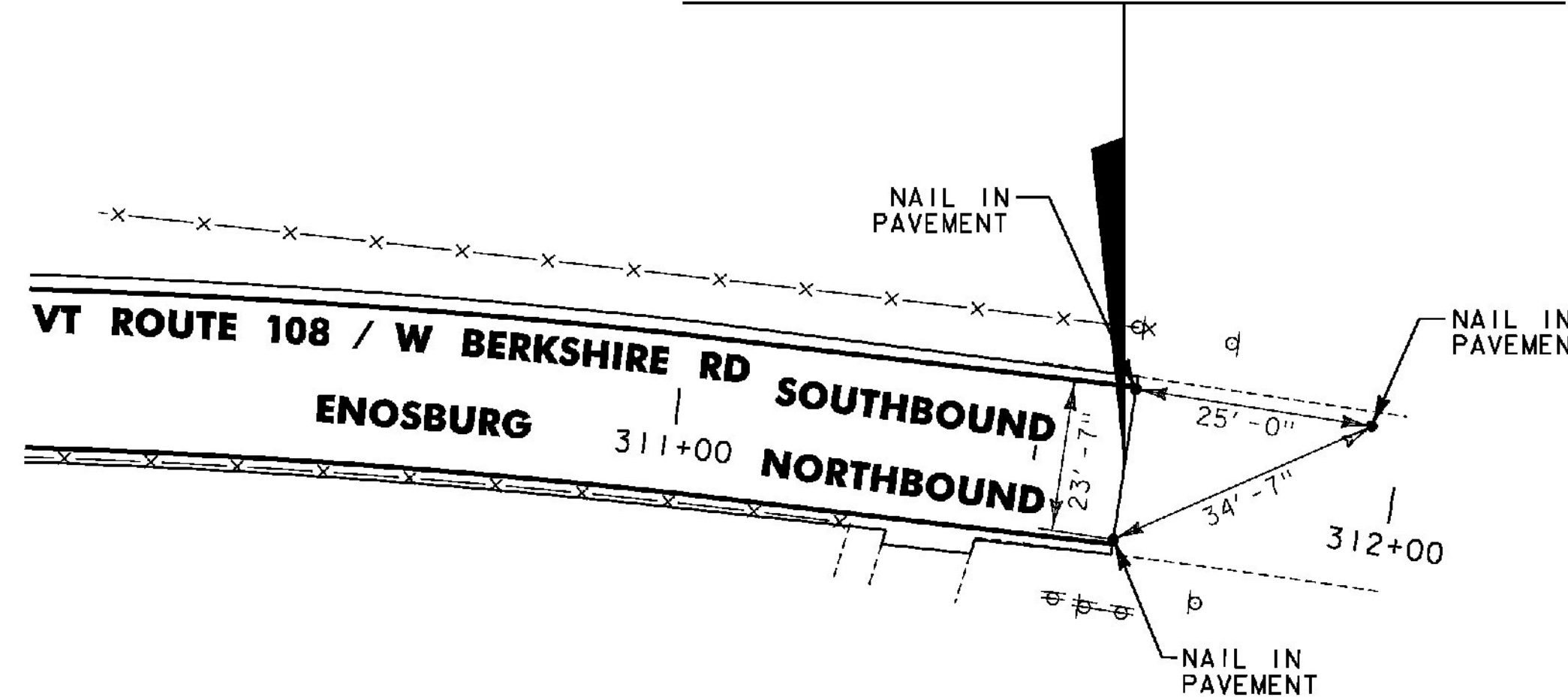

VT ROUTE 108 ENOSBURG END PROJECT LOCATION TIES

**END STP 2939(1) VT ROUTE 105
RICHFORD STA. 133+53.12 = (MM 2.529)**

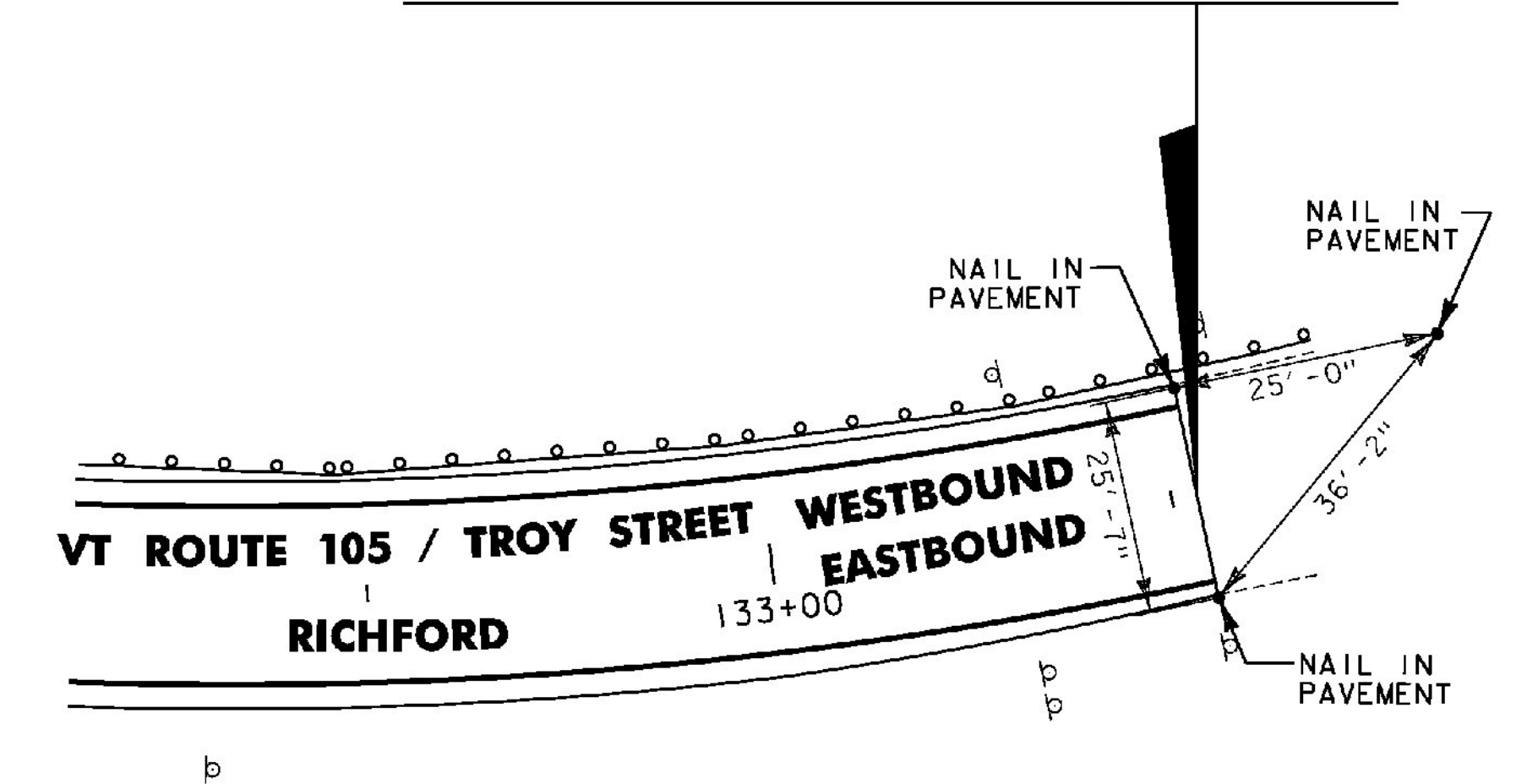

VT ROUTE 105 RICHFORD END PROJECT LOCATION TIES

NOT TO SCALE

**MISCELLANEOUS
DETAIL
SHEET #3**

PROJECT NAME: ENOSBURG-RICHFORD
PROJECT NUMBER: STP 2939(1)

FILE NAME: p11b312.dgn
PROJECT LEADER: J. LITTLE
DESIGNED BY: J. LITTLE
IPARM FILE: p11b312md03.i

PLOT DATE: 3/19/2014
DRAWN BY: D. DRAPER
CHECKED BY: J. LITTLE
SHEET 20 OF 15

