

SQUARE TUBE SIGN POST AND ANCHOR AS SHOWN - 1 (SEE SIGN DETAIL SHEET)  
 TRAFFIC SIGNS, TYPE A AS SHOWN - 1 (SEE SIGN DETAIL SHEET)

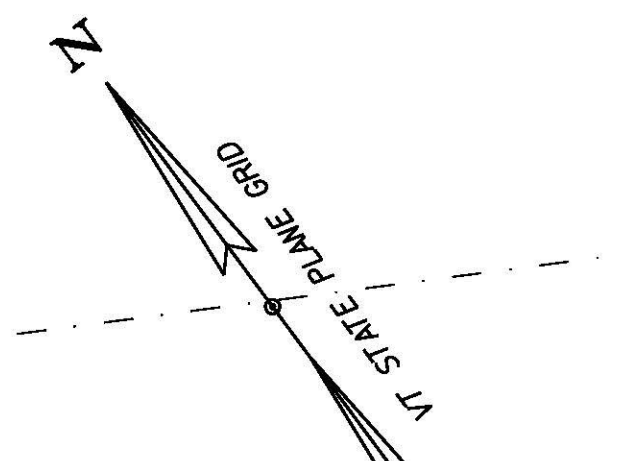

LINES SHOWN ON THIS PLAN AS EXISTING PROPERTY LINES (P/L) ARE BELIEVED TO BE ACCURATE BUT SHOULD NOT BE RELIED UPON FOR PURPOSES UNRELATED TO THE STATE OF VERMONT ACQUISITION OF LAND AND RIGHTS FOR THIS PROJECT

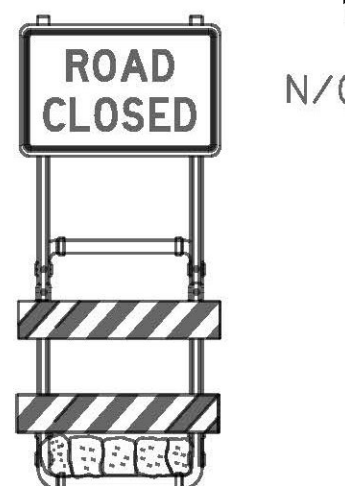

R11-2 B/W SIGN MOUNTED ON TYPE III TRIANGLE (MODIFIED)

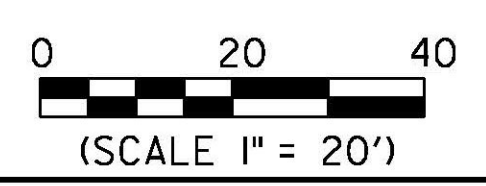

- TEMPORARY 4 INCH WHITE LINE, PAINT DURABLE 4 INCH WHITE LINE, POLYUREA 429+75 TO 434+75 SOLID LT & RT
- TEMPORARY 4 INCH YELLOW LINE, PAINT DURABLE 4 INCH YELLOW LINE, POLYUREA 429+75 TO 434+75 LT & RT
- CONSTRUCT DRIVES WITH 4 FOOT PAVED APRON 432+36 RT (24.0 FT WIDE, GRAVEL, RES.) 432+00 LT (18.0 FT WIDE, GRAVEL, FIELD) 433+59 LT (24.0 FT WIDE, GRAVEL, RES.)
- RIGHT-OF-WAY PLAN REFERENCE "STATE OF VERMONT STATE HIGHWAY DEPARTMENT - PLAN AND PROFILE OF PROPOSED STATE HIGHWAY FEDERAL AID PROJECT - TOWNS OF LUNENBURG - GUILDHALL, ST. JOHNSBURY VT. - LANCASTER N.H. ROAD, VT F 131-C, DATED 1932, ON FILE AT THE VERMONT AGENCY OF TRANSPORTATION.
- STEEL BEAM GUARDRAIL, GALVANIZED 429+75 TO 430+12.5 RT 429+75 TO 430+50.0 LT
- MANUFACTURED TERMINAL SECTION, FLARED 430+12.5 TO 430+50.0 RT 430+50.0 TO 430+87.5 LT
- REMOVING AND RESETTING FENCE 433+95 TO 434+50 RT
- REMOVAL AND DISPOSAL OF GUARDRAIL 429+75 TO 430+17 RT 429+75 TO 430+52 LT
- DELINEATOR WITH STEEL POST 430+50.0 RT 430+87.5 LT 431+61.0 LT (2) 433+01.0 LT (2)
- 8 INCH UNDERDRAIN PIPE 430+00 TO 434+00 RT
- UNDERDRAIN FLUSHING BASIN 434+00 RT
- MILLED RUMBLE STRIPS 429+75 TO 434+75 CL
- REMOVING SIGNS ERECTING SALVAGED SIGNS AS SHOWN - 5

PROJECT NAME:	LUNENBURG
PROJECT NUMBER:	NH CULV(27)
FILE NAME:	11b294/cos/211b294bdrrow.dgn
PLOT DATE:	8/6/2015
PROJECT LEADER:	J. BYATT
DRAWN BY:	S. GOODWIN
DESIGNED BY:	P. SHEDD
CHECKED BY:	P. SHEDD
ROW LAYOUT SHEET 2 OF 2	SHEET 74 OF 74

CLD\_12-0106 MODEL: L02