

CLD 12-0106 MODEL: L02

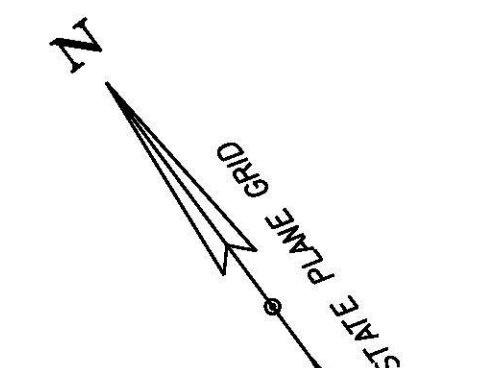
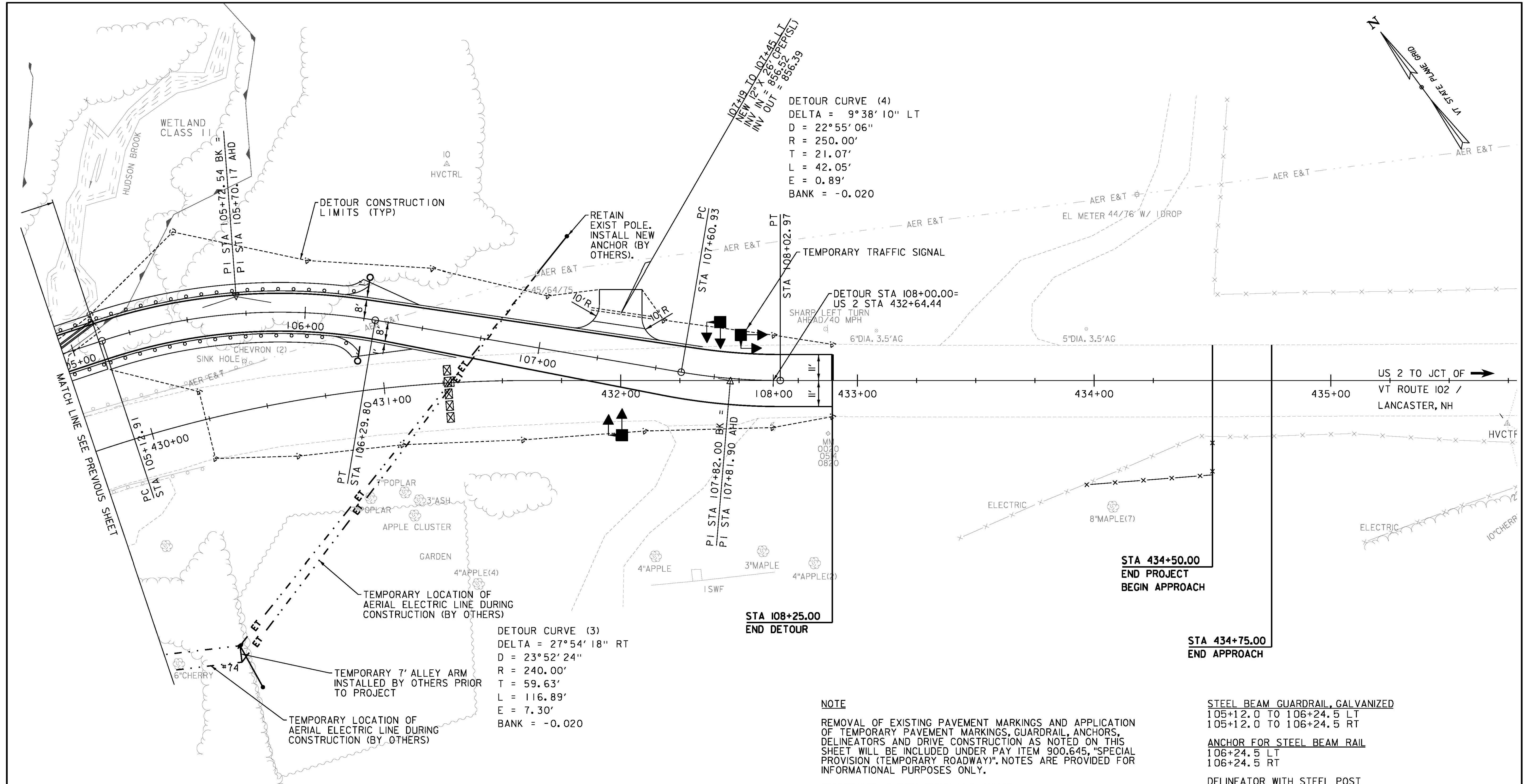

DETOUR CURVE (4)
 DELTA = 9°38'10" LT
 D = 22°55'06"
 R = 250.00'
 T = 21.07'
 L = 42.05'
 E = 0.89'
 BANK = -0.020

DETOUR CURVE (3)
 DELTA = 27°54'18" RT
 D = 23°52'24"
 R = 240.00'
 T = 59.63'
 L = 116.89'
 E = 7.30'
 BANK = -0.020

NOTE

REMOVAL OF EXISTING PAVEMENT MARKINGS AND APPLICATION OF TEMPORARY PAVEMENT MARKINGS, GUARDRAIL, ANCHORS, DELINEATORS AND DRIVE CONSTRUCTION AS NOTED ON THIS SHEET WILL BE INCLUDED UNDER PAY ITEM 900.645, "SPECIAL PROVISION (TEMPORARY ROADWAY)". NOTES ARE PROVIDED FOR INFORMATIONAL PURPOSES ONLY.

TEMPORARY 4 INCH WHITE LINE, PAINT
 104+96 TO 108+25 SOLID LT & RT

TEMPORARY 24 INCH STOP BAR, PAINT
 108+25 LT

STEEL BEAM GUARDRAIL, GALVANIZED

105+12.0 TO 106+24.5 LT
 105+12.0 TO 106+24.5 RT

ANCHOR FOR STEEL BEAM RAIL

106+24.5 LT
 106+24.5 RT

DELINEATOR WITH STEEL POST

106+24.5 LT
 106+24.5 RT

CONSTRUCT DRIVES WITH 4 FOOT PAVED APRON
 107+33.1 LT (18.0 FT WIDE, GRAVEL, FIELD)

LEGEND

- N/C NEW SIGN/CONSTRUCTION ONLY
- B/W BLACK/WHITE
- ☒ TYPE III BARRICADE
- ☒ TYPE III BARRICADE (MOD.)
- ▬ TEMPORARY TRAFFIC BARRIER
- ⊗ ENERGY ABSORPTION ATTENUATOR



R11-2 B/W SIGN MOUNTED ON TYPE III BARRICADE (MODIFIED)

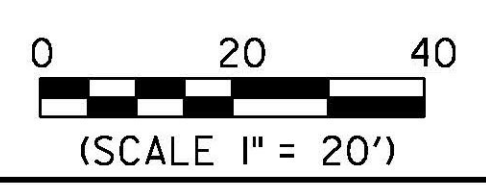

PROJECT NAME: LUNENBURG	
PROJECT NUMBER: NH CULV(27)	
FILE NAME: 11b294/cos/211b294bdr+cppl.dgn	PLOT DATE: 8/24/2015
PROJECT LEADER: J. BYATT	DRAWN BY: M. HALEY
DESIGNED BY: M. HALEY	CHECKED BY: P. SHEDD
PHASE I TRAFFIC CONTROL SHEET 2	SHEET 23 OF 74