

MAINTENANCE OF TRAFFIC SECTIONS - PHASE 2

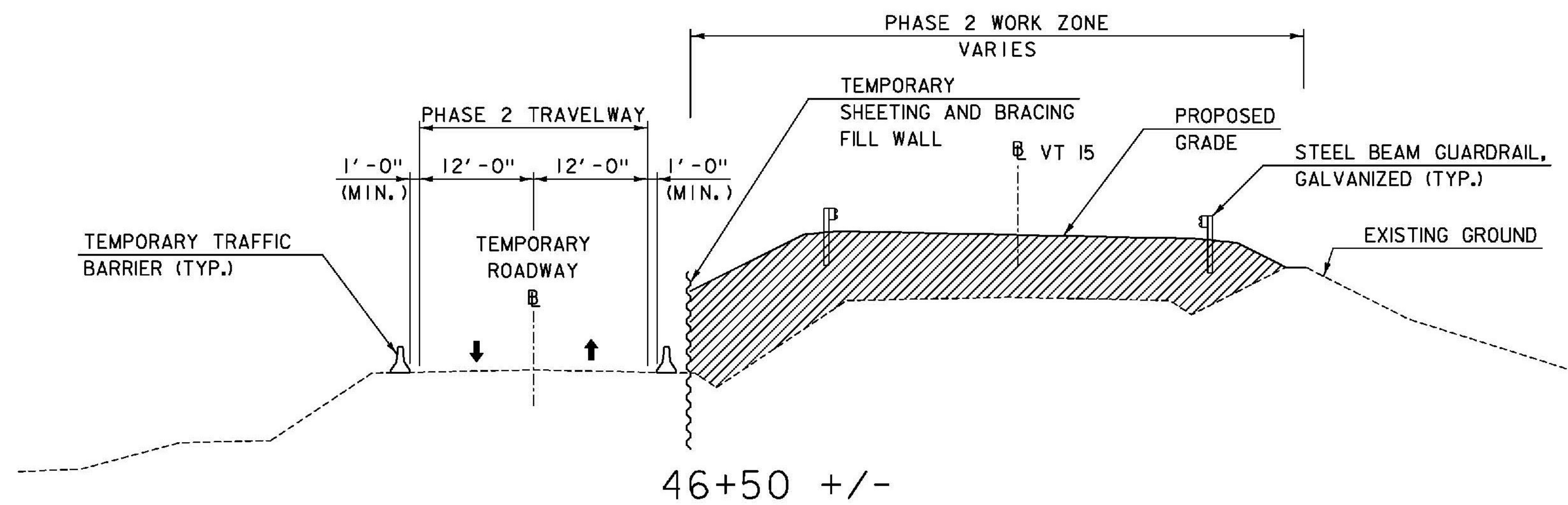

PROPOSED TRAFFIC CONTROL PLAN NOTES - PHASE 2

PLACE TEMPORARY SHEETING AND BRACING AND BARRIERS AT LOCATIONS SHOWN TO CREATE A TWO-WAY TEMPORARY ROADWAY. DIRECT ALL TRAFFIC ON TO THIS ROADWAY. SEE SPECIAL PROVISION 900.645 FOR DETAILS REGARDING TEMPORARY ROADWAY PAY ITEM.

WITH TRAFFIC MAINTAINED ON TEMPORARY ROADWAY, EXCAVATE WEST SIDE OF CHANNEL, REMOVE WEST END OF EXISTING CMPP, CONSTRUCT WEST END OF NEW CHANNEL AND CONSTRUCT APPROACH AND NEW BRIDGE ON FINAL ALIGNMENT.

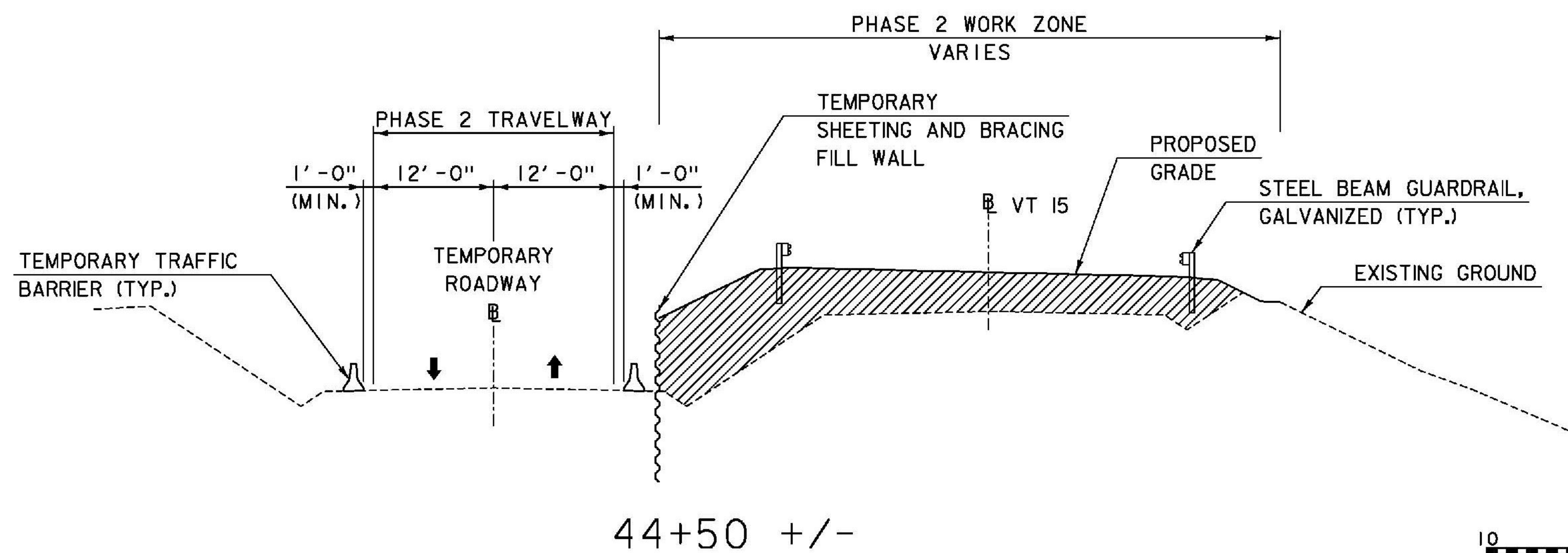
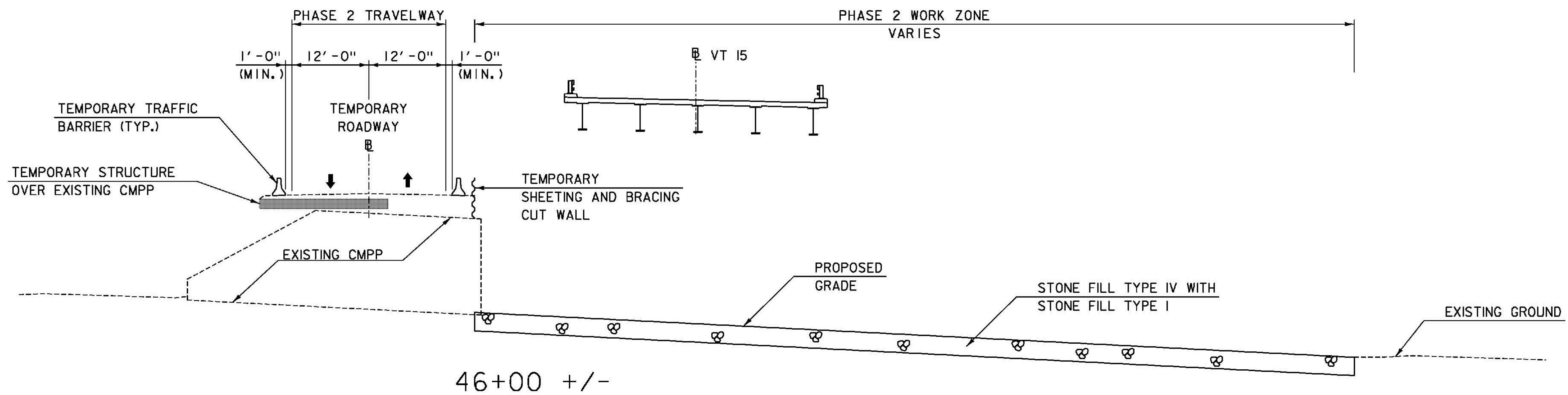

NOTE:
FOR ADDITIONAL INFORMATION SEE MAINTENANCE OF TRAFFIC PLANS AND PROFILE SHEETS.

LEGEND

AREA OF FINAL BUILD

10 0 10
SCALE IN FEET

TYLIN INTERNATIONAL

PROJECT NAME: HYDE PARK
PROJECT NUMBER: STP CULV(26)

FILE NAME: zllb292bdr_mot_CON.dgn PLOT DATE: 11/6/2013
PROJECT LEADER: R. HEBERT DRAWN BY: T. KELLEY
DESIGNED BY: T. KELLEY CHECKED BY: D. BRYANT
MAINTENANCE OF TRAFFIC SECTIONS, PHASE 2 SHEET 20 OF 60