

621.20 - STEEL BEAM GUARDRAIL, GALVANIZED
 STA. 31+50.30, LT. TO STA. 31+75.30, LT.
 STA. 32+00.00, RT. TO STA. 32+25.00, RT.
 STA. 34+50.00, RT. TO STA. 34+75.00, RT.
 STA. 35+50.30, LT. TO STA. 35+75.30, LT.

621.205 - STEEL BEAM GUARDRAIL, GALVANIZED W/8 FEET POSTS
 STA. 31+75.30, LT. TO STA. 35+50.30, LT.
 STA. 32+25.00, RT. TO STA. 34+50.00, RT.

621.60 - ANCHOR FOR STEEL BEAM RAIL
 STA. 31+56.30, LT.
 STA. 32+06.00, RT.
 STA. 34+66.00, RT.
 STA. 35+69.30, LT.

621.80 - REMOVAL AND DISPOSAL OF GUARDRAIL
 STA. 31+53.09, LT. TO STA. 35+77.30, LT.
 STA. 32+37.63, RT. TO STA. 34+72.78, RT.

646.400 - DURABLE 4 INCH WHITE LINE
 STA. 31+75.00, RT. TO STA. 35+05.00, RT.
 STA. 31+75.00, LT. TO STA. 35+05.00, LT.
 646.410 - DURABLE 4 INCH YELLOW LINE
 STA. 31+75.00, CL. TO STA. 35+05.05, CL. (DYCL)

CURVE DATA
 PC = 30+00.00
 Δ = 15°28'59.44"
 D = 2°42'09.47"
 R = 2120.00'
 T = 288.20'
 L = 572.89'
 E = 19.50'

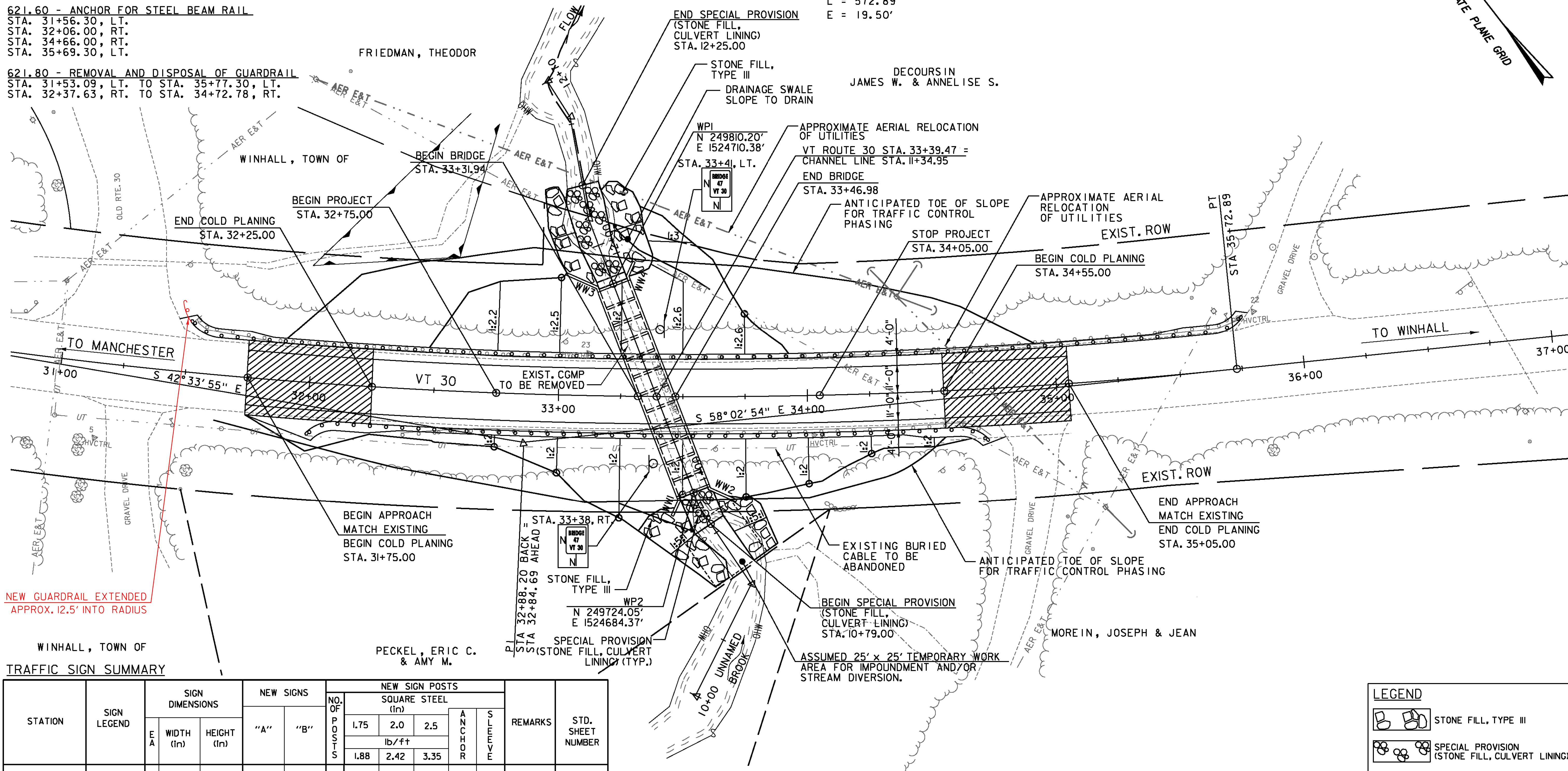
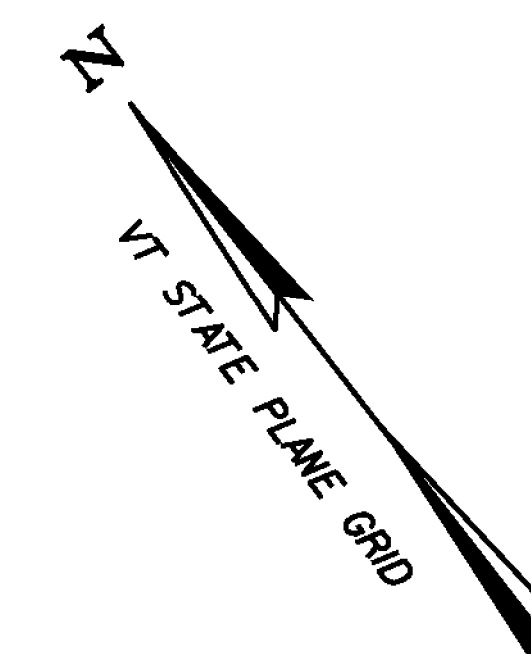

NEW GUARDRAIL EXTENDED
 APPROX. 12.5' INTO RADIUS

WINHALL, TOWN OF
 TRAFFIC SIGN SUMMARY

STATION	SIGN LEGEND	SIGN DIMENSIONS		NEW SIGNS		NO. OF POSTS	NEW SIGN POSTS			REMARKS	STD. SHEET NUMBER	
		E	WIDTH (in)	HEIGHT (in)	"A"		"B"	SQUARE STEEL (in)				
								1.75	2.0			2.5
33+38, RT		1	6	8	0.33	1	X		X	VR-701	T-42	
33+41, LT		1	6	8	0.33	1	X		X	VR-701	T-42	
TOTALS				SF	SF			FT				
				0.66				30				

FINAL POST LENGTHS ARE TO BE DETERMINED IN THE FIELD. POST SIZES ARE COMPUTED BASED ON INFORMATION FURNISHED ON THE STANDARD SHEETS AND THE VTRANS "SIGN POST DESIGN GUIDELINE."

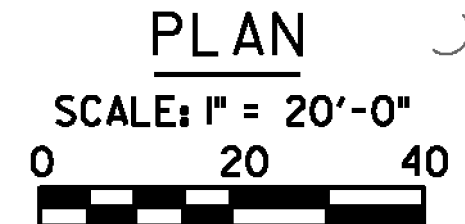

LEGEND

	STONE FILL, TYPE III
	SPECIAL PROVISION (STONE FILL, CULVERT LINING)

NOTE: GRADE IN ACCORDANCE WITH THE TYPICAL ROADWAY SECTION AND ROADWAY CROSS SECTIONS UNLESS NOTED OTHERWISE.

PROJECT NAME: WINHALL
 PROJECT NUMBER: STP CULV(31)
 FILE NAME: z11b268bdr_br47.dgn
 PROJECT LEADER: M. CHENETTE
 DESIGNED BY: J. HUNGERFORD
 PLAN LAYOUT SHEET - BR47
 PLOT DATE: 10/9/2014
 DRAWN BY: L. BUXTON
 CHECKED BY: M. CHENETTE
 SHEET 14 OF 60

