

Volume: ±16.78 CY  
Weight: ±67,103 lbs

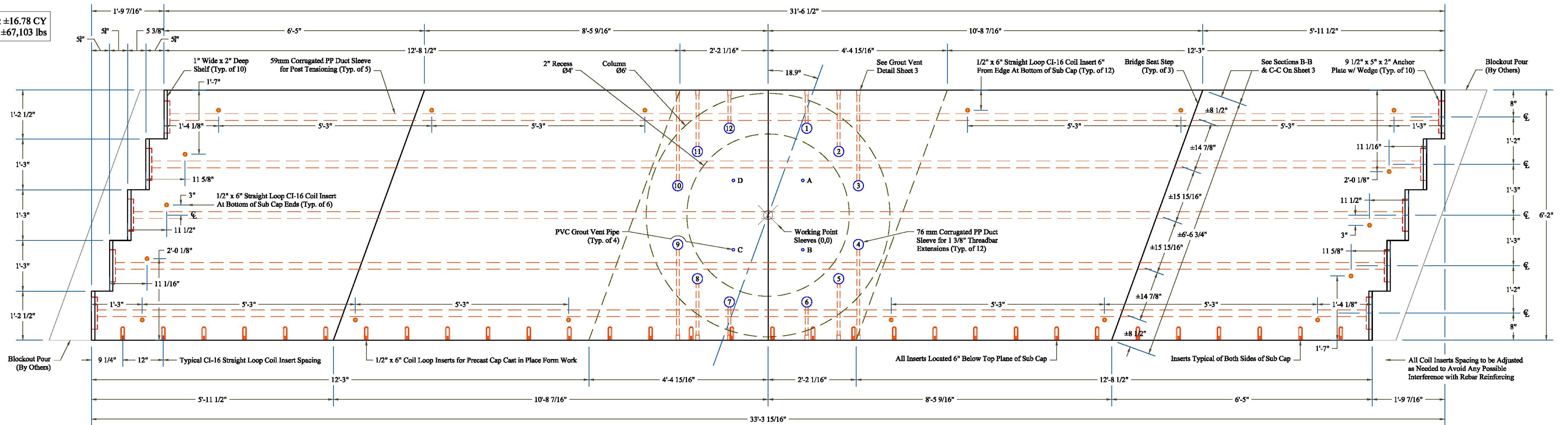

Plan View

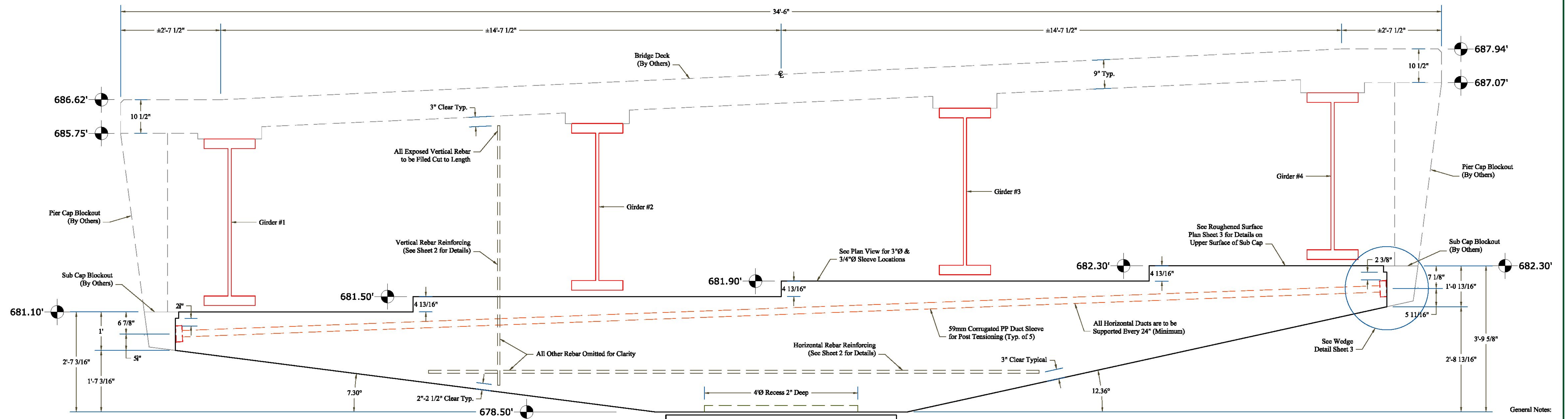

Sleeve Legend & Coordinates

Mark	Ø	X	Y	Mark	Ø	X	Y	Mark	Ø	X	Y
1	3"	11 7/16"	2'-1 11/16"	7	3"	-11 7/16"	-2'-1 11/16"	A	3/4"	10 1/4"	10 1/4"
2	3"	1'-8 7/8"	1'-6 13/16"	8	3"	-1'-8 7/8"	-1'-6 13/16"	B	3/4"	10 1/4"	-10 1/4"
3	3"	2'-2 11/16"	8 11/16"	9	3"	-2'-2 11/16"	-8 11/16"	C	3/4"	-10 1/4"	-10 1/4"
4	3"	2'-2 11/16"	-8 11/16"	10	3"	-2'-2 11/16"	8 11/16"	D	3/4"	-10 1/4"	10 1/4"
5	3"	1'-8 7/8"	-1'-6 13/16"	11	3"	-1'-8 7/8"	1'-6 13/16"				
6	3"	11 7/16"	-2'-1 11/16"	12	3"	-11 7/16"	2'-1 11/16"				

Elevation View at CL

Vermont Agency of Transportation  
**RECEIVED**

CK'D BY VHB OK'D BY JTS

April 29, 2013

RESUBMIT NO Approved  
BY KMH DATE 05/13/13



- Concrete Shall Have a Minimum 28 Days Compressive Strength of 6,000 PSI SCC Mix
- All Reinforcing Rebar to be Level II Bar that is Dual Coated by the Manufacturer
- All Horizontal Ducts (59mm PP Ducts) are to be Supported Every 24" (Minimum)
- Post Tensioning Details Based on Post Tensioning Contractors Submittal Dated 03-22-13 Revised

PROJECT NAME: JAMAICA	
PROJECT NUMBER: ER-BRF 013-1(16)	
PRECAST SUB-CAP PRODUCTION DRAWING SET	
DRAWING: PLAN LAYOUT & ELEVATION VIEW	
DRAWN BY: CD	DATE: 04/11/13
APPROVED BY: TD	SHEET: 1 OF 4