

**BEMIS,
MARTIN N. & CAROL ANN**

**TOWN
OF
JAMAICA**

50D COLTON LOAMY FINE SAND
WITH 15% TO 25% SLOPES
"K FACTOR" = 0.17

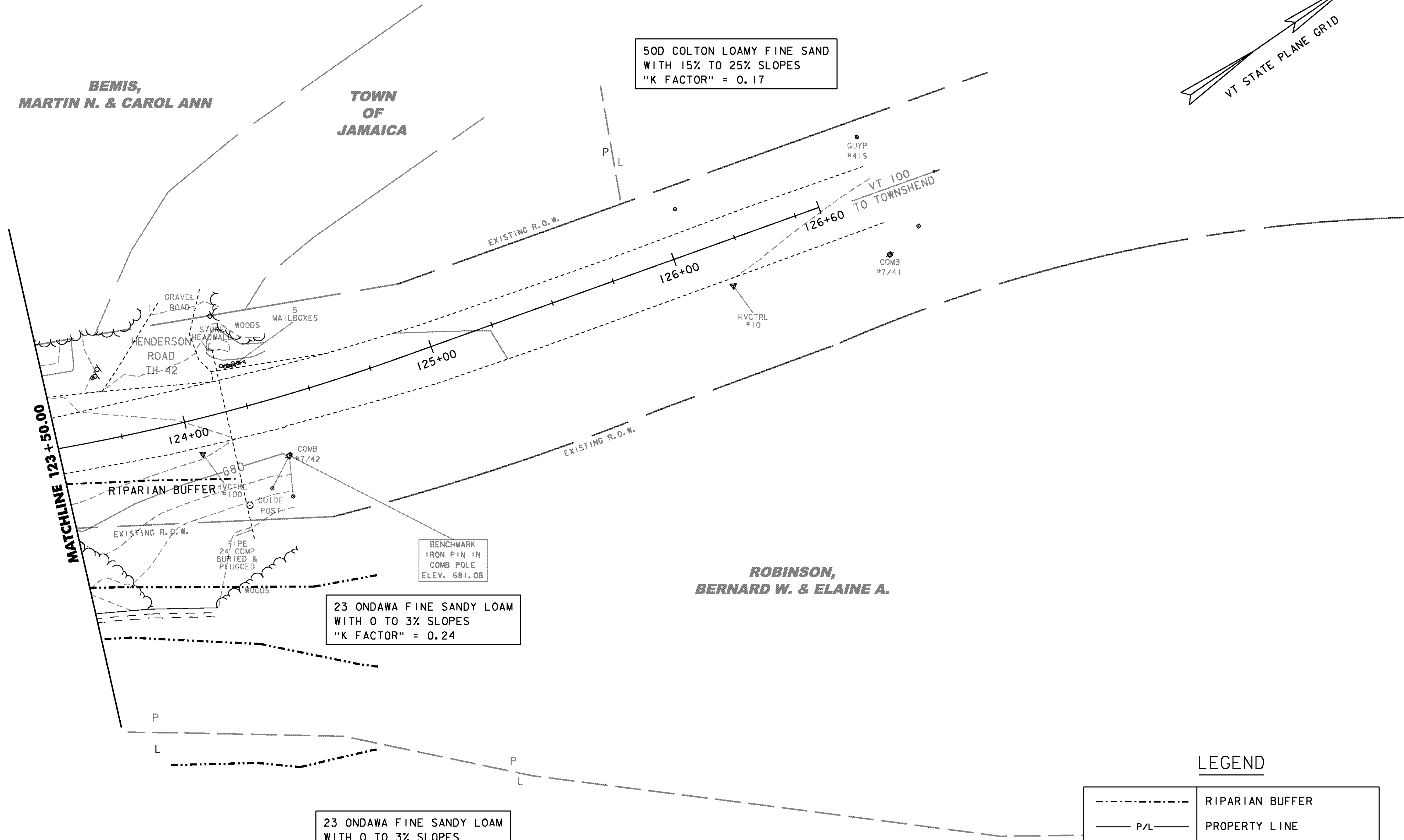

**ROBINSON,
BERNARD W. & ELAINE A.**

23 ONDAWA FINE SANDY LOAM
WITH 0 TO 3% SLOPES
"K FACTOR" = 0.24

BENCHMARK
IRON PIN IN
COMB POLE
ELEV. 681.08

23 ONDAWA FINE SANDY LOAM
WITH 0 TO 3% SLOPES
"K FACTOR" = 0.24

GRECO, MICHAEL

LEGEND

-----	RIPARIAN BUFFER
— P/L —	PROPERTY LINE
— — —	RIGHT-OF-WAY LINE
-----	SOIL BOUNDARY

EXISTING CONDITIONS SHEET 3

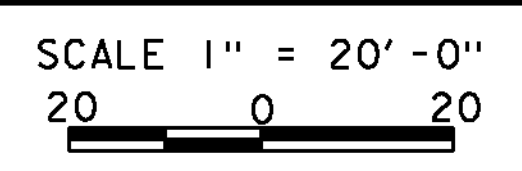

PROJECT NAME: JAMAICA	PLOT DATE: 12-OCT-2012
PROJECT NUMBER: ER-BRF 013-1(16)	DRAWN BY: K. FRIEDLAND
FILE NAME: s1b212ero.ex.dgn	CHECKED BY: G. LAROCHE
PROJECT LEADER: K. HIGGINS	SHEET 49 OF 85
DESIGNED BY: G. LAROCHE	
EXISTING CONDITIONS SHEET 3	