

V	T	1	0	5	
C	L	O	S	E	D

PORTABLE CHANGEABLE SIGN - PHASE 1

W	E	S	T	O	F
I	S	L	A	N	D
P	O	N	D		

PORTABLE CHANGEABLE SIGN - PHASE 2

*	M	M	M		D	D	-
*	M	M	M		D	D	

PORTABLE CHANGEABLE SIGN - PHASE 3

* M=MONTH
D=DAY

(S)

NOTES:

1. THE PORTABLE CHANGEABLE MESSAGE SIGNS SHALL BE FULLY OPERATIONAL A MINIMUM OF TWO WEEKS PRIOR TO THE CLOSURE OF VT 105.
2. DURING ACTUAL CLOSURE, ELIMINATE PHASE 3 ONLY.
3. DETOUR SIGNS SHALL BE LOCATED ADJACENT TO EXISTING INTERSECTION ROUTE MARKER ASSEMBLIES WHERE APPLICABLE.
4. DETOUR SIGNING IS THE RESPONSIBILITY OF THE CONTRACTOR. PAYMENT FOR ALL TEMPORARY TRAFFIC CONTROL DEVICES FOR IMPLEMENTING THE DETOUR, INCLUDING BUT NOT LIMITED TO SIGNS, BARRICADES AND MESSAGE BOARDS, WILL BE INCLUDED IN THE UNIT PRICE BID FOR CONTRACT ITEM 900.645 SPECIAL PROVISION (TRAFFIC CONTROL, ALL-INCLUSIVE).
5. THIS DETOUR PLAN IS AN OUTLINE ONLY AND THE CONTRACTOR SHALL SUBMIT A DETAILED PLAN OF EACH INTERSECTION SHOWING DETOUR SIGN LOCATIONS IN RELATION TO EXISTING SIGNS.

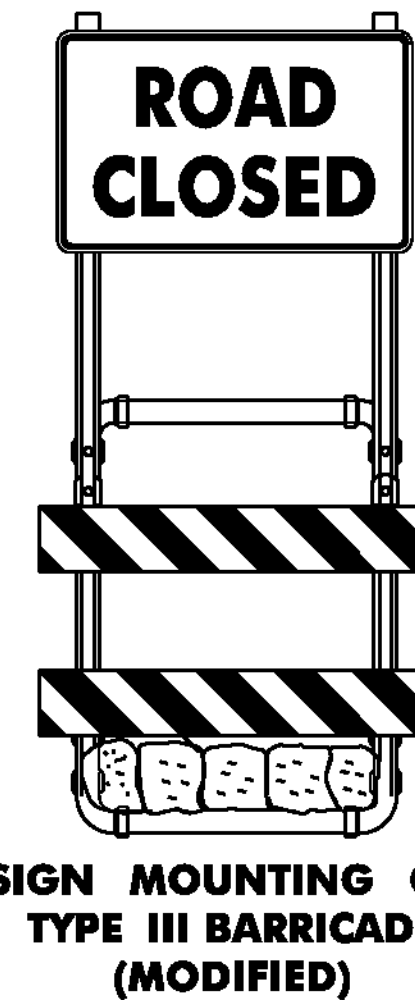

(A)

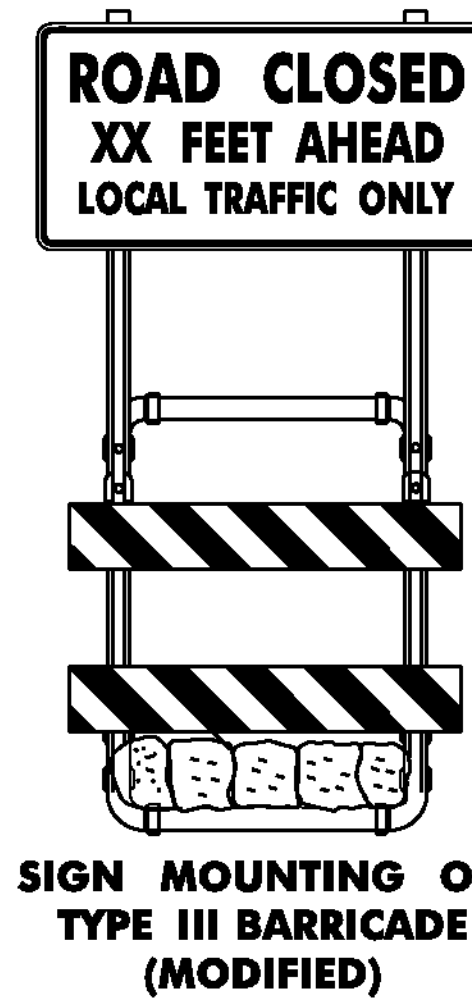

(B)

**E= EAST
OR
W= WEST

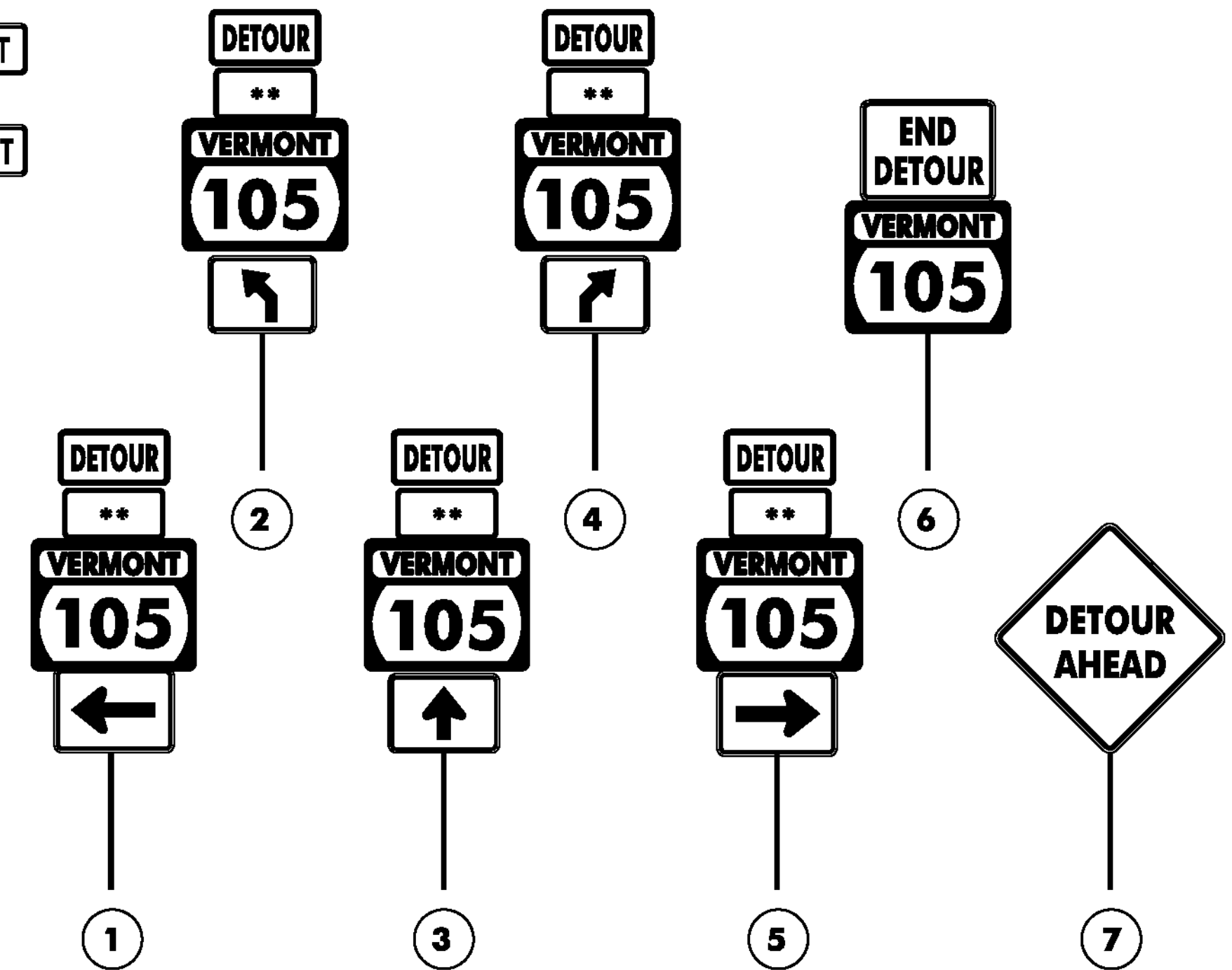

ROAD CLOSED
XX MILES AHEAD
LOCAL TRAFFIC ONLY

(10)

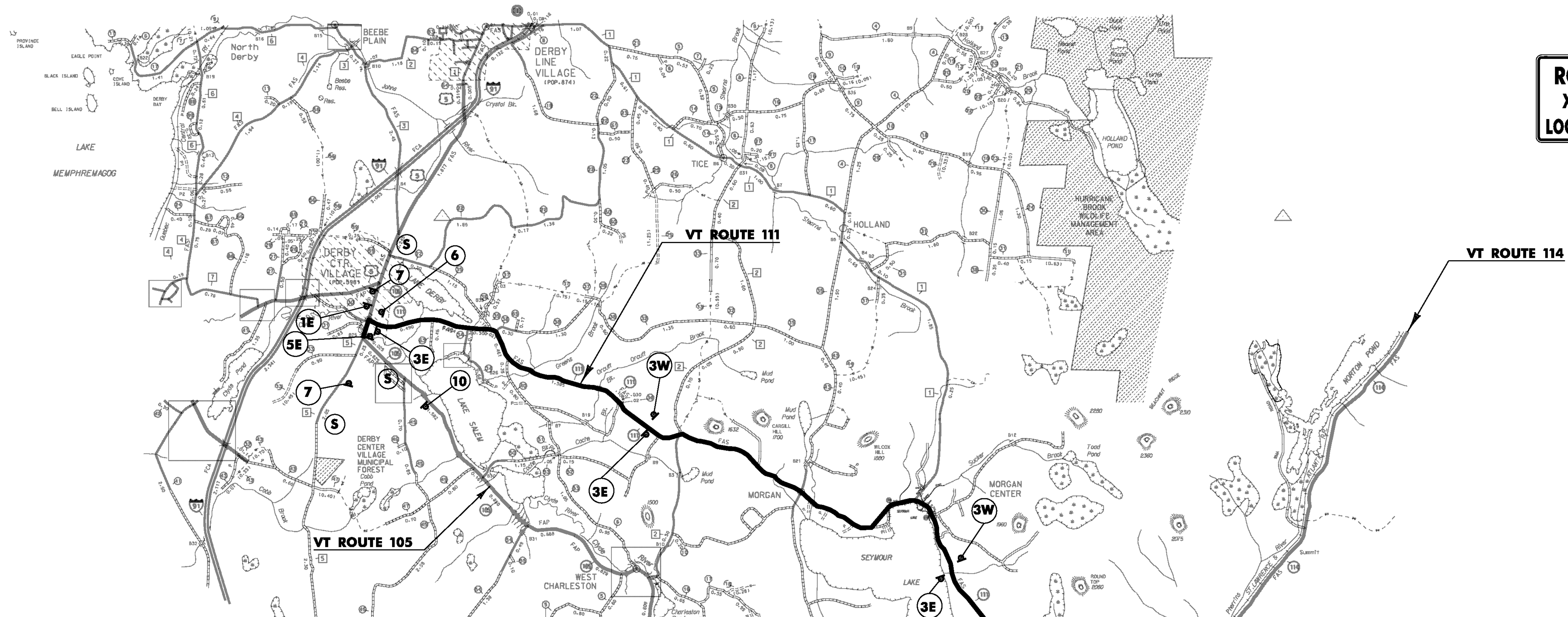

MATCHLINE

DETOUR PLAN - I

NOT TO SCALE

PROJECT NAME: BRIGHTON
PROJECT NUMBER: ER STP 034-3 (25)

FILE NAME: slb208detour.dgn
PROJECT LEADER: K. HIGGINS
DESIGNED BY: J. SALVATORI
DETOUR PLAN I

PLOT DATE: 12-SEP-2012
DRAWN BY: K. FRIEDLAND
CHECKED BY: W. LAMMER
SHEET 23 OF 36