

621.75 - REMOVE AND RESET GUARDRAIL
RAMP A STA 222+50 RT TO RAMP A STA 225+50 RT

MONTPELIER JUNCTION ROAD

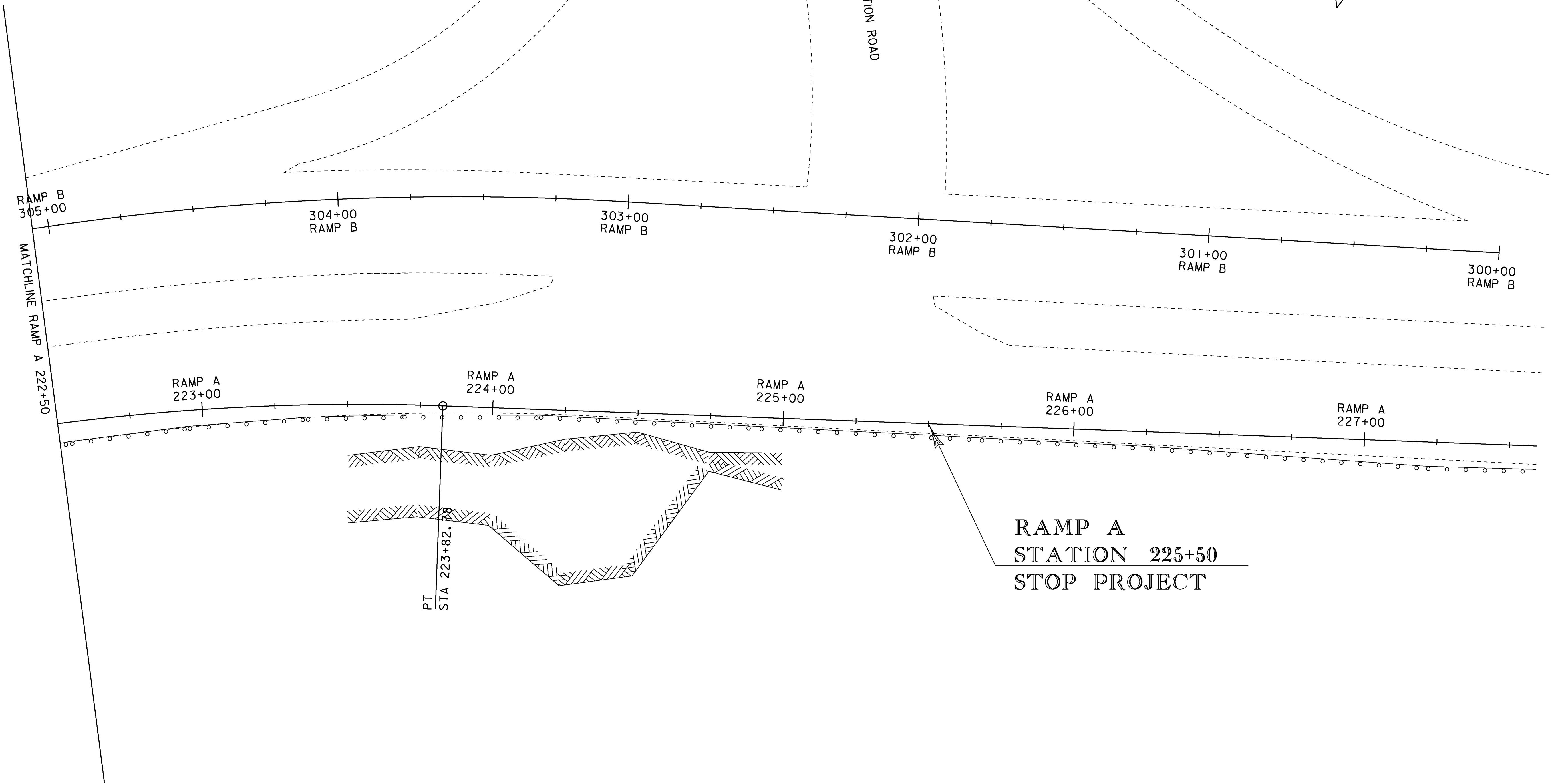

RAMP B
305+00
MATCHLINE RAMP A 222+50

304+00
RAMP B

303+00
RAMP B

302+00
RAMP B

301+00
RAMP B

300+00
RAMP B

RAMP A
223+00

RAMP A
224+00

RAMP A
225+00

RAMP A
226+00

RAMP A
227+00

PT.
STA 223+82.78

RAMP A
STATION 225+50
STOP PROJECT

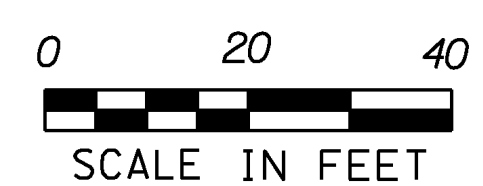

PROJECT NAME:	MONTPELIER	PLOT DATE:	24-MAY-2013
PROJECT NUMBER:	NH 028-2(9)	DRAWN BY:	P. PELOQUIN
FILE NAME:	lib066\Design\dlb066bdra.dgn	CHECKED BY:	A. BOMBARDIER
PROJECT LEADER:	P. PELOQUIN	LAYOUT SHEET	5
DESIGNED BY:	P. PELOQUIN	SHEET	II OF 62