

103+75

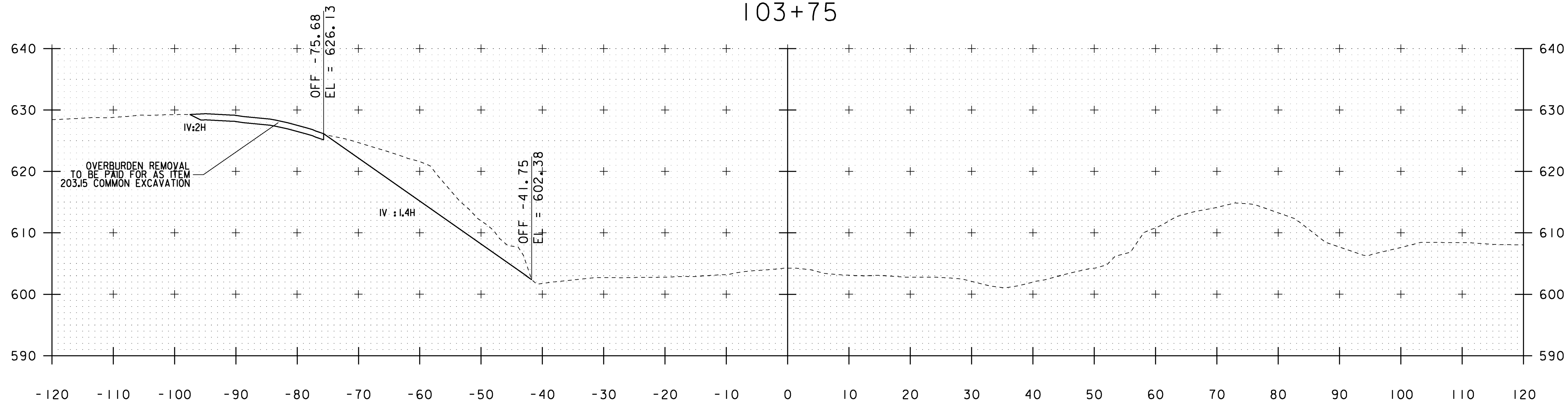

103+50

MONTPELIER STATE HIGHWAY

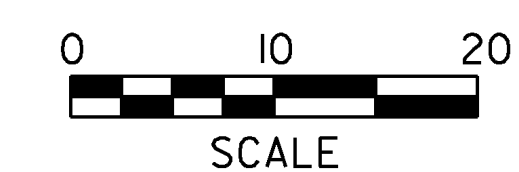

STA. 103+50 TO STA. 103+75

| | |
|--|---------------------------|
| PROJECT NAME: MONTPELIER | PLOT DATE: 24-MAY-2013 |
| PROJECT NUMBER: NH 028-2(9) | DRAWN BY: P. PELOQUIN |
| FILE NAME: I:\b066\Design\dlb066xs.dgn | CHECKED BY: A. BOMBARDIER |
| PROJECT LEADER: P. PELOQUIN | SHEET 23 OF 62 |
| DESIGNED BY: P. PELOQUIN | |
| CROSS SECTION SHEET 5 | |