

621.75 - REMOVE AND RESET GUARDRAIL  
 RAMP A STA 217+25 RT TO RAMP A STA 222+50 RT

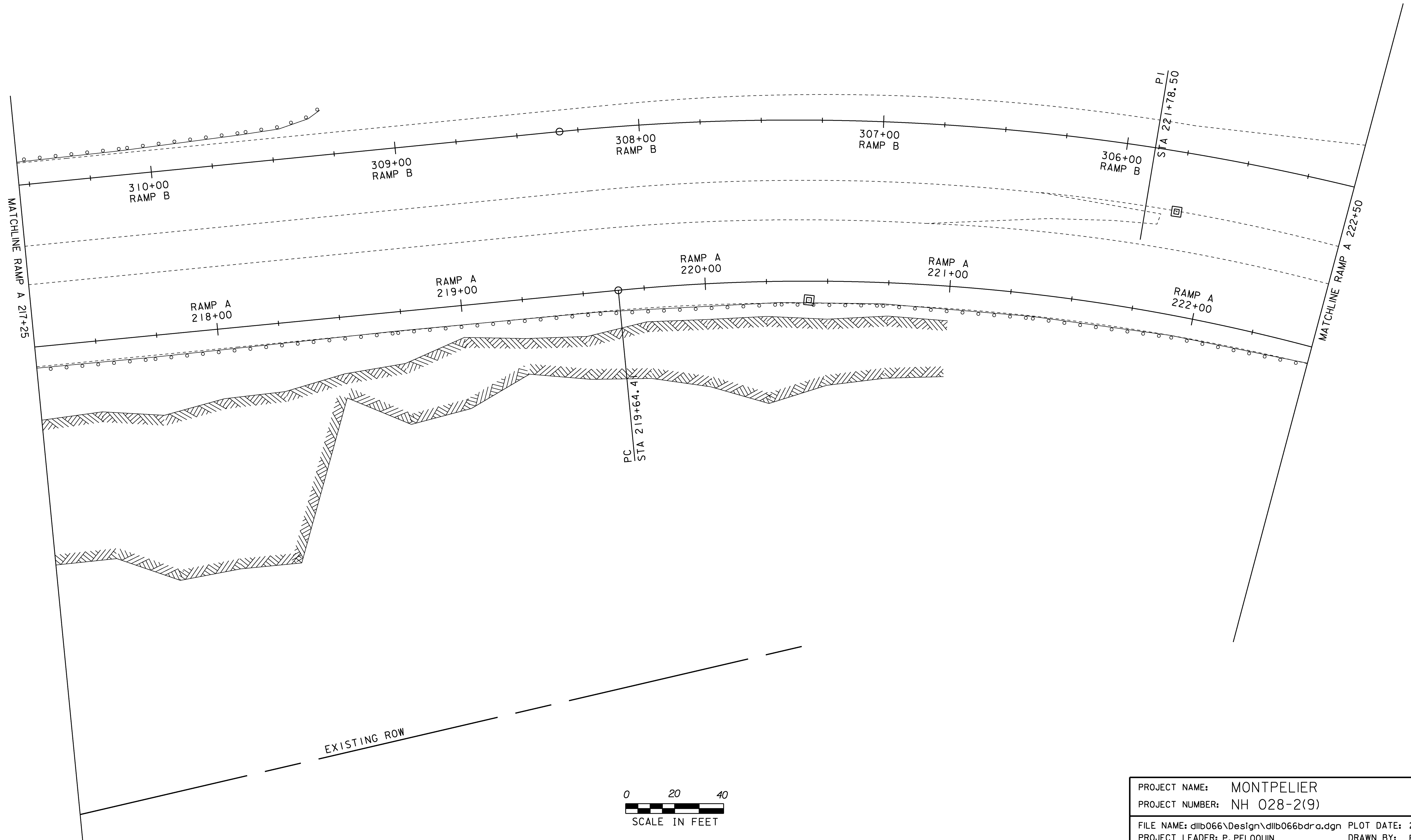
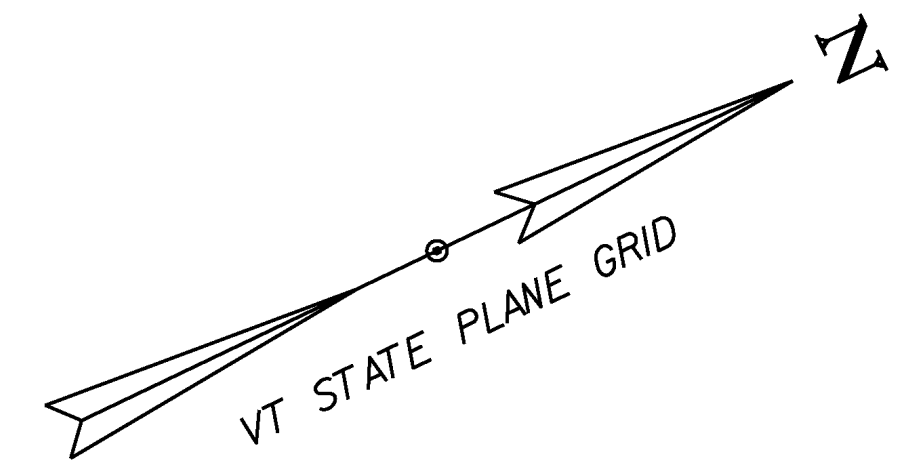

PROJECT NAME:	MONTPELIER	PLOT DATE:	24-MAY-2013
PROJECT NUMBER:	NH 028-2(9)	DRAWN BY:	P. PELOQUIN
FILE NAME:	d:\b066\Design\d\l\b066bdra.dgn	CHECKED BY:	A. BOMBARDIER
PROJECT LEADER:	P. PELOQUIN	LAYOUT SHEET	4
DESIGNED BY:	P. PELOQUIN	SHEET	10 OF 62