

STEEL BEAM GUARDRAIL, GALVANIZED  
STA 280+25 - 283+25 LT

YIELDING MARKER POST  
STA 282+70 RT

SPECIAL PROVISION (REINFORCED SOIL SLOPE)  
STA 280+25 - 283+13 LT

ANCHOR FOR STEEL BEAM RAIL  
STA 283+12 LT

REMOVAL OF EXISTING FENCE  
STA 280+25 - 280+87 RT

REMOVING LARGE STUMPS  
STA 281+50 RT - STA 282+50 RT

AGGREGATE SHOULDER  
STA 280+25 LT - STA 284+25 LT  
STA 280+25 RT - STA 282+72 RT

STONE FILL, TYPE II  
STA 280+25 LT - STA 283+25 LT  
STA 280+25 RT - STA 282+73 RT

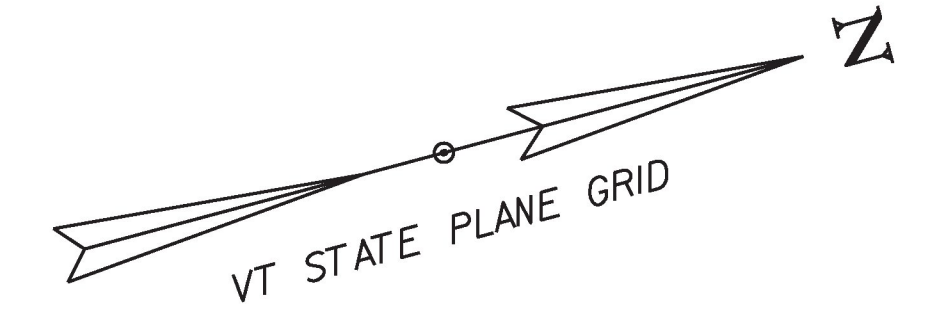

CURVE (2)  
DELTA = 3° 13' 33"  
D = 4° 05' 33"  
R = 1400.00'  
T = 39.42'  
L = 78.82'  
E = 0.55'  
BANK = 0.020 @ 50 MPH

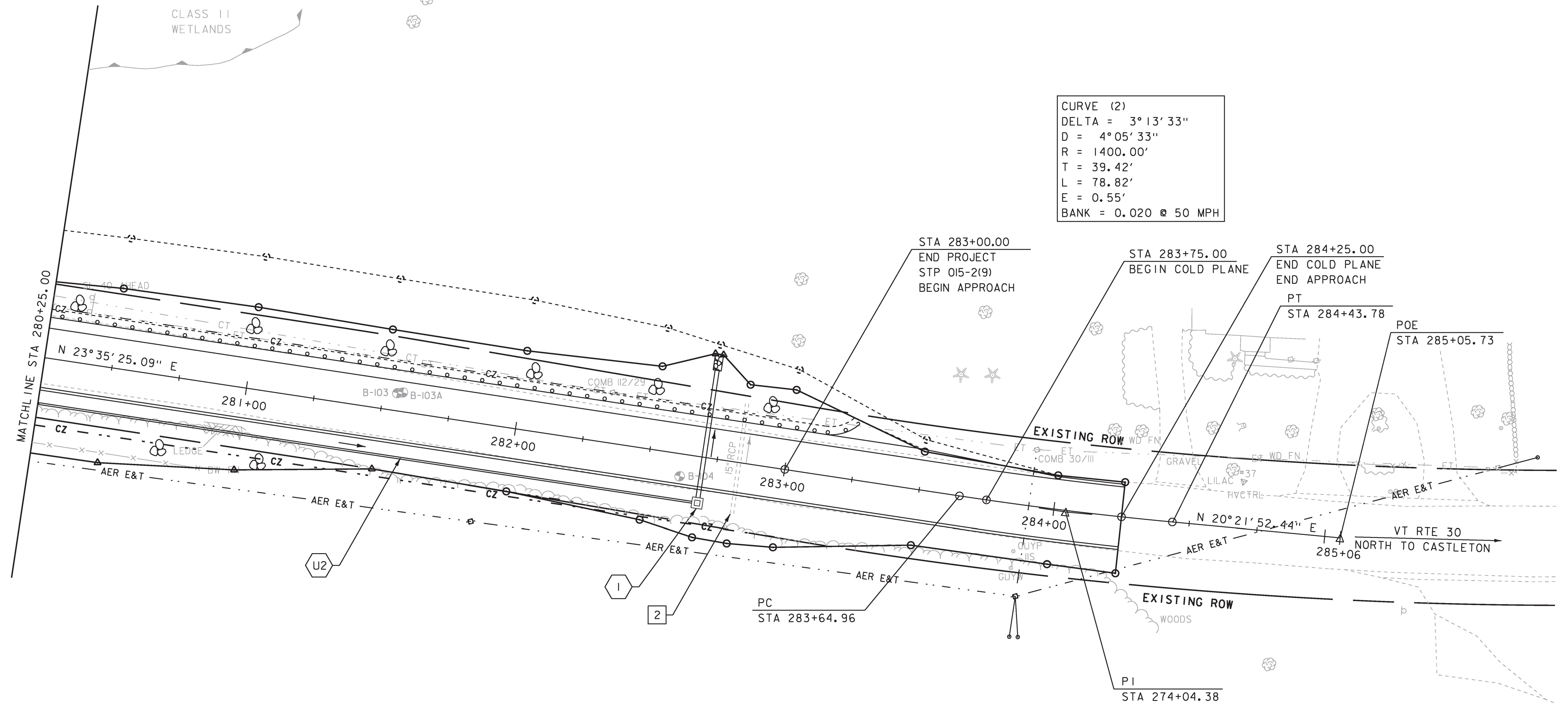

EXISTING DRAINAGE  
2 STA 282+83 C/L  
REMOVE EXISTING 15" RCP

NEW DRAINAGE  
I STA 282+70 C/L  
NEW 18" X 48' CPEP PIPE WITH  
NEW PRCCB W/GRATE TYPE B AT STA  
282+70 RT STONE FILL, TYPE II  
PAD AT OUTLET (L=6', W=3', D=2')

8-INCH UNDERDRAIN  
U2 STA 280+25 - 282+70 RT  
NEW 8" X 245' UNDERDRAIN  
W/FLUSHING BASIN AT 280+25 RT



PROJECT NAME: POULTNEY	PLOT DATE: 23-AUG-2018
PROJECT NUMBER: STP 015-2(9)	DRAWN BY: S. ZWICK
FILE NAME: d11b048bdr	CHECKED BY: C. LEACH
PROJECT LEADER: K. UPMAL	SHEET 20 OF 48
DESIGNED BY: S. ZWICK	
LAYOUT PLAN SHEET 2	