

STEEL BEAM GUARDRAIL, GALVANIZED
STA 277+87.5 - 280+25 LT

ANCHOR FOR STEEL BEAM RAIL
STA 278+00 LT

AGGREGATE SHOULDER
STA 277+00 LT - STA 280+25 LT
STA 277+00 RT - STA 280+25 RT

YIELDING MARKER POST
STA 277+25 RT
STA 280+25 RT

REMOVAL OF EXISTING FENCE
STA 276+75 - 280+25 RT

STONE FILL, TYPE II
STA 277+00 RT - STA 278+00 RT
STA 278+00 LT - STA 280+25 LT
STA 279+50 RT - STA 280+25 RT

CONSTRUCT PAVED DRIVE
STA 277+43 LT, 12' W & 22' L

SPECIAL PROVISION (REINFORCED SOIL SLOPE)
STA 278+00 - 280+25 LT

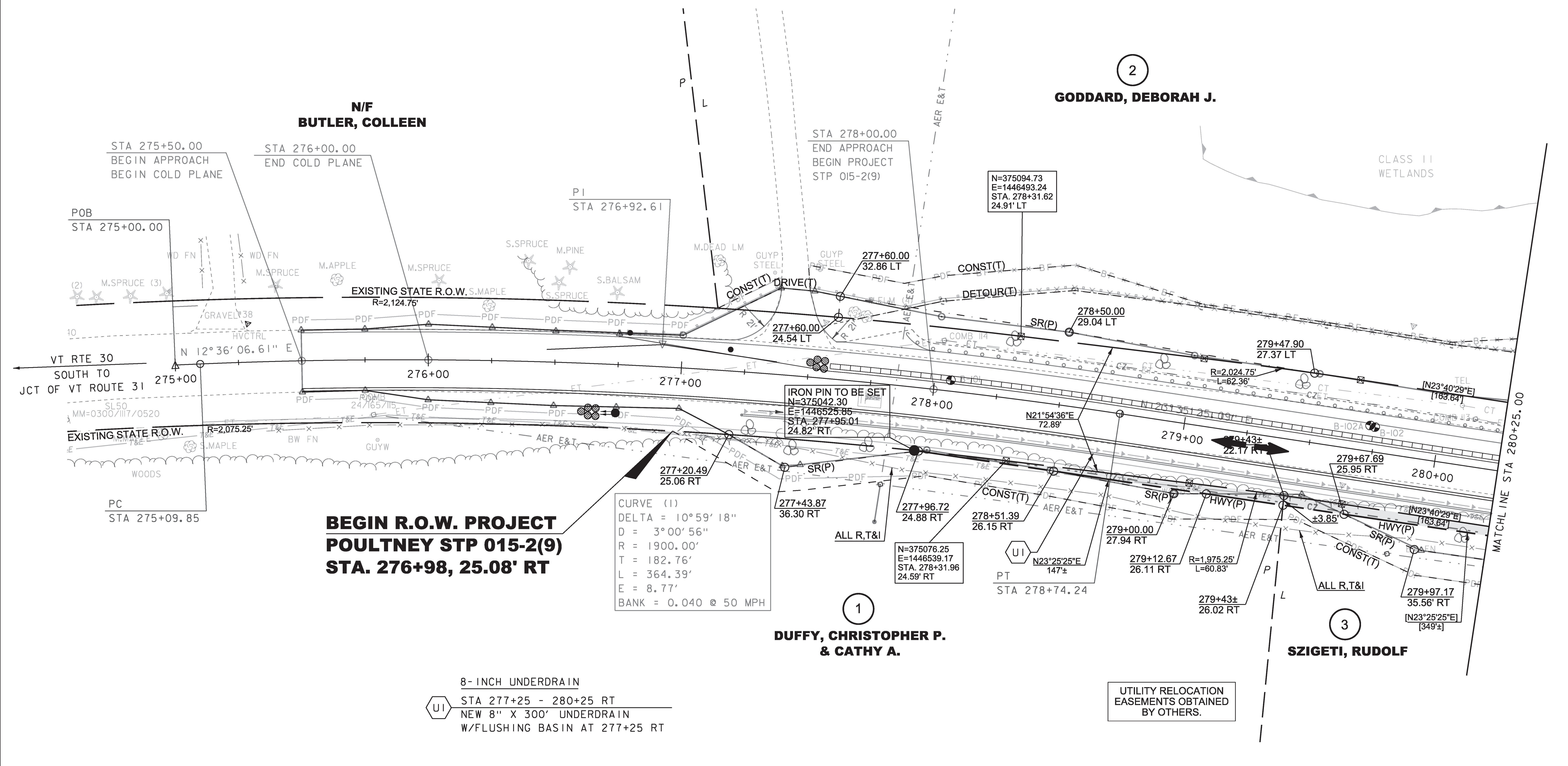
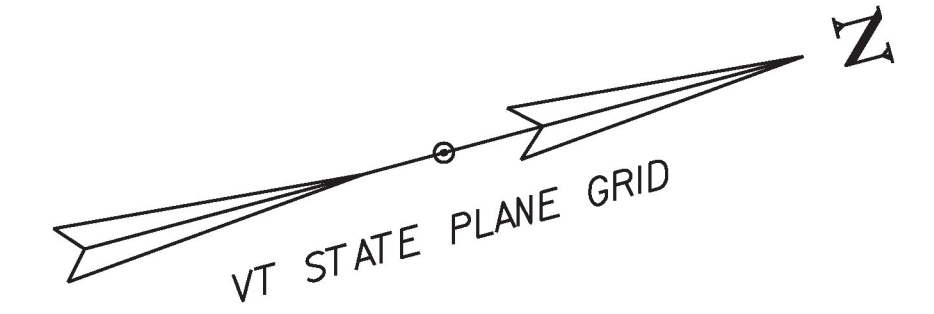

LINES SHOWN ON THIS PLAN AS EXISTING PROPERTY LINES P/L ARE BELIEVED TO BE ACCURATE BUT SHOULD NOT BE RELIED UPON FOR PURPOSES UNRELATED TO THE STATE OF VERMONT'S ACQUISITION OF LAND AND RIGHTS FOR THIS PROJECT.

FOR R.O.W. USE ONLY



| | | | |
|-----------------|-----------------|----------------------------|----------------|
| PROJECT NAME: | POULTNEY | PLOT DATE: | 23-AUG-2018 |
| PROJECT NUMBER: | STP 015-2(9) | DRAWN BY: | A. PROULX |
| FILE NAME: | r11b048lay1.dgn | CHECKED BY: | R. CLOUTIER |
| DESIGNED BY: | S. ZWICK | R.O.W. LAYOUT SHEET 1 OF 2 | SHEET 17 OF 48 |