

6 INCH WHITE LINE
 STA. 0+22 RT ~ 3+58 RT (SOLID)(EDGE LINE)
 STA. 0+52 RT ~ 3+08 RT (DOTTED)
 STA. 4+67 RT ~ 12+85 RT (SOLID)(EDGE LINE)
 STA. 0+77 LT ~ 6+96 LT (SOLID)(EDGE LINE)
 STA. 7+23 LT ~ 12+85 LT (SOLID)(EDGE LINE)

6 INCH YELLOW LINE
 STA. 0+36 LT ~ 12+85 LT (SOLID)(EDGE LINE)
 STA. 0+68 LT ~ 1+41 LT (SOLID)(EDGE LINE)
 STA. 0+36 RT ~ 12+85 RT (SOLID)(EDGE LINE)

TEMPORARY 6 INCH WHITE LINE
 STA. 0+22 RT ~ 3+58 RT (SOLID)(EDGE LINE)
 STA. 0+52 RT ~ 3+08 RT (DOTTED)
 STA. 4+67 RT ~ 12+85 RT (SOLID)(EDGE LINE)
 STA. 0+77 LT ~ 6+96 LT (SOLID)(EDGE LINE)
 STA. 7+23 LT ~ 12+85 LT (SOLID)(EDGE LINE)

TEMPORARY 6 INCH YELLOW LINE
 STA. 0+00 LT ~ 12+85 LT (SOLID)(EDGE LINE)
 STA. 0+68 LT ~ 1+41 LT (SOLID)(EDGE LINE)
 STA. 0+00 RT ~ 12+85 RT (SOLID)(EDGE LINE)

12 INCH WHITE LINE
 STA. 0+59 LT ~ 3+32 LT (SOLID)
 STA. 0+59 LT ~ 1+90 LT (DIAGONALS)
 STA. 1+41 LT ~ 1+90 LT (SOLID)(SLIP RAMP)
 STA. 3+08 RT ~ 4+40 RT (SOLID)(GORE)
 STA. 6+39 RT ~ 7+01 RT (SOLID)(GORE)
 STA. 3+32 LT ~ 6+39 LT (DOTTED)

LETTER OR SYMBOL
 STA. 0+48 LT (STOP)
 STA. 0+76 LT (▼) (4) 7
 STA. 1+86 LT (↶)
 STA. 1+86 LT (↷)
 STA. 2+59 LT (ONLY) (2)
 STA. 3+32 LT (↶)
 STA. 3+32 LT (↷)

TEMPORARY 12 INCH WHITE LINE
 STA. 0+59 LT ~ 3+32 LT (SOLID)
 STA. 0+59 LT ~ 1+90 LT (DIAGONALS)
 STA. 1+41 LT ~ 1+90 LT (SOLID)(SLIP RAMP)
 STA. 3+08 RT ~ 4+40 RT (SOLID)(GORE)
 STA. 6+39 RT ~ 7+01 RT (SOLID)(GORE)
 STA. 3+32 LT ~ 6+39 LT (DOTTED)

TEMPORARY LETTER OR SYMBOL
 STA. 0+48 LT (STOP)
 STA. 0+76 LT (▼) (4)
 STA. 0+86 LT (↶)
 STA. 0+86 LT (↷)
 STA. 3+32 LT (↶)
 STA. 3+32 LT (↷)

24 INCH STOP BAR
 STA. 0+40 LT

TEMPORARY 24 INCH STOP BAR
 STA. 0+40 LT

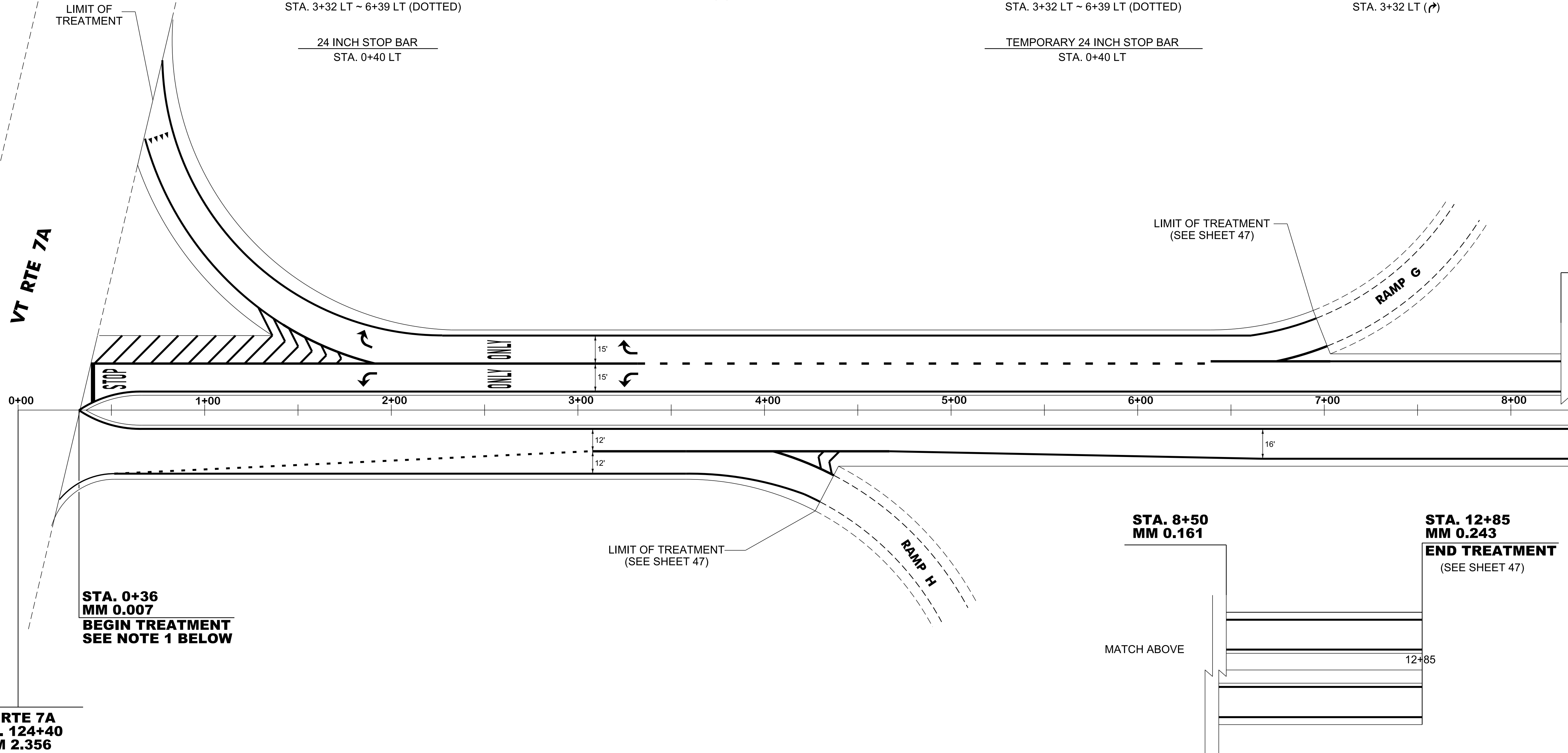

**STA. 0+36
 MM 0.007
 BEGIN TREATMENT
 SEE NOTE 1 BELOW**

LIMIT OF TREATMENT
 (SEE SHEET 47)

**STA. 8+50
 MM 0.161**

**STA. 12+85
 MM 0.243
 END TREATMENT
 (SEE SHEET 47)**

**VT RTE 7A
 STA. 124+40
 MM 2.356**

NOTE 1.
 STA. 0+36 ~ 12+85: COLD PLANE 1.5", PAVE WITH 1.5" TYPE IVS, APPLY ALTERNATE A OR B.
 TACK COAT APPLICATION:
 COLD PLANED SURFACE--0.080 GAL/SY SPECIAL PROVISION (EMULSIFIED ASPHALT) (RS-1H OR CRS-1H)
 ALL OTHER PAVED SURFACES--0.025 - 0.040 GAL/SY SPECIAL PROVISION (EMULSIFIED ASPHALT) (RS-1H OR CRS-1H)

NOT TO SCALE

PAVING PROJECT LAYOUT # 37 (BENNINGTON NORTH STATE HIGHWAY)	PROJECT NAME: BENNINGTON-MANCHESTER	FILE NAME: I1b026.dgn	PLOT DATE: 22-AUG-2013 14:33
	PROJECT NUMBER: NH SURF(29)	PROJECT LEADER: M. FOWLER	DRAWN BY: PVT. MGT.
		DESIGNED BY: PVT. MGT.	CHECKED BY: PVT. MGT.
		I1b026-46.1	SHEET 46 OF 63