

REINFORCEMENT PLAN (NXTBM-02)
SCALE: 1" = 1'-0"

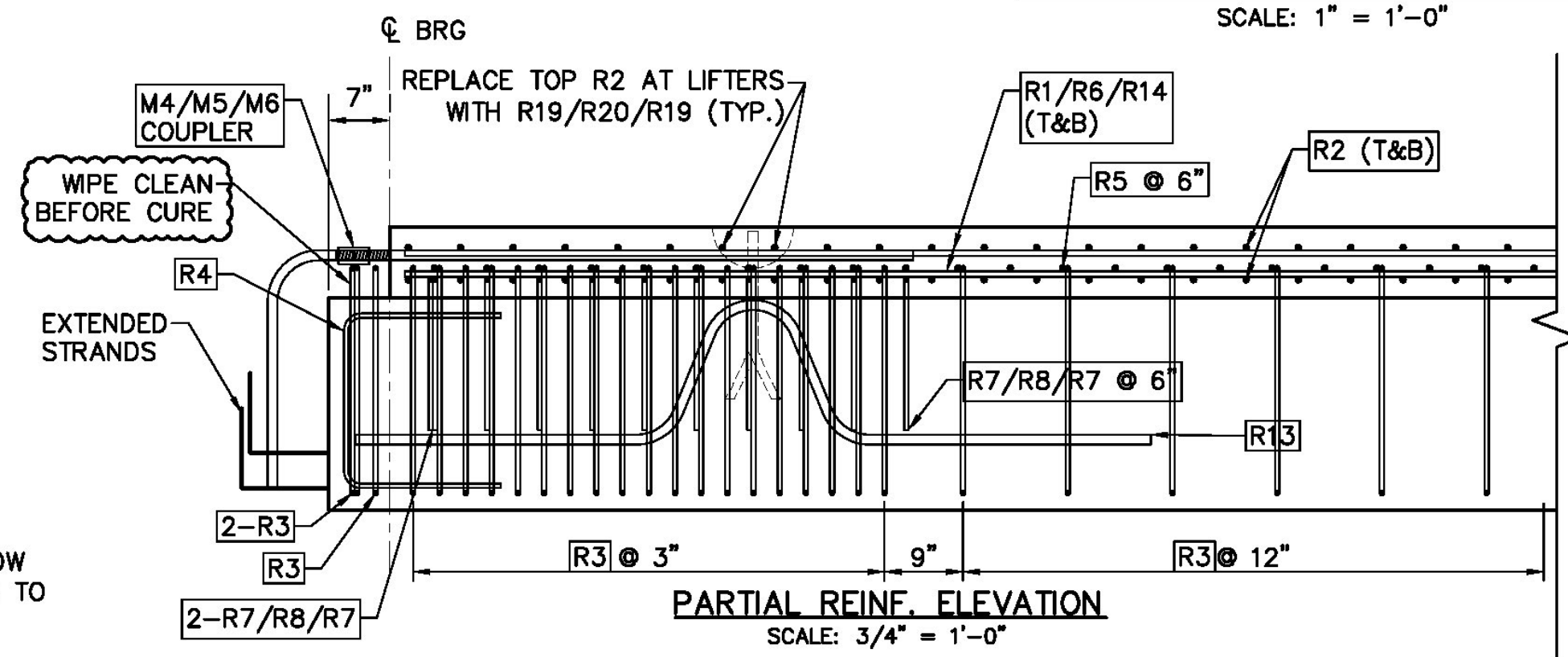

PARTIAL REIN. ELEVATION
SCALE: 3/4" = 1'-0"

REINFORCEMENT CHART					
DESCRIPTION					
BAR MARK	BAR SIZE	COATING	BENT/ STRAIGHT	LENGTH	QTY
R1	5	E	STRAIGHT	20'- 0.00"	32
R2	5	E	STRAIGHT	9'- 6.38"	240
R3	4	E	BENT	6'- 6.63"	188
R4	4	E	BENT	4'- 7.50"	16
R5	5	E	HEADED	4'- 4.375"	238
R6	5	E	STRAIGHT	35'- 2.00"	32
R7	4	E	BENT	2'- 6.38"	52
R8	4	E	BENT	7'- 4.50"	26
R13	9	E	BENT	9'- 0.00"	4
R14	5	E	STRAIGHT	10'- 0.00"	32
R19	5	E	STRAIGHT	1'- 9.25"	6
R20	5	E	STRAIGHT	4'- 8.25"	6

NOTES:

STRANDS SHALL BE (270 KSI) 0.6" Ø LOW RELAXATION STRAIGHT STRAND PULLED TO 44 KIPS.

EACH STRAND SHALL BE FINALLY BURNED OR CUT OFF AT A DEPTH OF 1/2" INTO THE END OF THE BEAM AND THE RECESSED AREA AROUND THE STRAND SHALL BE FILLED WITH NON-SHRINK GROUT, EXCEPT AS NOTED.

STAGGER SPLICES OF R1\R6\R14 OR R21\R22 BARS BY 5'-0" MIN.

MIN LAP LENGTH OF R1\R6\R14 OR R21\R22 BARS IS 2'-9" MIN.

CONSTRUCTION SET DATE: 06/28/2013

SHEET NAME: NXTBM-02 REINFORCEMENT PLAN

REVISION NO. REVISION DATE

Dailey
PRECAST

WILLIAM E. DAILEY PRECAST, LLC
295 AIRPORT ROAD
SHAFTSBURY, VT 05262
TEL: 802.442.4418 FAX: 802.442.0738

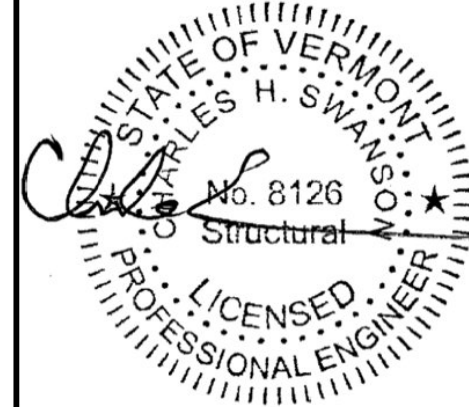

EIV TECHNICAL SERVICES
55 LEROY ROAD, WILLISTON, VT 05495
TEL: (802) 497-3653 FAX: (802) 497-3656

DATE: JUNE 2013 PROJECT # E1729
DRAWN BY: LKW/CN CHECKED BY: CHS

STATE OF VERMONT AGENCY OF TRANSPORTATION

PLYMOUTH, VERMONT
PROJECT NO: ER BRS 0149(5)

SHEET 5 OF 9