

REINFORCEMENT CHART					
DESCRIPTION					
BAR MARK	BAR SIZE	COATING	BENT/ STRAIGHT	LENGTH	QTY
R1	5	E	STRAIGHT	20'-0.00"	32
R2	5	E	STRAIGHT	9'-6.38"	166
R3	4	E	BENT	6'-6.63"	188
R4	4	E	BENT	4'-7.50"	16
R5	5	E	HEADED	4'-4.375"	120
R6	5	E	STRAIGHT	35'-2.00"	32
R7	4	E	BENT	2'-6.38"	52
R8	4	E	BENT	7'-4.50"	26
R9	5	E	BENT	3'-10.25"	62
R10	6	E	BENT	9'-11.75"	142
R11	5	E	BENT	5'-4.63"	12
R12	5	E	BENT	4'-11.63"	5
R13	9	E	BENT	9'-0.00"	4
R14	5	E	STRAIGHT	10'-0.00"	32
R16	6	E	BENT	2'-7.38"	6
R17	6	E	STRAIGHT	4'-8.25"	6
R18	6	E	STRAIGHT	1'-9.25"	6
R21	5	E	STRAIGHT	40'-0.00"	3
R22	5	E	STRAIGHT	15'-0.00"	3

NOTES:
 STRANDS SHALL BE 270 KSI 0.6" Ø LOW RELAXATION STRAIGHT STRAND PULLED TO 44 KIPS.
 EACH STRAND SHALL BE FINALLY BURNED OR CUT OFF AT A DEPTH OF 1/2" INTO THE END OF THE BEAM AND THE RECESSED AREA AROUND THE STRAND SHALL BE FILLED WITH NON-SHRINK GROUT, EXCEPT AS NOTED.
 STAGGER SPLICES OF R1\R6\R14 OR R21\R22 BARS BY 5'-0" MIN.
 MIN LAP LENGTH OF R1\R6\R14 OR R21\R22 BARS IS 2'-9" MIN.

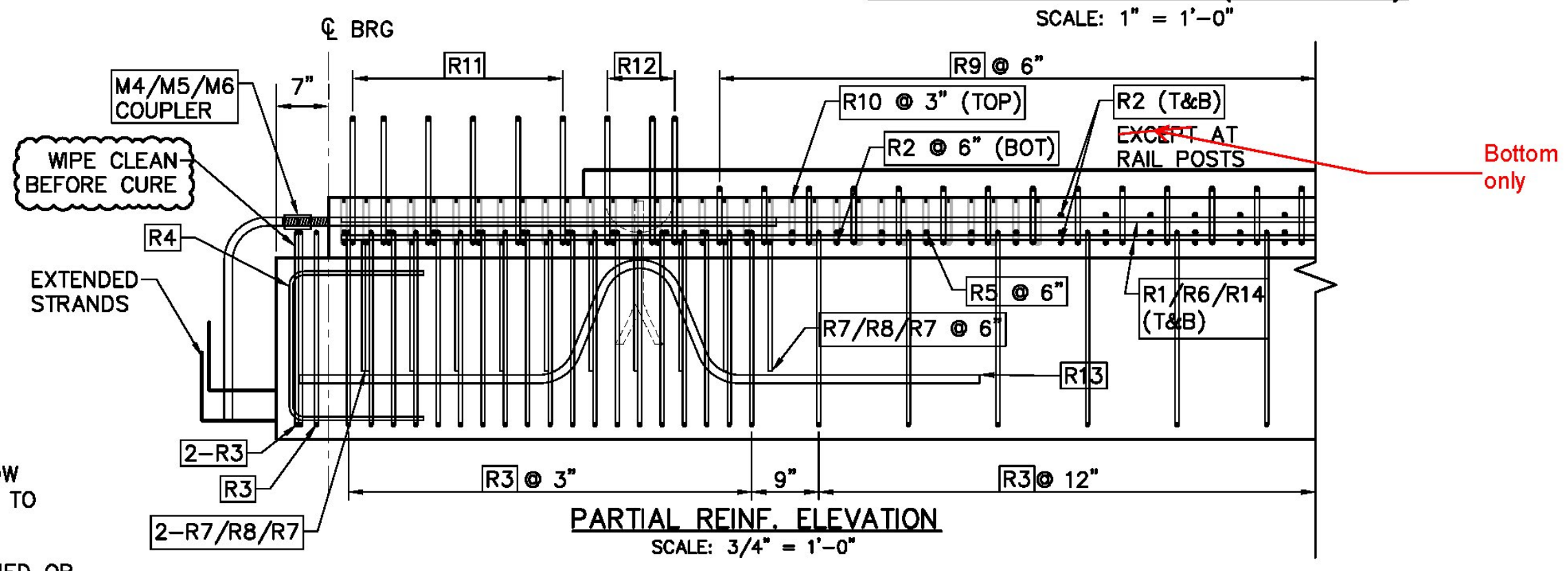

CONSTRUCTION SET DATE: 06/28/2013	
SHEET NAME: NXTBM-01 REINFORCEMENT PLAN	
REVISION NO.	REVISION DATE

Dailey PRECAST
 WILLIAM E. DAILEY PRECAST, LLC
 295 AIRPORT ROAD
 SHAFTSBURY, VT 05262
 TEL: 802.442.4418 FAX: 802.442.0738

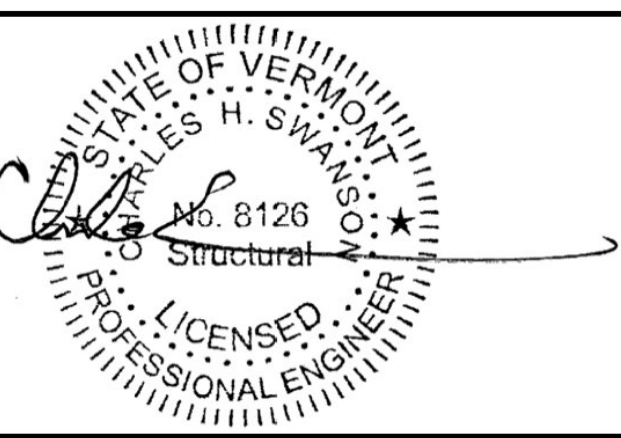

EIV TECHNICAL SERVICES
 55 LEROY ROAD, WILLISTON, VT 05495
 TEL: (802) 497-3653 FAX: (802) 497-3656
 DATE: JUNE 2013 PROJECT # E1729
 DRAWN BY: LKW/CN CHECKED BY: CHS

STATE OF VERMONT AGENCY OF TRANSPORTATION
 PLYMOUTH, VERMONT
 PROJECT NO: ER BRS 0149(5)
SHEET 3 OF 9