

**CONSTRUCTION APPROACH SIGNING**

NOT TO SCALE  
SEE STD T-10 FOR SIGN PLACEMENT

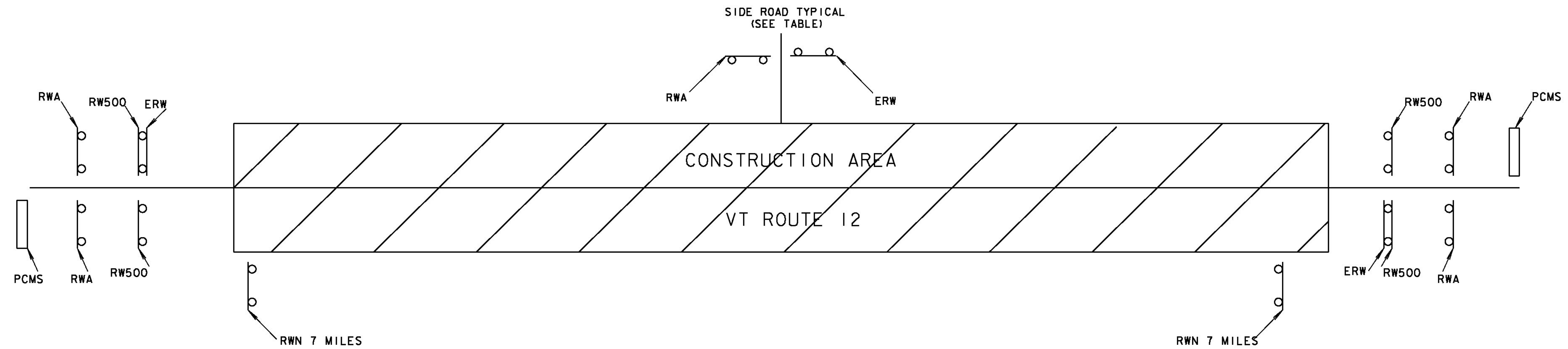

**NOTES:**

- THE CONTRACTOR SHALL SUBMIT A SITE SPECIFIC TRAFFIC CONTROL PLAN TO THE ENGINEER FOR THEIR APPROVAL PRIOR TO THE START OF CONSTRUCTION. THE COST OF PREPARING THIS PLAN (AND MAKING CHANGES IF NECESSARY) SHALL NOT BE PAID SEPARATELY BUT SHALL BE PAID AS PART OF ITEM 641.10, "TRAFFIC CONTROL". THE TRAFFIC CONTROL PLAN SHALL BE IN COMPLIANCE WITH VAOT STANDARDS AND 2009 MUTCD. WHERE CONFLICTS EXIST, THE 2009 MUTCD SHALL GOVERN.
- THE CONTRACTOR SHALL INCLUDE A CONSTRUCTION SIGN APPROACH PACKAGE FOR EXPECTED LANE CLOSURES AND WORK ZONE SPEED REDUCTIONS IN COMPLIANCE WITH THE TRAFFIC CONTROL NOTES AND PART 6 OF THE 2009 MUTCD. PAYMENT FOR PROVIDING THIS PACKAGE WILL BE INCLUDED IN THE UNIT PRICE BID FOR ITEM 641.10, "TRAFFIC CONTROL".
- THE BID PRICE FOR "TRAFFIC CONTROL", ITEM 641.10, SHALL INCLUDE ALL OF THE FOLLOWING, AS NEEDED: APPROACH AND ON-PROJECT CONSTRUCTION SIGNING, PORTABLE ARROW BOARDS, BARRIERS, BARRELS, CONES, BARRICADES, TEMPORARY REGULATORY AND WARNING SIGNS, AND POSTS AS DETAILED IN VAOT STANDARDS. ALL ADJUSTING, RELOCATING, AND REMOVING OF THESE DEVICES AS DIRECTED BY THE ENGINEER SHALL ALSO BE INCLUDED. THE FOLLOWING ITEMS WILL BE PAID FOR SEPARATELY: 646.602, 646.612, 646.682, 646.692 - TEMPORARY PAVEMENT MARKINGS 630.10 UNIFORMED TRAFFIC OFFICER, 630.15 - FLAGGERS.
- THE MUTCD 2009 AND ITS LATEST REVISIONS SHALL BE THE STANDARD FOR ALL TRAFFIC CONTROL DEVICES VALID UNTIL SUCH TIME AS THEY ARE REPLACED OR RECONSTRUCTED. WHEN NEW TRAFFIC CONTROL DEVICES ARE ERECTED OR PLACED OR EXISTING TRAFFIC CONTROL DEVICES ARE REPLACED OR REPAIRED THE EQUIPMENT, DESIGN, METHOD OF INSTALLATION, PLACEMENT OR REPAIR SHALL CONFORM WITH SUCH STANDARDS.
- CONES SHALL BE USED TO CLEARLY DEFINE THE TRAVEL SPACE AND PROVIDE SEPARATION FROM THE WORK
- AS THE PAVING OPERATION MOVES, THE FLAGGER SIGNS SHALL BE MOVED ACCORDINGLY. AT NO TIME SHOULD THE FLAGGER SYMBOL SIGN BE MORE THAN 1000 FT FROM THE FLAGGER STATION. FLAGGER SIGNS SHALL BE COVERED OR TURNED AWAY IF FLAGGING OPERATIONS CEASE FOR MORE THAN 15 MINUTES.
- NO CONSTRUCTION SIGNS SHALL BE INSTALLED AS TO INTERFERE OR OBSTRUCT THE VIEW OF EXISTING TRAFFIC CONTROL DEVICES, STOPPING SIGHT DISTANCE, AND CORNER SIGHT DISTANCE FROM DRIVES AND TOWN HIGHWAYS.
- ALL PERMANENT SIGNS THAT CONFLICT WITH TEMPORARY TRAFFIC CONTROL SHALL BE COMPLETELY COVERED, THE PAYMENT FOR WHICH SHALL BE INCLUDED IN THE UNIT PRICE BID FOR ITEM 641.10 TRAFFIC CONTROL.
- CONSTRUCTION SIGNS SHALL BE IN NEW OR LIKE NEW CONDITION PER VAOT STANDARDS.
- DIAMOND SHAPED SIGNS SHALL BE 4' X4' WITH BLACK TEXT AND BORDER ON A RETROREFLECTIVE FLUORESCENT ORANGE BACKGROUND.
- CONSTRUCTION ZONE SIGNS SHALL BE INSTALLED AS OUTLINED IN THE SPECIAL PROVISIONS.
- WHERE TEMPORARY SIGNS ARE PLACED BEHIND GUARDRAIL, THEY SHALL BE ADJUSTED SUCH THAT THE BOTTOM OF THE SIGNS ARE ABOVE THE TOP OF GUARDRAIL.

**TRAFFIC CONTROL NOTES**

- THE CONTRACTOR SHALL PROVIDE ACCESS THROUGH THE WORK ZONE FOR EMERGENCY VEHICLES AT ALL TIMES.
- A MINIMUM LANE WIDTH OF 10 FT. SHALL BE MAINTAINED.
- WHEN COLD PLANED BITUMINOUS PAVEMENT IS OPEN TO TRAFFIC, A "MOTORCYCLES USE CAUTION" SIGN, AS PER VAOT STANDARD T-17, SHALL BE PROVIDED.
- THE CONTRACTOR SHOULD LEAVE NO LONGITUDINAL DROP-OFFS DURING THE OVERNIGHT HOURS. THEREFORE, THE FULL ROADWAY WIDTH SHOULD BE COLD PLANED OR PAVED DURING THE DAILY WORK PERIOD. WHEN NECESSARY, DROP-OFF PROTECTION IN THESE AREAS SHALL CONFORM TO VAOT STANDARD T-36.
- MAINTAIN ACCESS TO ALL PROPERTIES AT ALL TIMES FOR EMERGENCY VEHICLES. MAINTAIN ACCESS TO ALL COMMERCIAL AND MUNICIPAL PROPERTIES DURING BUSINESS HOURS. ACCESS TO RESIDENTIAL PROPERTIES MAY BE RESTRICTED FOR A SHORT DURATION (A FEW HOURS). THIS WORK SHALL BE COORDINATED WITH THE OWNER. COORDINATE MAJOR WORK ON COMMERCIAL OR MUNICIPAL ACCESSES WITH THE OWNER AT LEAST ONE WEEK PRIOR TO STARTING THE WORK. ALL ACCESSES SHALL ALSO BE KEPT FREE OF WORK AND TRAFFIC CONTROLLED BY UNIFORMED TRAFFIC OFFICERS OR FLAGGERS AS REQUIRED BY THE ENGINEER.
- TRAFFIC SHALL NOT BE CHANGED FROM ONE TRAFFIC PATTERN TO THE NEXT TRAFFIC PATTERN UNTIL ALL TEMPORARY MARKINGS, SIGNING AND SIGNAL WORK ARE COMPLETED. ANY CONFLICTING MARKINGS SHALL BE REMOVED.
- ALL PERMANENT SIGNS WHICH CONFLICT WITH TEMPORARY TRAFFIC CONTROL SHALL BE COMPLETELY COVERED.
- ALL REASONABLE EFFORTS SHALL BE MADE TO ACCOMMODATE PEDESTRIAN TRAVEL AT ALL TIMES. THIS CAN INCLUDE, BUT IS NOT LIMITED TO A DEDICATED PEDESTRIAN ESCORT, SIGNAGE AND CONED OFF WALKING AREAS WITHIN CLOSED LANES. FLAGGERS SHALL NOT BE USED AS PEDESTRIAN ESCORTS. WHEN EXISTING PEDESTRIAN FACILITIES ARE DISRUPTED, CLOSED, OR RELOCATED IN A TEMPORARY TRAFFIC CONTROL ZONE, THE TEMPORARY FACILITIES SHALL BE DETECTABLE AND SHALL INCLUDE ACCESSIBILITY FEATURES CONSISTENT WITH THE FEATURES PRESENT IN THE EXISTING PEDESTRIAN FACILITY. PAYMENT WILL BE INCLUDED IN THE UNIT PRICE BID FOR ITEM 641.10 TRAFFIC CONTROL.
- PLEASE NOTE THAT THE UTO (UNIFORMED TRAFFIC OFFICER), UNDER AUTHORITY GRANTED BY LAW (TITLE 23 VSA) MAY DIRECT AND CONTROL TRAFFIC. SUITABLE EXAMPLES IN WORK MIGHT INCLUDE THE DIRECTION AND CONTROLS OF TRAFFIC AT INTERSECTIONS WHERE SIGNALS ARE NOT FUNCTIONING OR ARE MALFUNCTIONING. IN THESE CASES, THE PRESENCE OF THE BLUE LIGHT MAY NOT BE SUITABLE OR NECESSARY. THE WEARING OF DEPARTMENTALLY REQUIRED AND APPROVED REFLECTIVE GARMENTS IS REQUIRED.

**LEGEND**

- RWA = ROAD WORK AHEAD
- RW500 = ROAD WORK 500 FT
- ERW = END ROAD WORK
- RWN = ROAD WORK NEXT 7 MILES
- PCMS = PORTABLE CHANGEABLE MESSAGE SIGN

DETAILS ARE NOT TO SCALE

	ROAD WORK AHEAD	END ROAD WORK	ROAD WORK 500 FT	ROAD WORK NEXT 7 MILES	PCMS
ELMORE					
BEGIN PROJECT (VT 12)	2	1	2	1	1
CROSS RD	1	1			
MICKLIN FARM RD	1	1			
LACASSE RD	1	1			
GREAVES HILL RD	1	1			
ELMORE POND RD	1	1			
WESTPHAL RD	1	1			
BEACH RD	1	1			
TJADER RD	1	1			
MORRISTOWN					
GODDARD NISBET RD	1	1			
ELMORE MOUNTAIN RD	1	1			
LOWER ELMORE MOUNTAIN RD	1	1			
LOWER ELMORE MOUNTAIN RD	1	1			
END PROJECT (VT 12)	2	1	2	1	1
TOTALS	16	14	4	2	2

<b>CONSTRUCTION APPROACH SIGNING SHEET</b>	PROJECT NAME: ELMORE-MORRISTOWN	PROJECT NUMBER: STP 2937 (1)
	FILE NAME: z11c310.dgn	PROJECT LEADER: C. LATHROP
	DESIGNED BY: S. LAMPHERE	CHECKED BY: C. LATHROP
	PLOT FILE: z11c310_193.i	SHEET 194 OF 194