

STATE OF VERMONT AGENCY OF TRANSPORTATION

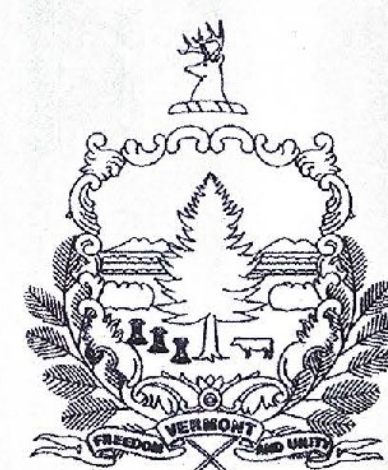

PROPOSED IMPROVEMENT TOWNS OF ELMORE AND MORRISTOWN COUNTY OF LAMOILLE VT ROUTE 12 (MAJOR COLLECTOR)

INDEX OF SHEETS
SEE SHEET 2

| RECORD PLANS | |
|--|------------------------------------|
| CONTRACTOR: | PIKE INDUSTRIES, INC. - BERLIN, VT |
| RESIDENT ENGINEER: | JEFF COTA |
| CONSTRUCTION BEGAN: | MAY 27, 2014 |
| CONSTRUCTION COMPLETE: | OCTOBER 8, 2014 |
| RECORD PLANS BY: | JEFF COTA & AARON JAMES |
| I HEREBY CERTIFY THAT ALL THE CONSTRUCTION REQUIRED BY THIS SET OF DRAWINGS HAS BEEN ACCOMPLISHED AS INDICATED HEREIN. | |
| BY _____ | RESIDENT ENGINEER |
| DATE <u>9/2/16</u> | |
| NOTE: Any further information concerning final quantities, amounts or other details relative to this project may be found by contacting Vtrans Records Management. | |

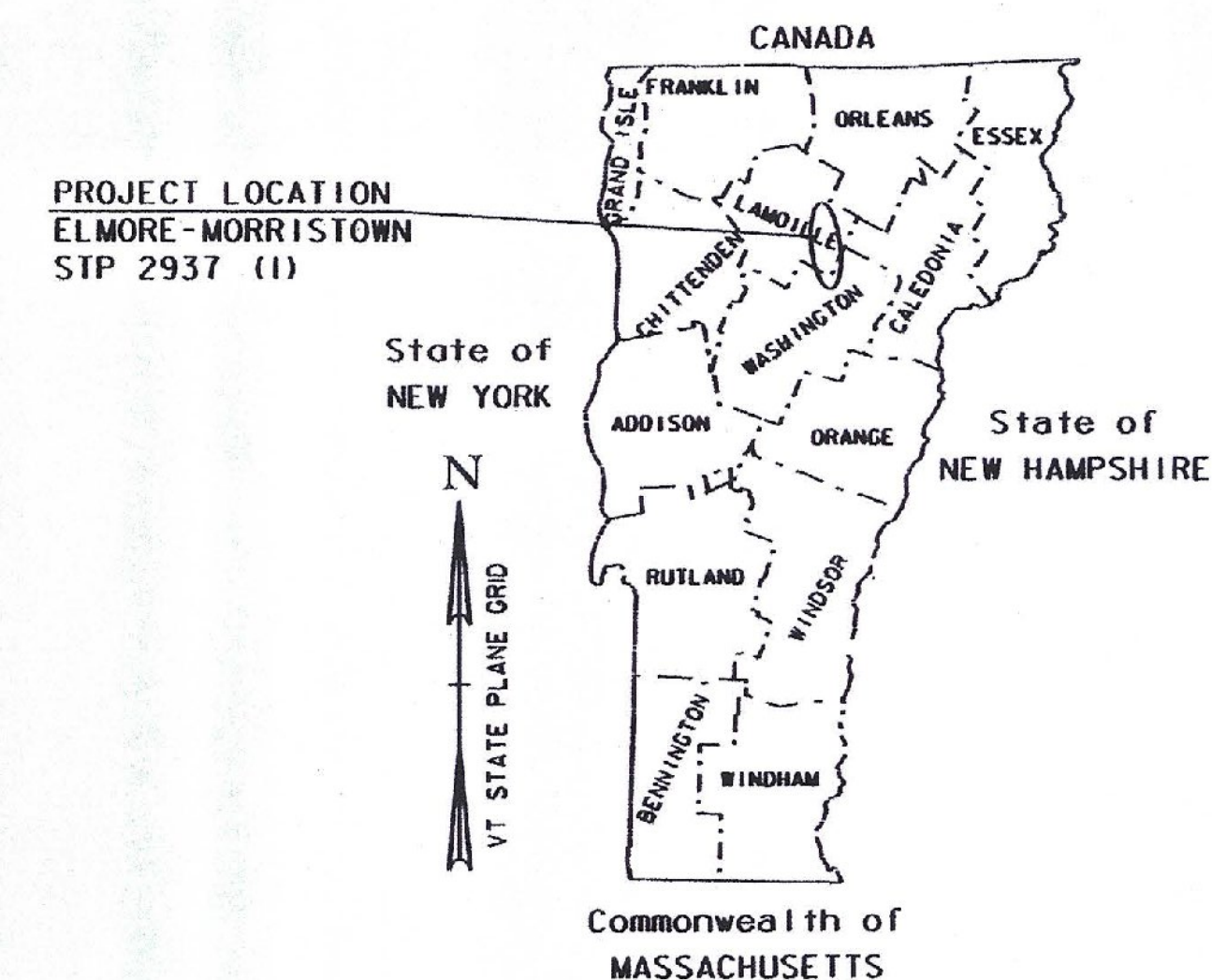

PROJECT LOCATION: BEGINNING ON VT ROUTE 12 IN THE TOWN OF ELMORE AT MILE MARKER 3.504 = STA. 185+00 AND EXTENDING NORTH ALONG VT ROUTE 12 FOR A DISTANCE OF 34915.00 FT (6.613 MILES) TO AN ENDING POINT AT MILE MARKER 2.189 = STA. A 115+57 IN THE TOWN OF MORRISTOWN.

TRAFFIC DATA

| HIGHWAY SECTION | AADT | | DHV | | CUM. ESALS (2014-2024) | CUM. ESALS (2014-2034) |
|----------------------------------|------|------|------|------|---------------------------|---------------------------|
| | 2014 | 2024 | 2014 | 2024 | | |
| BEGIN PROJECT TO LACASSE ROAD | 980 | 1000 | 150 | 150 | 118000 | 292000 |
| LACASSE ROAD TO ELMORE POND ROAD | 1700 | 1800 | 260 | 270 | 194000 | 489000 |
| ELMORE POND ROAD TO END PROJECT | 2500 | 2600 | 380 | 390 | 284000 | 672000 |

| STATION TO STATION DATA | LENGTH (FEET) | (MILES) |
|--|------------------|---------|
| TOWN OF ELMORE STA. 185+05.00 TO STA. 418+58.00 (MM 3.504 TO MM 7.928) | 23358.00 | 4.424 |
| TOWN OF MORRISTOWN STA. A 0+00.00 TO STA. A 115+57.00 (MM 0.000 TO MM 2.189) | 11557.00 | 2.189 |

TOTAL ROADWAY LENGTH = 34915.00 6.613
TOTAL PROJECT LENGTH = 34915.00 6.613

| SUPERPAVE BITUMINOUS CONCRETE PAVEMENT MIXTURE DESIGN CRITERIA | |
|--|---------------------------|
| DESIGN LANE/DESIGN LIFE ESALS | 672,000 |
| DESIGN NUMBER OF GYRATIONS | 65 |
| PERFORMANCE GRADE ASPHALT BINDER: | SEE SUBSECTION 490.03 (b) |

PROJECT DESCRIPTION: WORK TO BE PERFORMED UNDER THIS PROJECT INCLUDES COLD PLANING, RECLAIMING, CORRECTING SUPERELEVATION DEFICIENCIES, RESURFACING WITH BASE, INTERMEDIATE, AND WEARING COURSES, NEW PAVEMENT MARKINGS, GUARDRAIL IMPROVEMENTS, DRAINAGE IMPROVEMENTS AND OTHER RELATED HIGHWAY ITEMS.

STATIONING PREFACE DESIGNATION:
NO DESIGNATION = ELMORE
A = MORRISTOWN

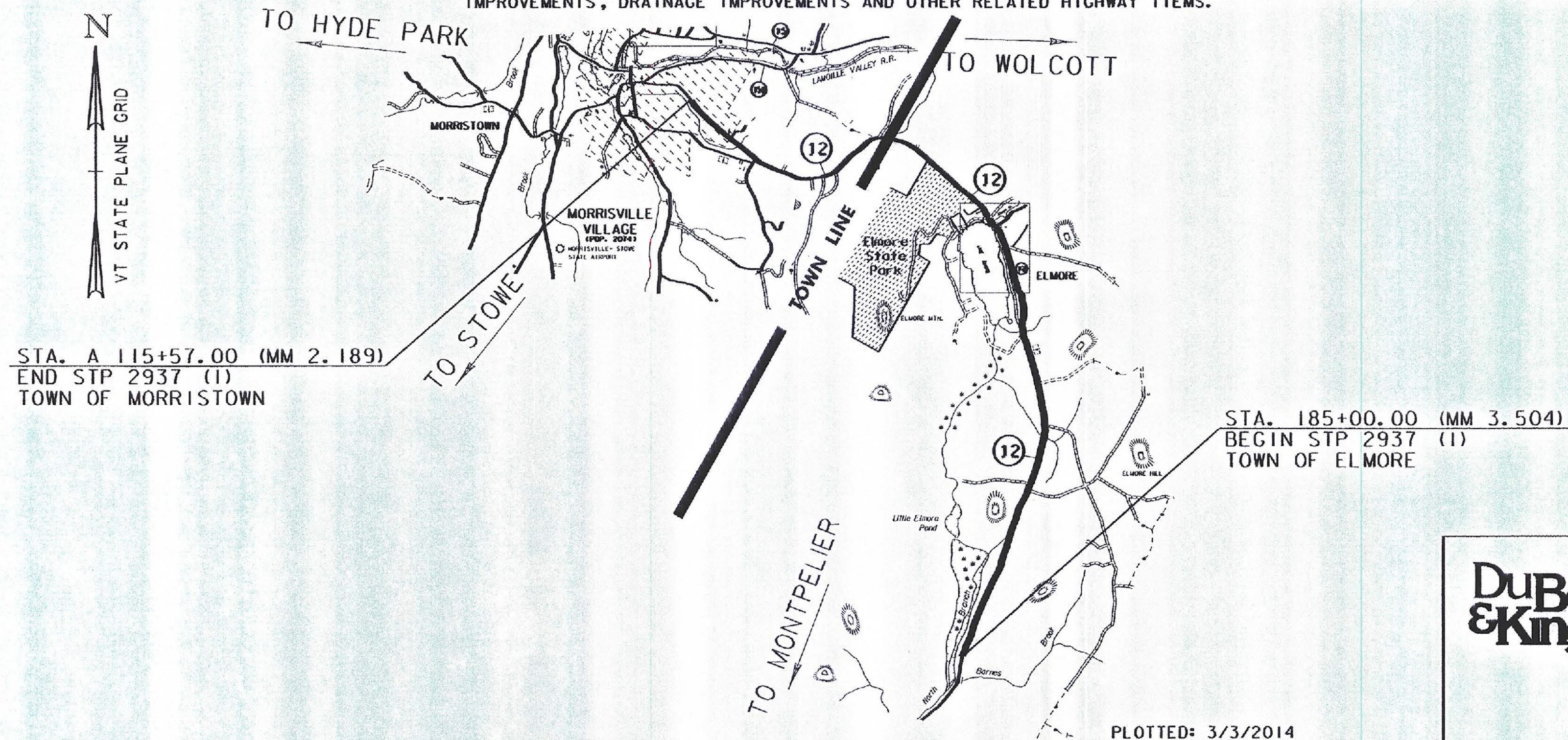

THESE PLANS ARE SUBJECT TO SUCH ENGINEERING CHANGES AS MAY BE REQUIRED BY THE FEDERAL HIGHWAY ADMINISTRATION OR THE DIRECTOR OF PROGRAM DEVELOPMENT.
CONSTRUCTION IS TO BE CARRIED ON IN ACCORDANCE WITH THESE PLANS AND THE STANDARD SPECIFICATIONS FOR CONSTRUCTION DATED 2011, AS APPROVED BY THE FEDERAL HIGHWAY ADMINISTRATION ON JULY 20, 2011 FOR USE ON THIS PROJECT, INCLUDING ALL SUBSEQUENT REVISIONS AND SUCH REVISED SPECIFICATIONS AND SPECIAL PROVISIONS AS ARE INCORPORATED IN THESE PLANS.

| |
|-------------------------------------|
| QUALITY ASSURANCE PROGRAM : LEVEL 3 |
| SURVEYED BY : VAOT |
| SURVEYED DATE : SEPT 2012 |
| DATUM |
| VERTICAL <u>NAVD 88</u> |
| HORIZONTAL <u>NAD 83 (2011)</u> |

DuBois & King INC.

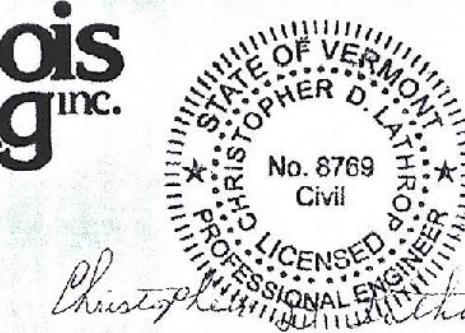

| | |
|-------------------------------------|--------------------|
| DIRECTOR OF PROGRAM DEVELOPMENT | |
| APPROVED <u>Richard Johnson</u> | DATE <u>3/5/14</u> |
| PROJECT MANAGER : MIKE FOWLER, P.E. | |
| PROJECT NAME : ELMORE-MORRISTOWN | |
| PROJECT NUMBER : STP 2937 (1) | |
| SHEET 1 OF 194 SHEETS | |

PLOTTED: 3/3/2014