

1 DIMENSIONAL PLANS & ELEVATIONS - GIRDER G2B  
7 SCALE: N.T.S.

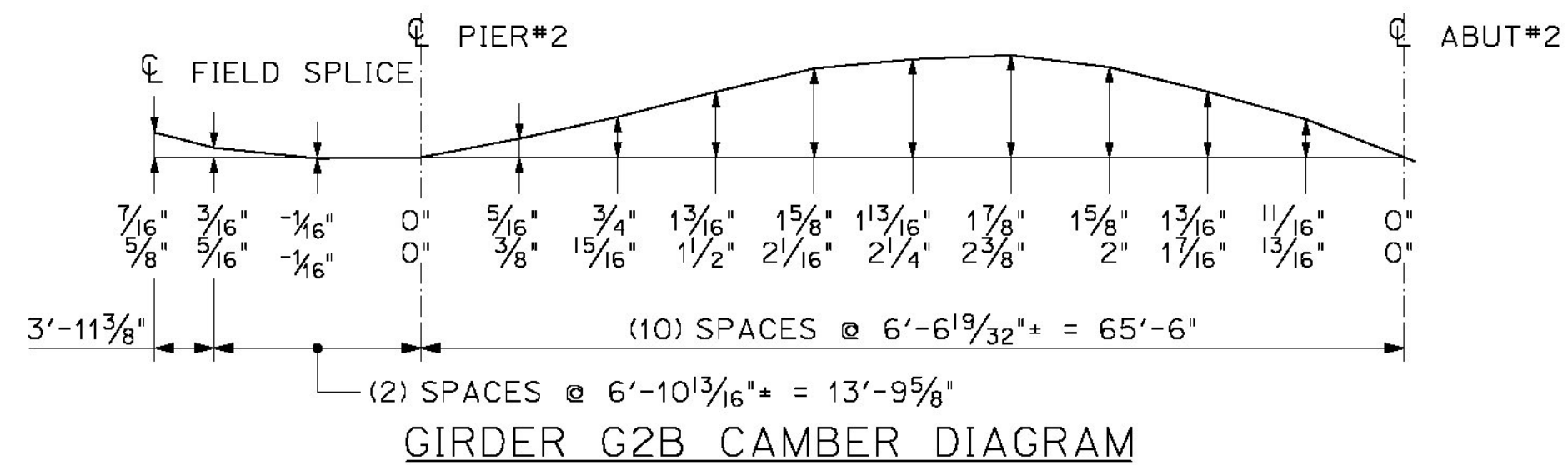

THE TWO CAMBER DIMENSIONS SHOWN REPRESENT THE FOLLOWING:  
TOP DIMENSION - TOTAL CAMBER IN FINISHED BEAM IN A NO-LOAD POSITION  
BTM DIMENSION - TOTAL CAMBER OF WEB @ TIME WEB IS CUT  
ADDITIONAL CAMBER TO ACCOMMODATE FOR CAMBER THAT WILL BE LOST DURING FABRICATION

BILL OF MATERIALS							
SHIP	SHIP MARK	NO. PCS.	PIECE MARK	DESCRIPTION	LENGTH	WEIGHT	MATERIAL
1	G2B			GIRDER G2B	83'-11 7/8"	16,600#	
		1	WP6	WEB PLATE 35"x1/2"	83'-11 7/8"	5,000#	CVN
		1	TF5	FLANGE PL 1 1/8"x18 3/8"	83'-11 1/16"	5,500#	CVN
		1	BF3	FLANGE PL 1 1/8"x18 3/8"	83'-11 5/16"	5,500#	CVN
		2	P1	SEE SHEET M1		80#	
		1	P6	SEE SHEET M1		80#	
		1	P7	SEE SHEET M1		80#	
		4	P2	SEE SHEET M1		25#	
		3	P3	SEE SHEET M1		25#	
		1	P4	SEE SHEET M1		25#	

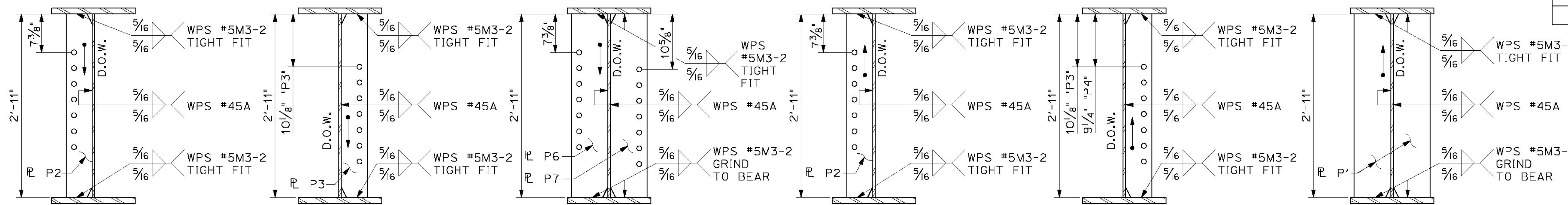

A DIMENSIONAL SECTION SCALE: 1"=1'-0"  
B DIMENSIONAL SECTION SCALE: 1"=1'-0"  
C DIMENSIONAL SECTION SCALE: 1"=1'-0"  
D DIMENSIONAL SECTION SCALE: 1"=1'-0"  
E DIMENSIONAL SECTION SCALE: 1"=1'-0"  
F DIMENSIONAL SECTION SCALE: 1"=1'-0"

FINISH: SSPC SP-10			
MATERIAL: AASHTO M270 (ASTM A709) GR. 50W			
HOLES:			
ELECTRODES: PER WELD PROCEDURE			
WELDS: PER WELD PROCEDURE			
SURFACE PREP: 1 FEB 2015 correct l.b. ETC.			
NO DATE DESCRIPTION BY			
REVISIONS			
		<b>ADVANCED RESOURCES &amp; CONST. ENTERPRISES, INCORPORATED</b> P.O. BOX 120 KINGFIELD, ME. 04947 PHONE: (207) 265-2646 - FAX: (207) 265-4054	
DRAFTER: ETC	GIRDER G2B		PROJECT NO. 14-178
DATE: FEB 2015	VT Rte 121 over Saxtons River		DWG. NO. 7
CHECKED: GNM	Rockingham Vermont VTRANS - BRF 0126(12)		
DATE: FEB 2015	Cold River Bridges, LLC		