

1  
4  
DIMENSIONAL PLANS & ELEVATIONS - GIRDER G3A  
SCALE: N.T.S.

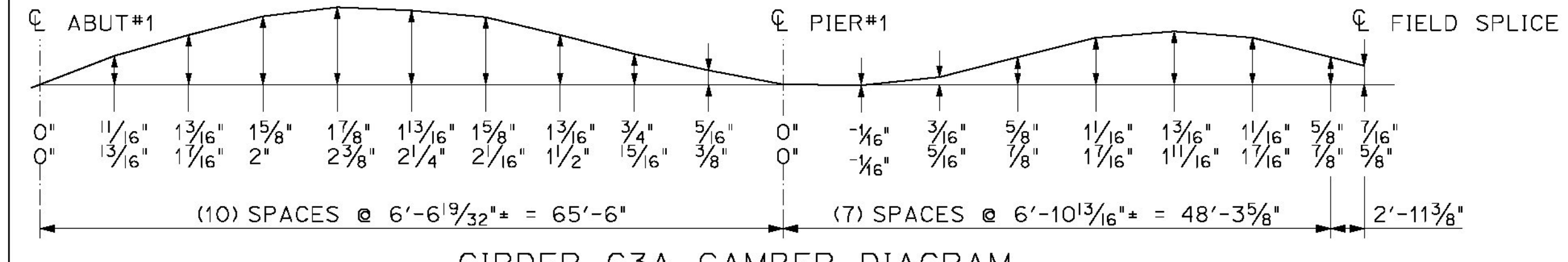

GIRDER G3A CAMBER DIAGRAM

THE TWO CAMBER DIMENSIONS SHOWN REPRESENT THE FOLLOWING:  
 TOP DIMENSION - TOTAL CAMBER IN FINISHED BEAM IN A NO-LOAD POSITION  
 BTM. DIMENSION - TOTAL CAMBER OF WEB @ TIME WEB IS CUT  
 ADDITIONAL CAMBER TO ACCOMMODATE FOR CAMBER THAT WILL BE LOST DURING FABRICATION

BILL OF MATERIALS							
SHIP	SHIP MARK	NO. PCS.	PIECE MARK	DESCRIPTION	LENGTH	WEIGHT	MATERIAL
1	G3A			GIRDER G3A	117'-6 <sup>3</sup> / <sub>4</sub> "	22,800#	
		1	WP4	WEB PLATE 35"x <sup>1</sup> / <sub>2</sub> "	48'-4 <sup>1</sup> / <sub>2</sub> "	2,900#	CVN
		1	WP5	WEB PLATE 35"x <sup>1</sup> / <sub>2</sub> "	69'-2 <sup>9</sup> / <sub>16</sub> "	4,150#	CVN
		1	TF4	FLANGE R 1 <sup>1</sup> / <sub>8</sub> "x18 <sup>3</sup> / <sub>8</sub> "	85'-3 <sup>9</sup> / <sub>16</sub> "	5,550#	CVN
		1	TF2	FLANGE R 1 <sup>1</sup> / <sub>8</sub> "x16"	32'-3 <sup>3</sup> / <sub>4</sub> "	2,000#	CVN
		1	BF4	FLANGE R 1 <sup>1</sup> / <sub>8</sub> "x18 <sup>3</sup> / <sub>8</sub> "	85'-3 <sup>3</sup> / <sub>16</sub> "	5,550#	CVN
		1	BF2	FLANGE R 1 <sup>1</sup> / <sub>8</sub> "x16"	32'-2 <sup>7</sup> / <sub>8</sub> "	2,000#	CVN
		2	P1	SEE SHEET M1		80#	
		1	P8	SEE SHEET M1		80#	
		1	P9	SEE SHEET M1		25#	
		4	P4	SEE SHEET M1		25#	
		6	P5	SEE SHEET M1		25#	

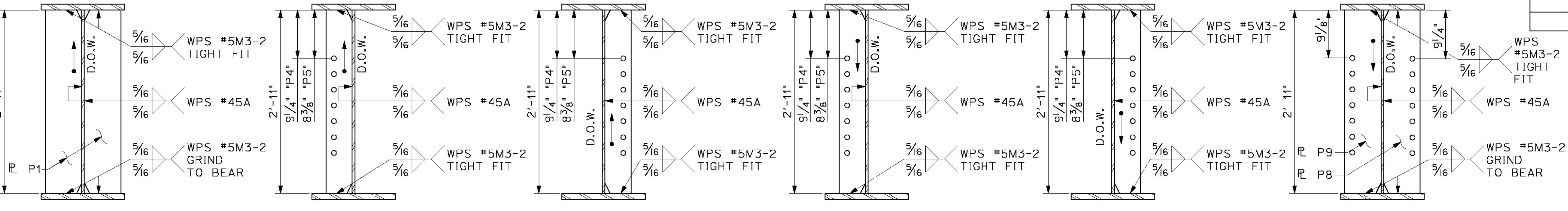

A DIMENSIONAL SECTION SCALE: 1"=1'-0"  
 B DIMENSIONAL SECTION SCALE: 1"=1'-0"  
 C DIMENSIONAL SECTION SCALE: 1"=1'-0"  
 D DIMENSIONAL SECTION SCALE: 1"=1'-0"  
 E DIMENSIONAL SECTION SCALE: 1"=1'-0"  
 F DIMENSIONAL SECTION SCALE: 1"=1'-0"

FINISH SSPC SP-10  
 MATERIAL AASHTO M270 (ASTM A709) GR. 50W  
 HOLES  
 ELECTRODES PER WELD PROCEDURE  
 WELDS PER WELD PROCEDURE  
 SURFACE PREP 1 FEB 2015 correct l.b. ETC  
 NO DATE DESCRIPTION BY

REVISIONS

**ARC**  
 ENTERPRISES, INC.

ADVANCED RESOURCES & CONST. ENTERPRISES, INCORPORATED  
 P.O. BOX 120 KINGFIELD, ME. 04947  
 PHONE: (207) 265-2646 - FAX: (207) 265-4054

DRAFTER ETC  
 DATE FEB 2015  
 CHECKED GNM  
 DATE FEB 2015

**GIRDER G3A**  
 VT Rte 121 over Saxtons River  
 Rockingham Vermont VTRANS - BRF 0126(12)  
 CC: Cold River Bridges, LLC

PROJECT NO. 14-178  
 DWG. NO. 4