



GUARDRAIL APPROACH SECTION,
GALVANIZED 2 RAIL BOX BEAM
(COATED BLACK)

21+69.32, RT - 22+03.33, RT
21+90.01, LT - 22+24.01, LT
24+05.15, RT - 24+38.98, RT
24+25.84, LT - 24+60.21, LT

BRIDGE RAILING, GALVANIZED STEEL
TUBING/CONCRETE COMBINATION
(COATED BLACK)

22+03.33, RT - 24+05.15, RT
22+24.01, LT - 24+25.84, LT

DURABLE 4" YELLOW LINE

20+26.19 - 21+12.28 (CENTERLINE)
21+52.28 - 25+12.79 (CENTERLINE)
22+04.98, LT

DURABLE 4" WHITE LINE

20+26.19, LT - 21+20.38, LT (EDGE LINE)
20+26.19, RT - 25+12.79, RT (EDGE LINE)
21+57.35, LT - 25+12.79, LT (EDGE LINE)

REMOVAL AND DISPOSAL OF GUARDRAIL

21+69.52, LT - 22+31.98, LT
20+57.50, RT - 22+08.42, RT
24+18.55, LT - 24+62.21, LT
23+97.48, RT - 24+47.48, RT

MANUFACTURED TERMINAL SECTION, TANGENT
(COATED BLACK)

20+50.69, 16.00', RT - 21+00.21, 15.50' RT

BOX BEAM GUARDRAIL (COATED BLACK)

21+67.88, LT - 21+78.01, LT (30' RADIUS)
21+78.01, LT - 21+90.01, LT
21+00.21, RT - 21+19.51, RT
21+19.51, RT - 21+51.32, RT
21+51.32, RT - 21+69.32, RT
24+60.21, LT - 24+96.97, LT
24+96.97, LT - 27+15.01, LT
27+15.01, LT - 27+83.30, LT
27+83.30, LT - 28+01.09, LT (20' RADIUS)
24+38.98, RT - 24+43.76, RT

DURABLE 12 INCH WHITE LINE

21+69.09, LT - 25+09.76, LT (DIAGONAL STRIPING)

24+30.02, LT

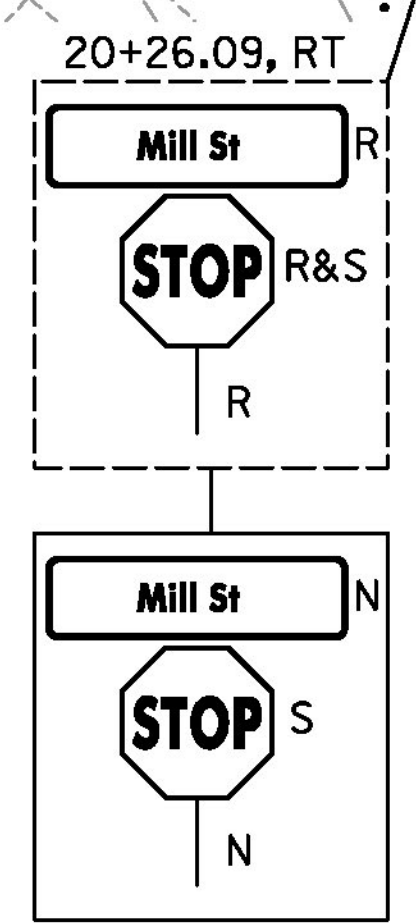
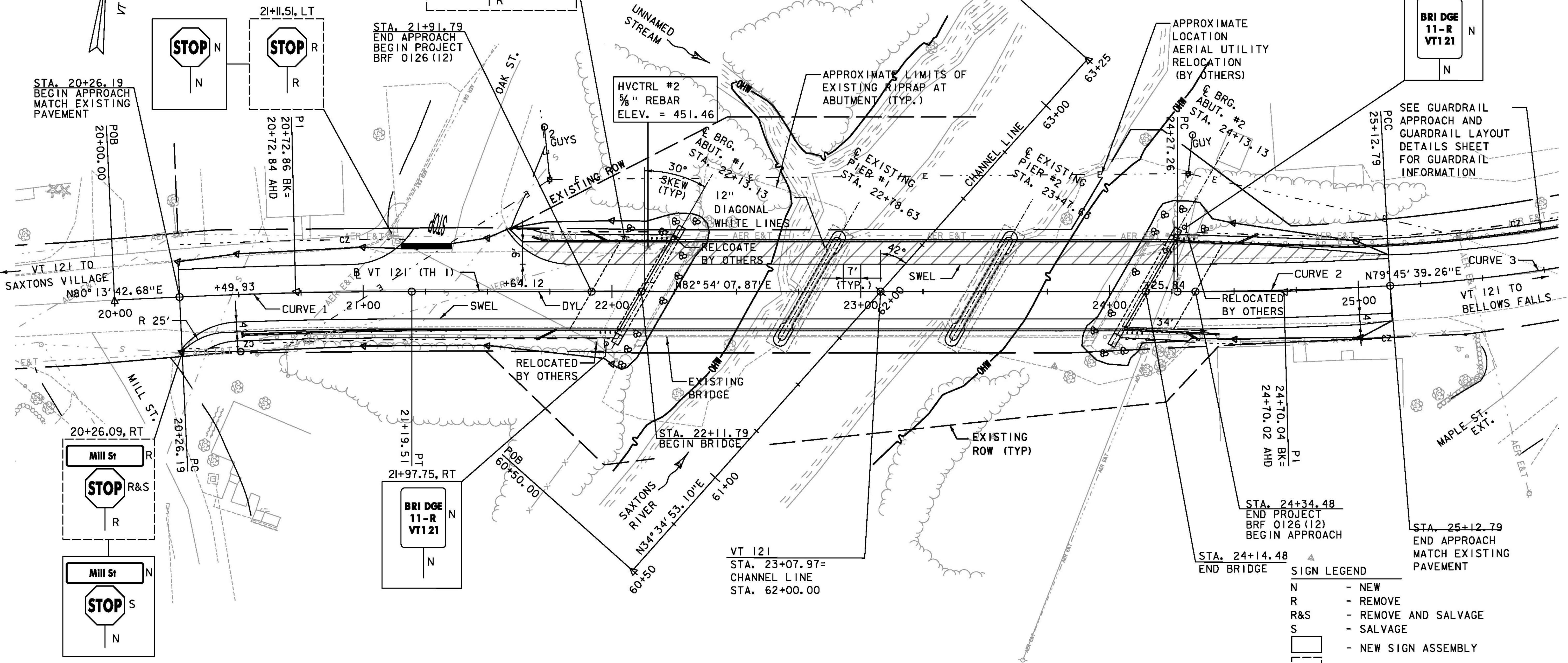

SIGN LEGEND
N - NEW
R - REMOVE
R&S - REMOVE AND SALVAGE
S - SALVAGE
[Solid Box] - NEW SIGN ASSEMBLY
[Dashed Box] - EXISTING SIGN ASSEMBLY

STRIPING LEGEND
DYL - 4" DOUBLE YELLOW LINE
SWEL - 4" SOLID WHITE EDGE LINE

EXISTING BRIDGE INFORMATION

BUILT 1954
CONTINUOUS, STEEL BEAM, CONCRETE DECK
3 SPANS @ 55.00', 69.00', AND 55.00'
30'-0" ROADWAY (CURB TO CURB)
CONCRETE POST AND STEEL RAILING

CURVE (1)
PI STA. = 20+72.86
DELTA = 2°40'25"
D = 2°51'53"
R = 2000.00'
T = 46.67'
L = 93.33'
E = 0.54'

CURVE (2)
PI STA. = 24+70.04
DELTA = 3°08'29"
D = 3°40'22"
R = 1560.00'
T = 42.77'
L = 85.53'
E = 0.59'

CURVE (3)
PI STA. = 26+14.75
DELTA = 18°06'13"
D = 8°57'09"
R = 640.00'
T = 101.96'
L = 202.22'
E = 8.07'

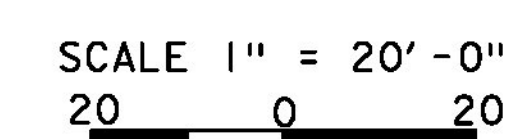

DATUM
VERTICAL NAVD 88(GEIOD09) FT
HORIZONTAL NAD 83(CORS) sFT
ADJUSTMENT LSQ

PROJECT NAME: ROCKINGHAM
PROJECT NUMBER: BRF 0126(12)
FILE NAME: z10j072bdr_nul.dgn
PROJECT LEADER: R. HEBERT
DESIGNED BY: D. BRYANT
LAYOUT SHEET
PLOT DATE: 8/26/2014
DRAWN BY: D. BURHANS
CHECKED BY: D. BRYANT
SHEET 12 OF 69

TYLIN INTERNATIONAL