

ABUTMENT NO. 1 REINFORCING PLAN
SCALE 3/8" = 1'-0"
(ABUTMENT NO. 2 SIMILAR)

- NOTES:
1. TRANSVERSE POST-TENSIONING DUCTS & GROUT DUCTS NOT SHOWN FOR CLARITY.
 2. (4) - #7 TRANSVERSE BARS AT TOP AND BOTTOM OF PRECAST CAP NOT SHOWN FOR CLARITY.

NOTE:
NF = NEAR FACE
FF = FAR FACE
EF = EACH FACE
▲ = CUT TO FIT IN FIELD
3' CLEAR, UNLESS OTHERWISE SPECIFIED ON THE PLANS.
2'-2" BAR LAP UNLESS OTHERWISE SPECIFIED ON THE PLANS.

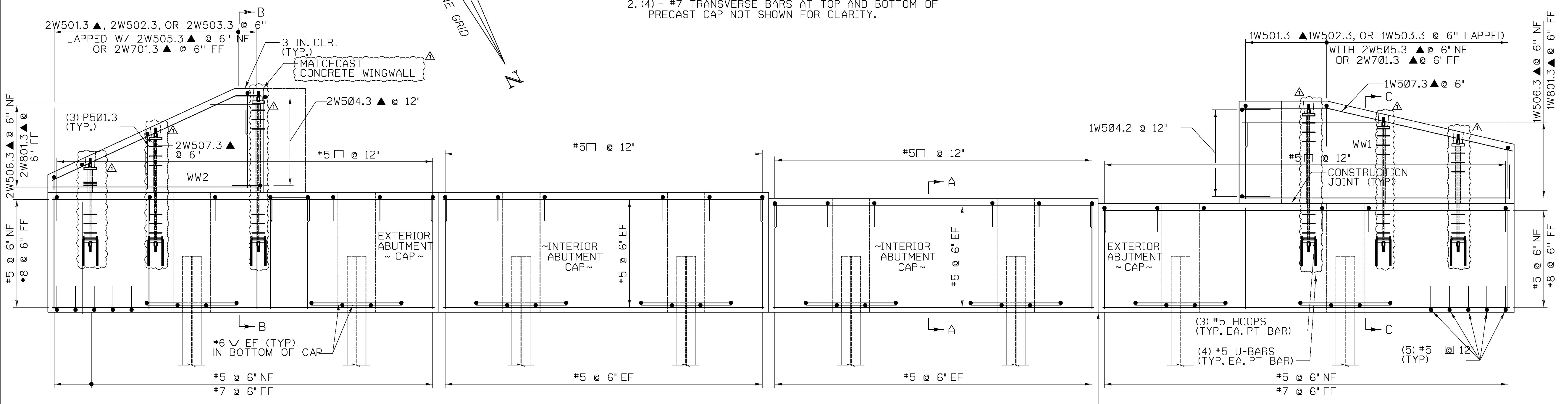

ABUTMENT NO. 1 REINFORCING ELEVATION
SCALE 3/8" = 1'-0"
(ABUTMENT NO. 2 SIMILAR, 4W SIMILAR TO 1W, 3W SIMILAR TO 2W)

- NOTES:
1. SEE ABUTMENT SECTIONS SHEET FOR SECTIONS A-A, B-B, AND C-C.
 2. TOP PORTION OF WINGWALLS TO BE MATCH CAST.
 3. THE BRIDGE PLAQUE FURNISHED BY THE AGENCY SHALL BE CAST INTO WINGWALL 2. ALL WORK TO INSTALL THE PLAQUE SHALL BE INCIDENTAL TO THE APPROPRIATE CONCRETE CONTRACT ITEM. SEE SD-502.00 FOR FURTHER DETAILS.

CALDERWOOD ENGINEERING, ETC.
STRUCTURAL ENGINEERING • DETAILING SERVICES
222 RIVER RD. RICHMOND, ME 04857 PH/FX (207) 737-2007/(207) 737-2008
PREPARED FOR:
COLD RIVER BRIDGES, LLC
CEE 16-16-COLDRIVERBRIDGES
01-CS-LUDLOW

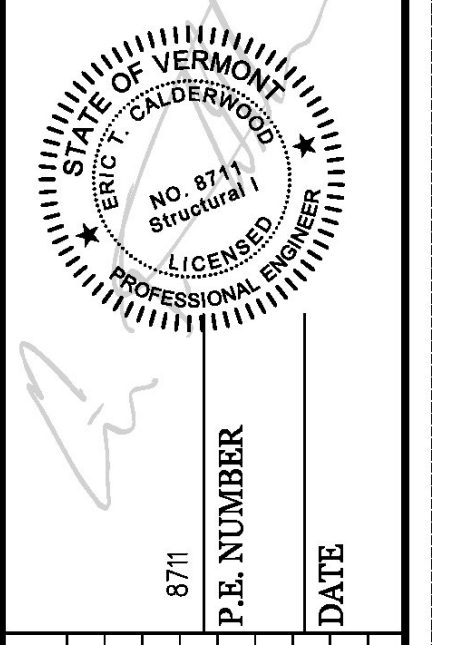

DESIGN-DETAILED	CHECKED-REVIEWED	REVISIONS 1	REVISIONS 2	REVISIONS 3	REVISIONS 4	FIELD CHANGES
TDC	TDC					

DATE	BY	P.E. NUMBER	DATE
JAN 2017	TDC	8711	
MAR 2017	TDC		

VE SUPER DESIGN
LUDLOW VT. BR# 025-1(42)
ABUTMENT REINFORCING

SHEET NUMBER
44
of 73

