

LOCATION: STA. 5+78, LT.

COLOR: WHITE BORDER AND TEXT (RETROREFLECTIVE)
GREEN BACKGROUND (RETROREFLECTIVE)

MATERIAL: 0.100" THICKNESS

ITEM 646.404 - DURABLE 4 INCH
WHITE LINE, POLYUREA

STA. 2+15 - 5+83, LT.
STA. 2+15 - 6+10, RT.

ITEM 646.414 - DURABLE 4 INCH YELLOW
LINE, POLYUREA

STA. 2+15 - 6+10 (DOUBLE YELLOW C)

ITEM 675.50 - REMOVING SIGNS

AS SHOWN - 9

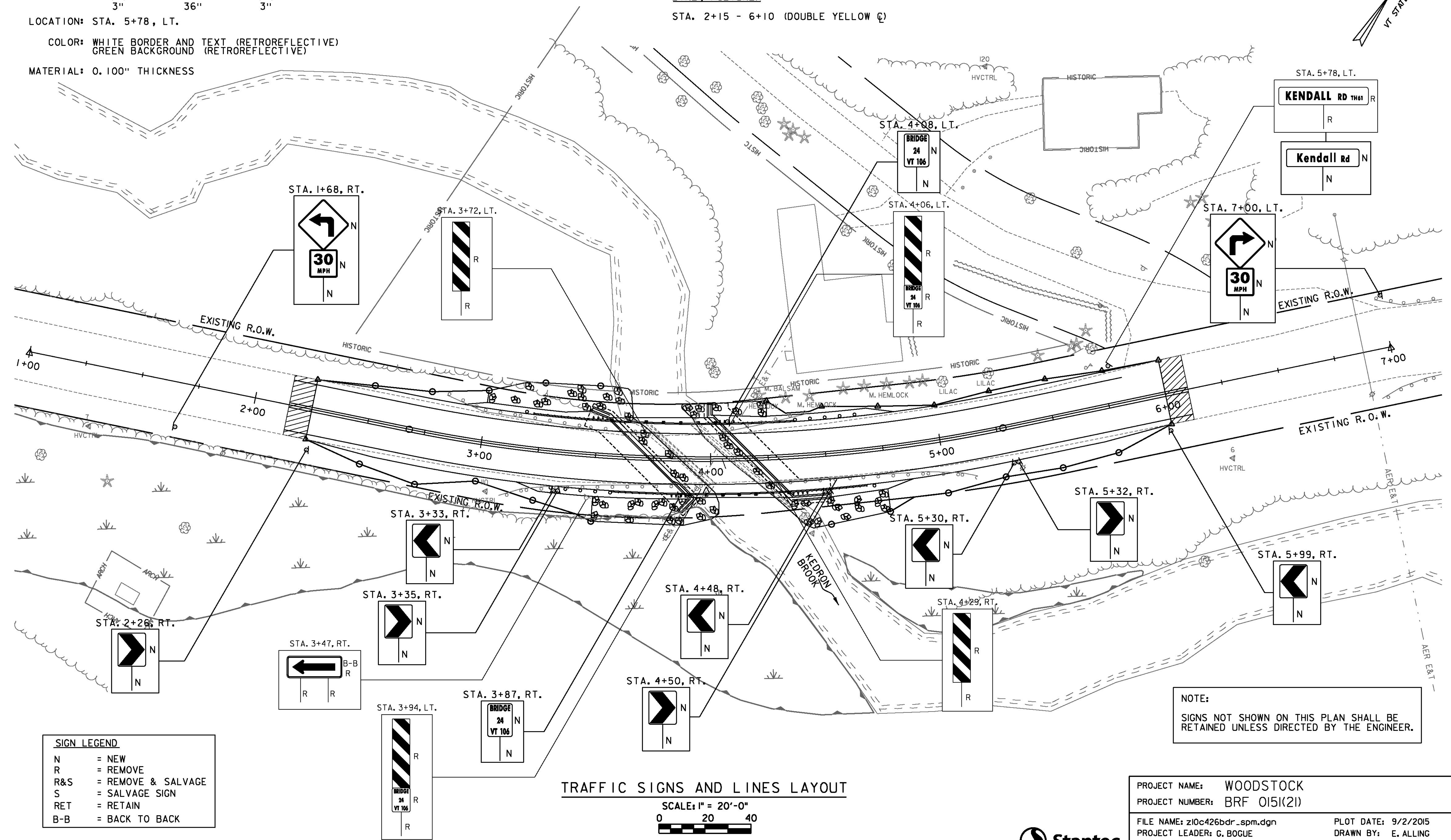
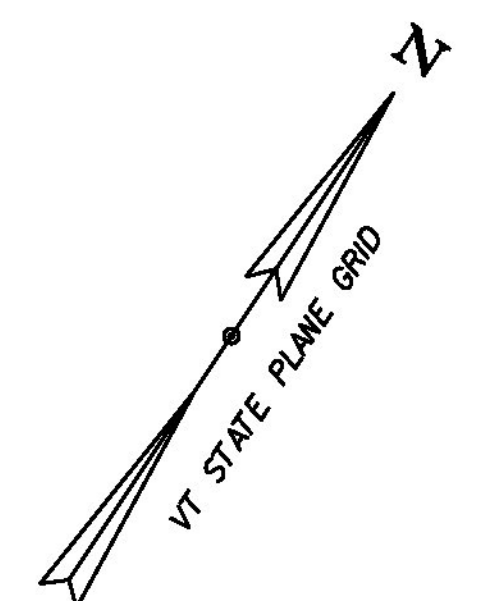

SIGN LEGEND	
N	= NEW
R	= REMOVE
R&S	= REMOVE & SALVAGE
S	= SALVAGE SIGN
RET	= RETAIN
B-B	= BACK TO BACK

TRAFFIC SIGNS AND LINES LAYOUT

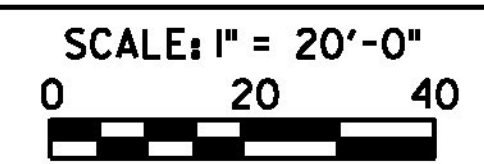

NOTE:
SIGNS NOT SHOWN ON THIS PLAN SHALL BE
RETAINED UNLESS DIRECTED BY THE ENGINEER.

PROJECT NAME:	WOODSTOCK
PROJECT NUMBER:	BRF 015(21)
FILE NAME:	z10c426bdr_spm.dgn
PROJECT LEADER:	G. BOGUE
DESIGNED BY:	E. ALLING
TRAFFIC SIGNS AND LINES LAYOUT - TSL 1	SHEET 19 OF 50
PLOT DATE:	9/2/2015
DRAWN BY:	E. ALLING
CHECKED BY:	I. MAYNARD

