

HVCTRL #1  
389174.4977 N  
1634481.8006 E  
ELEV: 1005.44'

HVCTRL #2  
388828.4329 N  
1634244.4975 E  
ELEV: 986.75'

HVCTRL #3  
388900.4009 N  
1634403.6064 E  
ELEV: 986.32'

HVCTRL #4  
388963.9474 N  
1634531.8644 E  
ELEV: 974.44'

HVCTRL #5  
389092.4860 N  
1634665.7851 E  
ELEV: 976.31'

ITEM 656.85 - TREE PROTECTION  
STA. 4+26 LT. - 5+40, LT.

ITEM 621.51 - MANUFACTURED TERMINAL  
SECTION, TANGENT (BEAT)

STA. 3+27 - 3+41, RT.  
STA. 4+55 - 4+69, LT.

ITEM 621.725 - GUARDRAIL APPROACH  
SECTION, GALVANIZED 3 RAIL BOX BEAM

STA. 3+22 - 3+54, LT.  
STA. 3+58 - 3+89, RT.  
STA. 4+04 - 4+37, LT.  
STA. 4+35 - 4+66, RT.

ITEM 210.10 - COLD PLANING,  
BITUMINOUS PAVEMENT

STA. 2+15 - 2+25  
STA. 6+00 - 6+10

VT 106 CURVE DATA  
CURVE (1)  
Δ = 23°22'12" LT.  
D = 9°00'00"  
R = 636.62'  
T = 131.66'  
L = 259.67'  
E = 13.47'  
BANK = 0.044

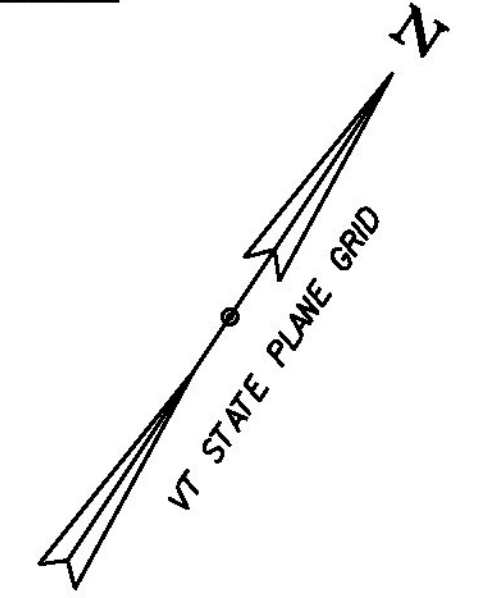
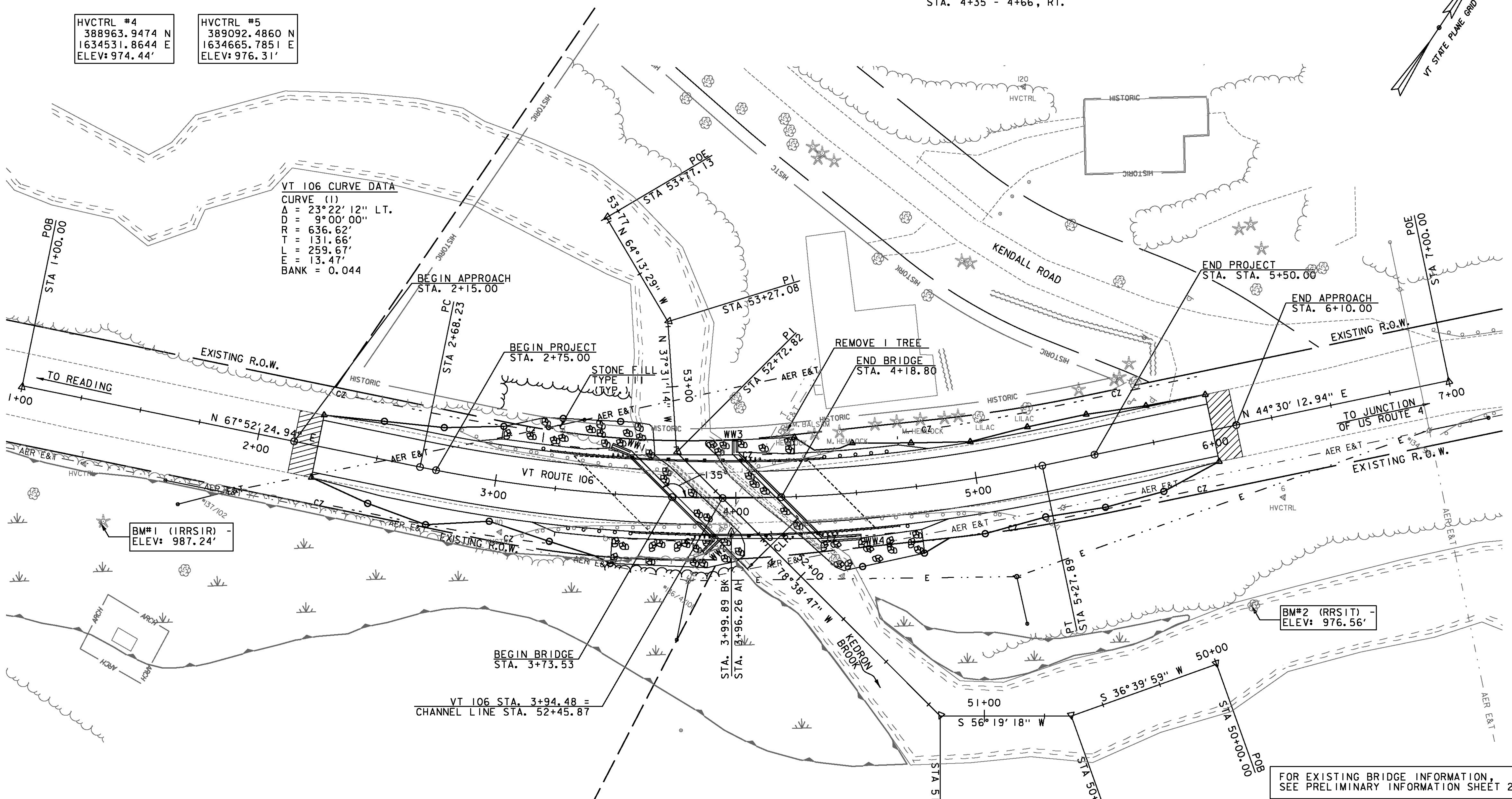

ITEM 621.30 - BOX BEAM GUARDRAIL

STA. 3+18 - 3+22, LT.  
STA. 3+41 - 3+58, RT.  
STA. 4+37 - 4+55, LT.  
STA. 4+66 - 4+70, RT.

ITEM 621.80 - REMOVAL AND DISPOSAL  
OF GUARDRAIL

STA. 2+82 - 3+72, LT.  
STA. 3+11 - 3+97, RT.  
STA. 4+04 - 4+43, LT.  
STA. 4+27 - 5+13, RT.

LAYOUT PLAN  
SCALE: 1" = 20'-0" @ FULL SIZE  
0 20 40

FOR EXISTING BRIDGE INFORMATION,  
SEE PRELIMINARY INFORMATION SHEET 2

|                   |                |
|-------------------|----------------|
| PROJECT NAME:     | WOODSTOCK      |
| PROJECT NUMBER:   | BRF 015(21)    |
| FILE NAME:        | z10c426bdr.dgn |
| PROJECT LEADER:   | G. BOGUE       |
| DESIGNED BY:      | J. HUNGERFORD  |
| LAYOUT PLAN - LPI |                |
| PLOT DATE:        | 9/2/2015       |
| DRAWN BY:         | E. ALLING      |
| CHECKED BY:       | I. MAYNARD     |
| SHEET             | 10 OF 50       |

