

Concrete  
 1. Min Design - 4000 PSI  
 2. Shipping Strength - 4000 PSI  
 3. Handling Strength - 4000 PSI  
 4. Slipping Strength - 4000 PSI

Coating Precast Concrete Units  
 1. Water repellent. Silane shall be applied to all outside face of Wing Walls only.

Precast Fabrication Tolerances  
 1. Width ±1/4"  
 2. Length ±1/4"  
 3. Height ±1/4"  
 4. Horizontal Alignment ±1/4"  
 (Deviation from straight line parallel to center line of unit)

\*Wing Wall Dimensions are from Contract Drawing Sheet 23 of 54 & of Conversation w/ R. Young  
 5. Rebar Placement ± 1/2"  
 6. Rebar Length -1/4"

Name	Qty	Length	Vol (CY)	Wt (lbs)
WW-1	1	8'-10 1/2"	2.94	11,760
WW-2	1	13'-0"	4.44	17,750
WW-3	1	13'-0"	4.36	17,425
WW-4	1	13'-0"	4.24	16,950
WW-5	1	13'-0"	4.11	16,445
WW-6	1	13'-0"	3.98	15,920
WW-7	1	13'-0"	3.86	15,460
WW-8	1	13'-0"	3.77	15,075
WW-9	1	13'-0"	3.69	14,730
WW-10	1	7'-0 1/2"	1.89	7,530
WW-11	1	7'-0 1/2"	1.88	7,500
WW-12	1	7'-0 1/2"	1.87	7,470
WW-13	1	7'-0 1/2"	1.86	7,450
WW-14	1	7'-0 1/2"	1.86	7,430

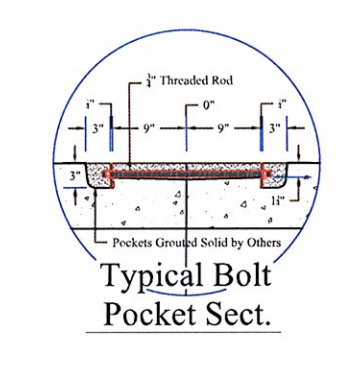

CONTRACTORS VISPE

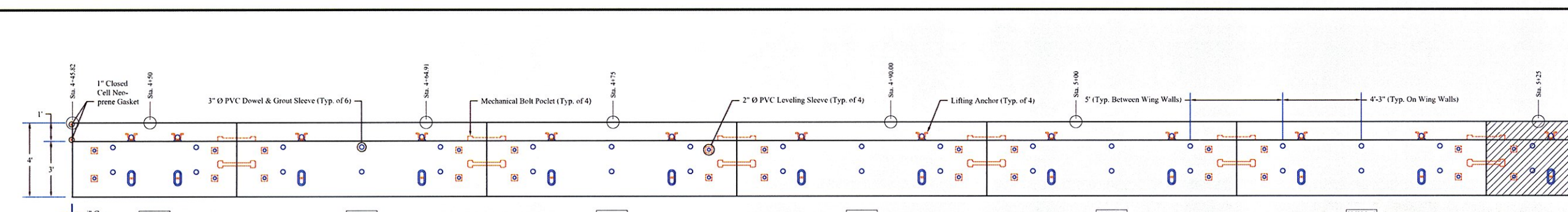

Plan View

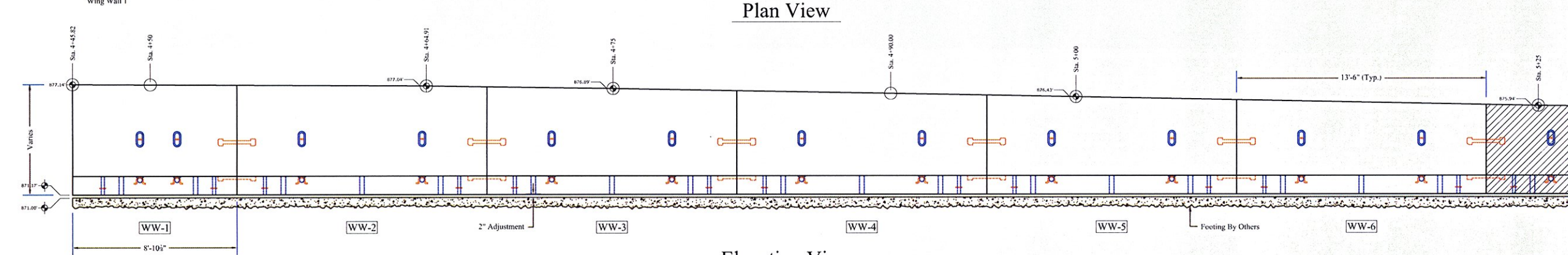

Elevation View

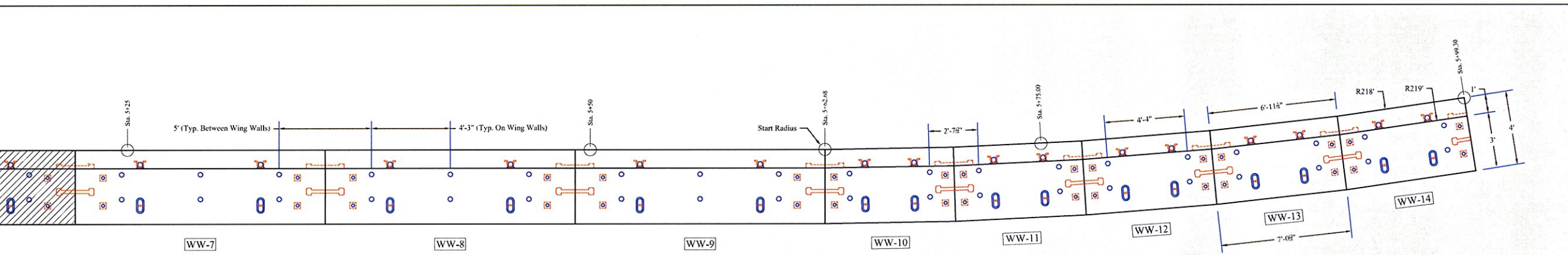

Plan View

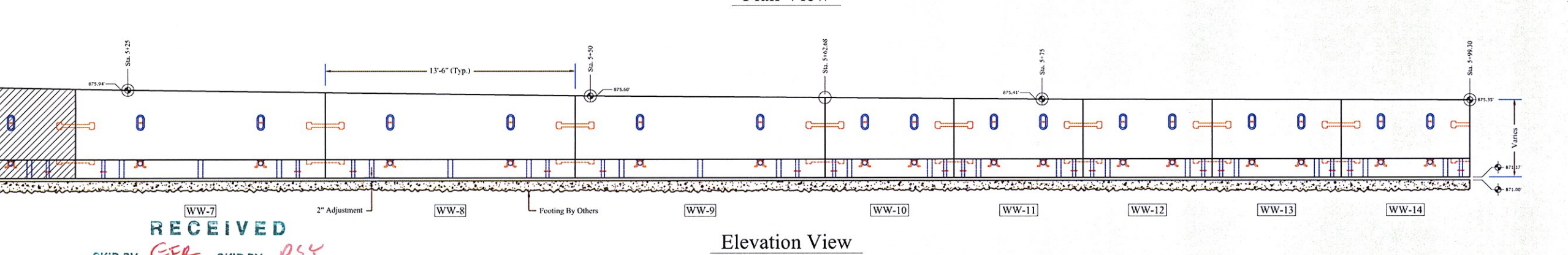

Elevation View

RECEIVED  
 OK'D BY *CFA* OK'D BY *RSY*

OCT 24 2011  
 RESUBMIT \_\_\_\_\_ APPROVED *As Noted*  
 BY *RSY* DATE 10/25/2011

PRECAST CONCRETE WING WALL SHOP DRAWINGS	CONTRACTOR: LUK BROTHERS INC.	FABRICATOR: SD Ireland
SUPERVISOR: T BROUSSEAU	PROJECT NAME: ROXBURY BRIDGE	183 INDUSTRIAL AVE. WILSTON, VT 05495
DETAILER: C. DUPLANTIS	PROJECT NUMBER: BHF 0187 (8)	TEL: (802) 561-4321 FAX: (802) 568-9201
CHECKER: T. BROUSSEAU	LOCATION: ROXBURY, VT	PRECAST DIVISION
ENGINEER: ENGINEERING VENTURES	BRIDGE: #15 ON ROUTE 12A	10/24/11 LAYOUT PLAN, ELEVATION & NOTES/SCHEDULE 1 OF 2