

END REINFORCING PLAN
 TYPICAL ALL UNITS
 SCALE 1/2" = 1'-0"

NOTE:
 NF = NEAR FACE
 FF = FAR FACE
 EF = EACH FACE
 ▲ = CUT TO FIT IN FIELD
 3" CLEAR, UNLESS OTHERWISE SPECIFIED ON THE PLANS.
 2'-2" BAR LAP UNLESS OTHERWISE SPECIFIED ON THE PLANS.

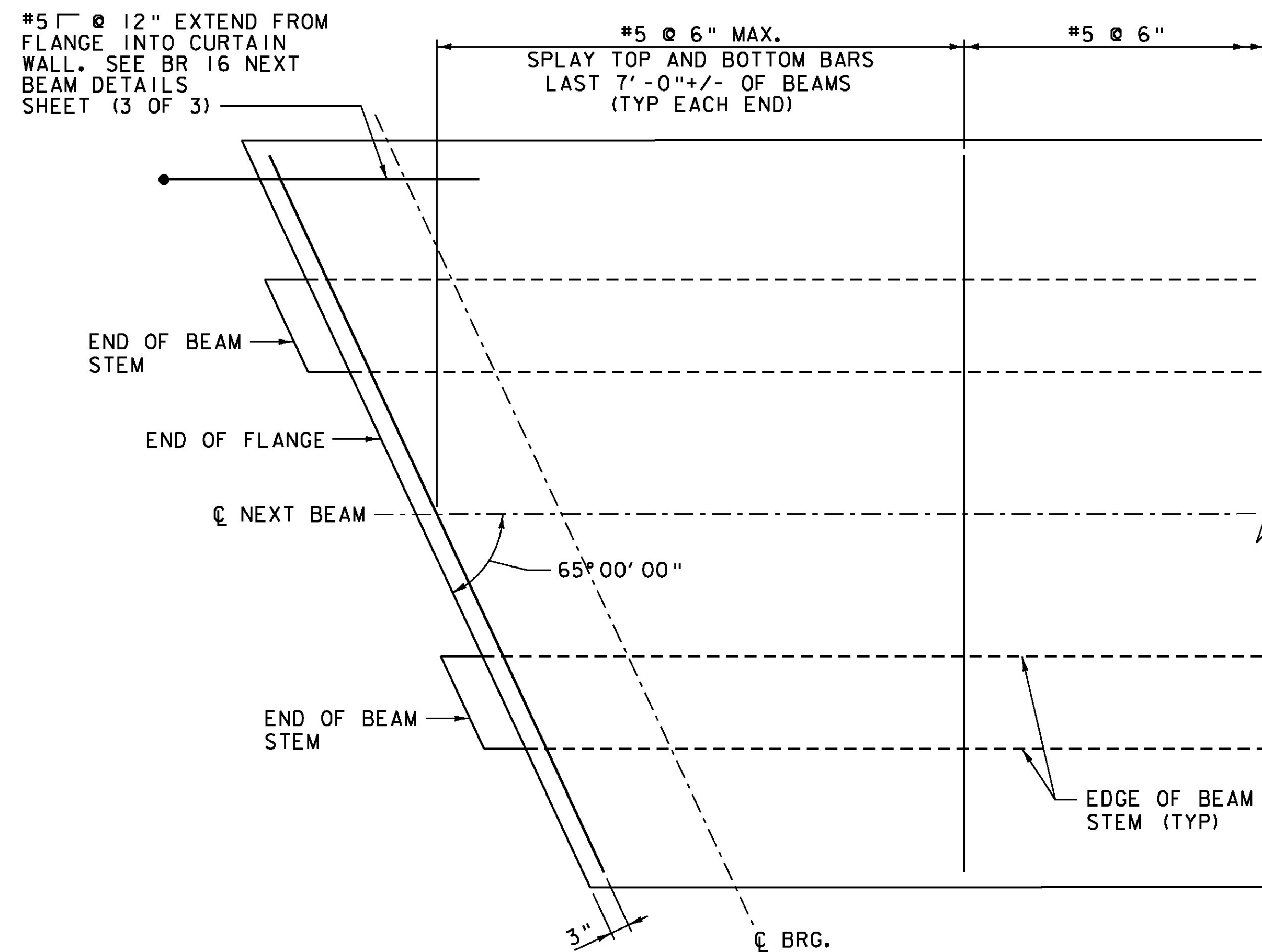

TYPICAL TRANSVERSE FLANGE REINFORCING STEEL DETAIL
 TYPICAL ALL UNITS
 SCALE 3/4" = 1'-0"

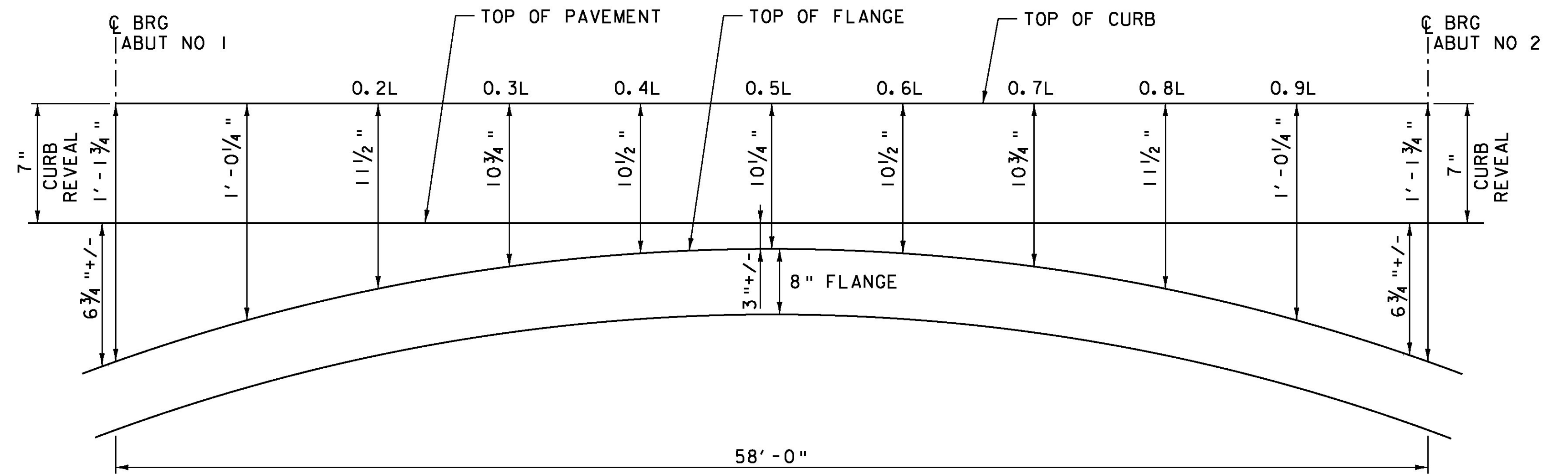

CURB HEIGHT DETAIL
 NOT TO SCALE
 (BEAM 1 SHOWN, BEAM 3 SIMILAR)

NOTE:
 NF = NEAR FACE
 FF = FAR FACE
 EF = EACH FACE
 ▲ = CUT TO FIT IN FIELD
 3" CLEAR, UNLESS OTHERWISE SPECIFIED ON THE PLANS.
 2'-2" BAR LAP UNLESS OTHERWISE SPECIFIED ON THE PLANS.

PROJECT NAME: ROCHESTER	PLOT DATE: 8/19/2013
PROJECT NUMBER: BRF 0162(17)	DRAWN BY: B.J. MASSE
FILE NAME: z85e035sup.dgn	CHECKED BY: L.S. CHERVINCKY
PROJECT LEADER: G.S. GOODRICH	SHEET 149 OF 238
DESIGNED BY: J.J. WESTCOTT	
BR 16 NEXT BEAM DETAILS (2 OF 3)	

