

**W-503L**  
#5 BENT BAR  
LEVEL II (DUAL COATED)  
USE 2 3/4" (70 mm) PIN  
(22) REQ'D.

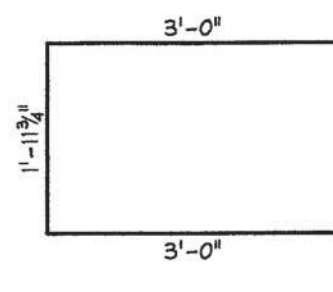

**W-504L**  
#5 BENT BAR  
LEVEL II (DUAL COATED)  
USE 2 3/4" (70 mm) PIN  
(64) REQ'D.

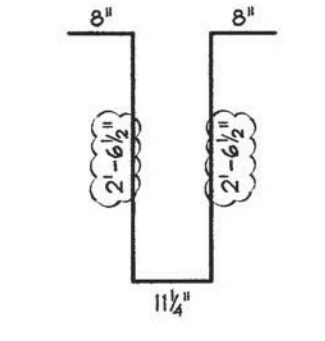

**W-401L**  
#4 BENT BAR  
LEVEL II (DUAL COATED)  
USE 2" (50 mm) PIN  
(84) REQ'D.

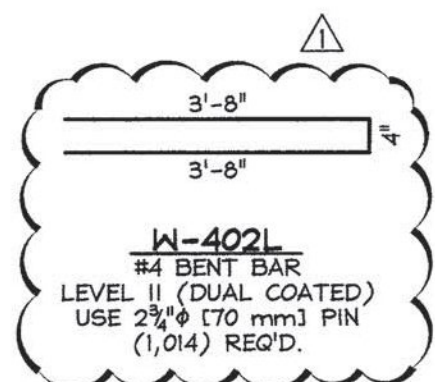

**W-402L**  
#4 BENT BAR  
LEVEL II (DUAL COATED)  
USE 2 3/4" (70 mm) PIN  
(1,014) REQ'D.

**PRESTRESSED NEXT BEAMS**

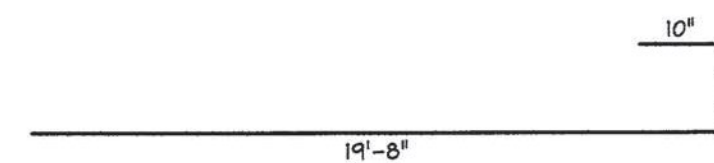

**W-901L**  
#4 BENT BAR  
LEVEL II (DUAL COATED)  
USE 6" PIN  
(64) REQ'D.

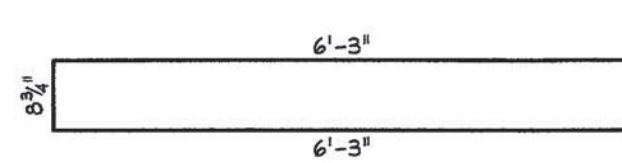

**W-501L**  
#5 BENT BAR  
LEVEL II (DUAL COATED)  
USE 2 3/4" (70 mm) PIN  
(156) REQ'D.

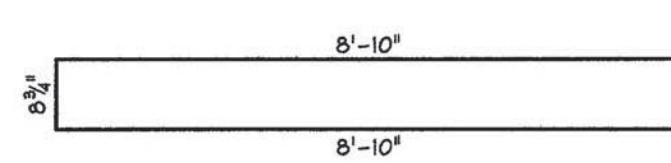

**W-502L**  
#5 BENT BAR  
LEVEL II (DUAL COATED)  
USE 2 3/4" (70 mm) PIN  
(78) REQ'D.

**PRECAST APPROACH SLABS**

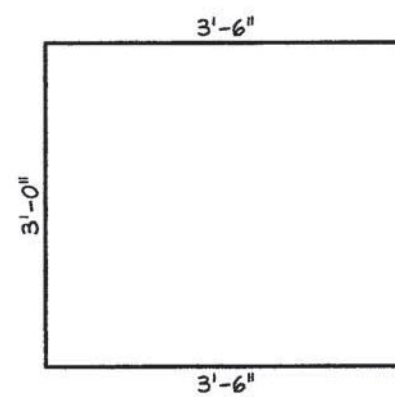

**W-505L**  
#5 BENT BAR  
LEVEL II (DUAL COATED)  
USE 2 3/4" (70 mm) PIN  
(58) REQ'D.

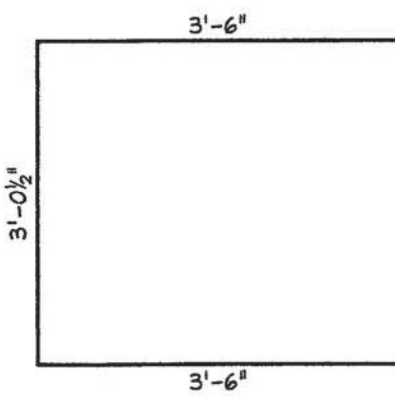

**W-506L**  
#5 BENT BAR  
LEVEL II (DUAL COATED)  
USE 2 3/4" (70 mm) PIN  
(4) REQ'D.

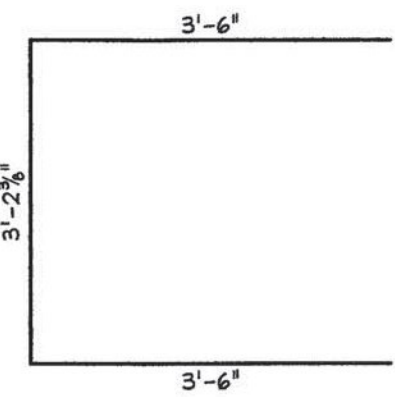

**W-507L**  
#5 BENT BAR  
LEVEL II (DUAL COATED)  
USE 2 3/4" (70 mm) PIN  
(4) REQ'D.

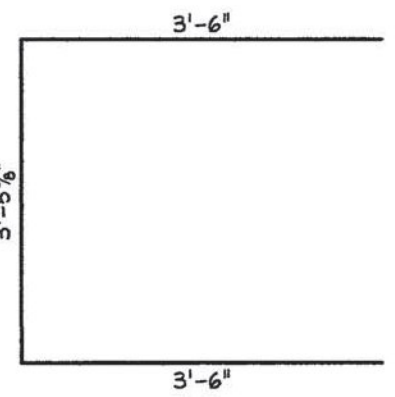

**W-508L**  
#5 BENT BAR  
LEVEL II (DUAL COATED)  
USE 2 3/4" (70 mm) PIN  
(20) REQ'D.

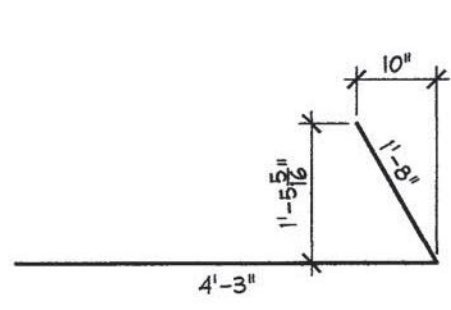

**W-601L**  
#6 BENT BAR  
LEVEL II (DUAL COATED)  
USE 4" (100 mm) PIN  
(40) REQ'D.

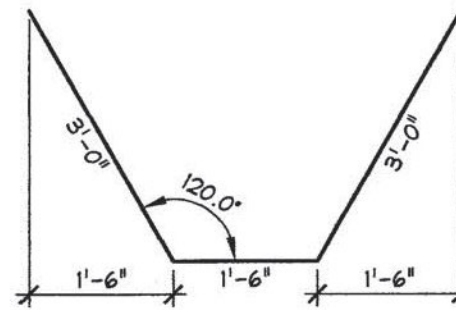

**W-602L**  
#6 BENT BAR  
LEVEL II (DUAL COATED)  
USE 4" (100 mm) PIN  
(16) REQ'D.

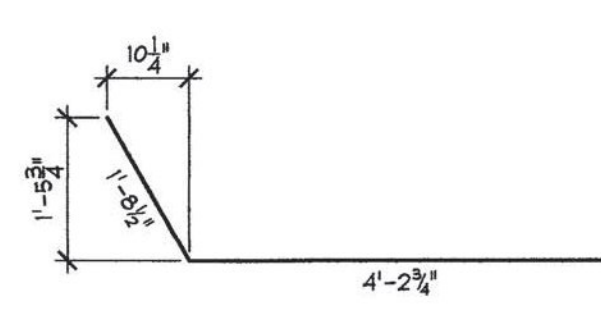

**W-603L**  
#6 BENT BAR  
LEVEL II (DUAL COATED)  
USE 4" (100 mm) PIN  
(40) REQ'D.

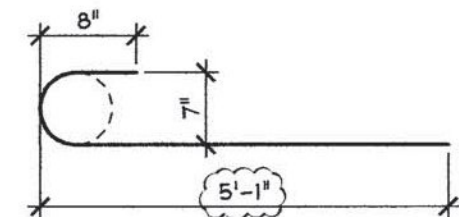

**W-701L**  
#7 BENT BAR  
LEVEL II (DUAL COATED)  
USE 5" PIN  
(78) REQ'D.

**PRECAST ABUTMENTS**

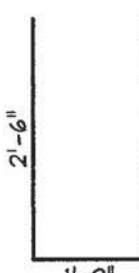

**W-509L**  
#5 BENT BAR  
LEVEL II (DUAL COATED)  
USE 2 3/4" (70 mm) PIN  
(80) REQ'D.

**PRECAST WING WALLS**

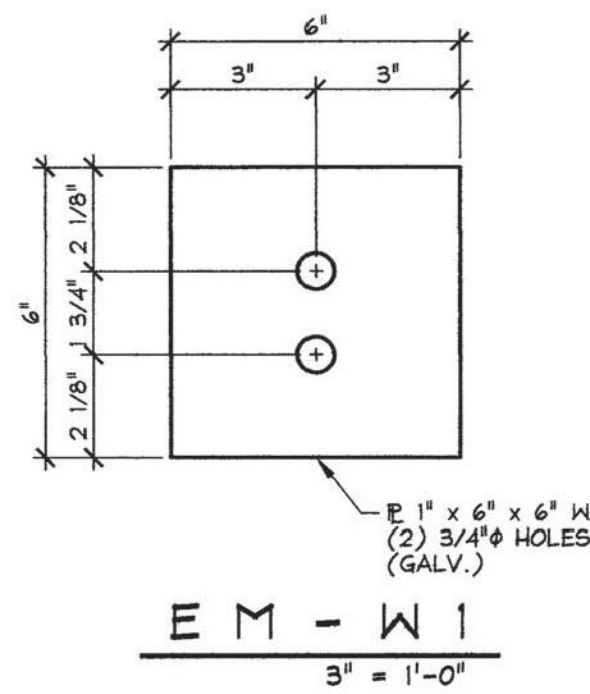

**EM - W1**  
E 1" x 6" x 6" W/  
(2) 3/4" HOLES  
(GALV.)  
3" = 1'-0"

MISCELLANEOUS MATERIALS				
ITEM	MARK	QTY.	DESCRIPTION	REMARKS
1		88	#4 x 8'-9" (LEVEL II, DUAL COATED)	
2				
3		1,360	#5 x 8'-9" (LEVEL II, DUAL COATED)	
4		44	#5 x 92'-8" (W/ (1) 2'-6" STAGGERED LAP) (LVL. II, DUAL COATED)	
5		44	#5 x 84'-8" (W/ (1) 2'-6" STAGGERED LAP) (LVL. II, DUAL COATED)	
6				
7				
8		20	GUARD RAIL ANCHOR PLATE (GALV.)	SUPPLIED BY OTHERS
9		16	SET OF (4) 0.60" x 270 KSI STRAND LIFTING LOOPS	
10				
11	MK-W2	32	4T x 7 1/8" SWIFT LIFT LIFTER	
12				
13		64	#6 x 19'-7" (LEVEL II, DUAL COATED)	
14				
15				
16				
17				
18				
19				
20				
21		72	#5 x 3'-7" (LEVEL II, DUAL COATED)	
22		84	#5 x 4'-3" (LEVEL II, DUAL COATED)	
23		82	#5 x 5'-0" (LEVEL II, DUAL COATED)	
24		16	#5 x 9'-0" (LEVEL II, DUAL COATED)	
25		16	#5 x 2'-10 1/2" (LEVEL II, DUAL COATED)	
26		14	#5 x 21'-6" (LEVEL II, DUAL COATED)	
27		14	#5 x 23'-11" (LEVEL II, DUAL COATED)	
28				
29		82	#7 x 5'-0" (LEVEL II, DUAL COATED)	
30		16	#7 x 9'-0" (LEVEL II, DUAL COATED)	
31		16	#7 x 2'-10 1/2" (LEVEL II, DUAL COATED)	
32		14	#7 x 22'-3" (LEVEL II, DUAL COATED)	
33		14	#7 x 23'-2" (LEVEL II, DUAL COATED)	
34				
35		2	2'-0" x 5'-11 1/2" CORRUGATED STEEL PIPE (GALV.)	
36		2	2'-0" x 5'-11" CORRUGATED STEEL PIPE (GALV.)	
37		2	2'-0" x 5'-9 1/4" CORRUGATED STEEL PIPE (GALV.)	
38		2	2'-0" x 5'-8 3/4" CORRUGATED STEEL PIPE (GALV.)	
39	MK-W6	8	20T x 19 3/4" SWIFT LIFT LIFTER	
40				
41				
42	EM-W1	24	E 1" x 6" x 6" W/ (2) 3/4" HOLES (GALV.)	FOR ERECTION; SEE DETAIL THIS SHEET
43		24	1/2" x 49'-0" POLY-STRAND	FOR ERECTION
44		48	1/2" SINGLE USE STRESSING CHUCK	FOR ERECTION
45			COMPRESSIBLE SEALER SELF ADHESIVE	FOR ERECTION
46		80	#5 x 8'-6" (LEVEL II, DUAL COATED)	
47				
48		40	#6 x 8'-7" (LEVEL II, DUAL COATED)	
49		40	#6 x 9'-1" (LEVEL II, DUAL COATED)	
50				
51	MK-W3	80	N#B SPLICE SLEEVE TU-X(PG) (EPOXY COATED) W/ GROUT TUBES	GROUT TUBE LENGTH AS REQ'D.
52	MK-W4	16	4T x 5 1/2" SWIFT LIFT LIFTER	
53	MK-W5	8	8T x 13 3/8" SWIFT LIFT LIFTER	
54				
55				

1-16-14 REVISED AS NOTED

APPROVAL STAMP:

Vermont Agency of Transportation  
**RECEIVED**

CK'D BY JDG/JW OK'D BY WDL

January 27, 2014

RESUBMIT No Approved  
BY KMH DATE 02/10/2014

J.P. CARRARA & SONS INC.  
Precast & Prestress Manufacturer  
2864 ONE STR. MIDDLEBURY, VERMONT 05753 Phone: (802) 388-4361 Fax: (802) 388-9010

MILLER CONSTRUCTION, INC.  
CONTRACTOR  
BARNARD, VERMONT

STATE OF VERMONT AGENCY OF TRANSPORTATION  
COUNTY OF WINDSOR

TOWN OF BARNARD  
VT ROUTE 12, MAJOR COLLECTOR  
BRIDGE NO.: 25 PROJECT NO.: ER BRF 0241(39)

MATERIALS LIST

DATE: DEC. 18, 2013

SCALE: NOTED

CHKD: - DFTM: B.L.

JOB NO: 23413-013

DWG. NO: M1

PRESTRESSED NEXT BEAMS  
PRECAST APPROACH SLABS  
PRECAST ABUTMENTS  
PRECAST WING WALLS