

10A STA. 176+40 LT 21' TO STA. 176+60 LT 21' REMOVE EXISTING 15" CMP INSTALL NEW 15" CPEP (20'-0")

8A STA. 172+50 RT TO STA. 172+24 LT REMOVE EXISTING CMP INSTALL NEW 18" CPEP (49'-0")

10 STA. 175+22.05 LT 30.24' TO STA. 176+25.43 RT 34.47' REMOVE EXISTING PIPE INSTALL NEW 18" CPEP (106'-0") INV. IN = 1370.05' INV. OUT = 1364.95'

CURVE #23  
 DELTA = 135°53'00"  
 D = 0°11'28" (1) D = 3°28'59" (2) D = 33°42'12" (3) D = 163°42'08" (4) D = 95°48'44" (5) D = 9°57'52" (6)  
 R = 30000.00' (1) R = 1645.00' (2) R = 170.00' (3) R = 35.00' (4) R = 59.80' (5) R = 575.00' (6)  
 T = 1025.54' (1) T = 293.19' (2)  
 L = 437.82' (1) L = 378.08' (2) L = 50.95' (3) L = 20.71' (4) L = 66.17' (5) L = 74.38' (6)  
 E = 17.52'  
 BANKING NORMAL CROWN, 0.035 FT/FT, 0.080 FT/FT, 0.080 FT/FT, 0.080 FT/FT, 0.067 FT/FT  
 DESIGN SPEED 25 MPH  
 SEE SUPERELEVATION DIAGRAMS AND GRADING PLAN FOR MORE INFORMATION

9 STA. 173+86.00 LT 21.00' TO STA. 174+28.00 LT 21.00' REMOVE EXISTING 12" CMP INSTALL NEW 12" CPEP (41'-6") INV. IN = 1361.25' INV. OUT = 1359.80'

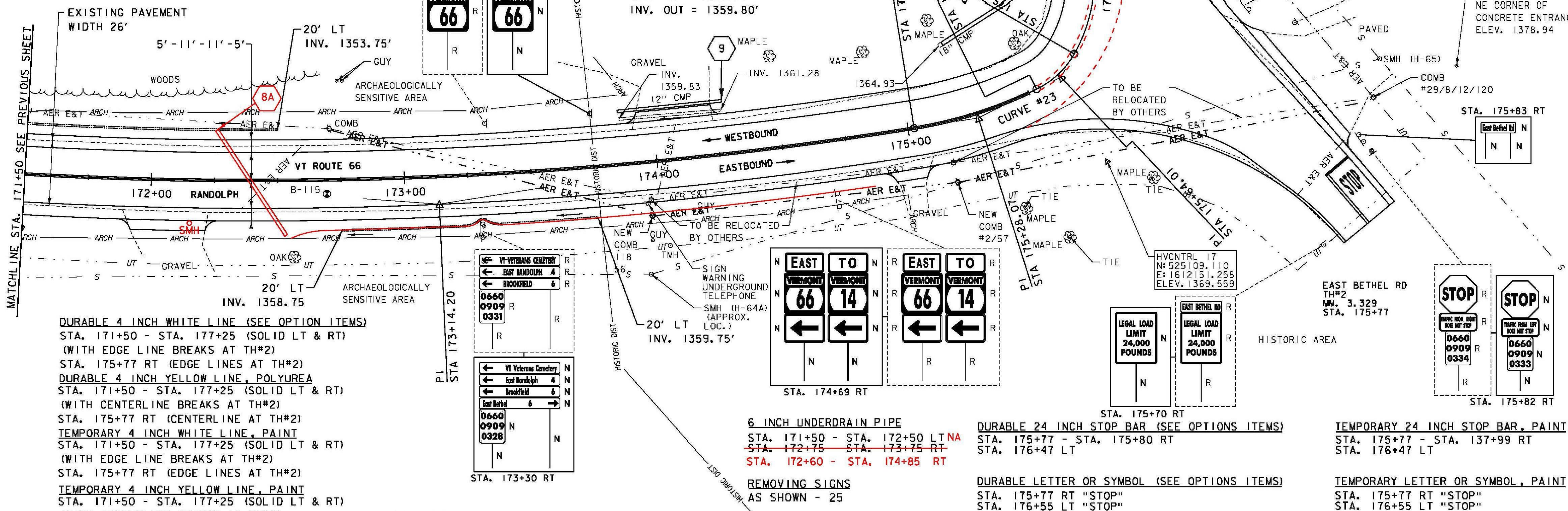

MATCHLINE STA. 171+50 SEE PREVIOUS SHEET

VT STATE PLANE GRID

DURABLE 4 INCH WHITE LINE (SEE OPTION ITEMS)  
 STA. 171+50 - STA. 177+25 (SOLID LT & RT)  
 (WITH EDGE LINE BREAKS AT TH#2)  
 STA. 175+77 RT (EDGE LINES AT TH#2)  
 DURABLE 4 INCH YELLOW LINE, POLYUREA  
 STA. 171+50 - STA. 177+25 (SOLID LT & RT)  
 (WITH CENTERLINE BREAKS AT TH#2)  
 STA. 175+77 RT (CENTERLINE AT TH#2)  
 TEMPORARY 4 INCH WHITE LINE, PAINT  
 STA. 171+50 - STA. 177+25 (SOLID LT & RT)  
 (WITH EDGE LINE BREAKS AT TH#2)  
 STA. 175+77 RT (EDGE LINES AT TH#2)  
 TEMPORARY 4 INCH YELLOW LINE, PAINT  
 STA. 171+50 - STA. 177+25 (SOLID LT & RT)  
 (WITH CENTERLINE BREAKS AT TH#2)  
 STA. 175+77 RT (CENTERLINE AT TH#2)

**SIGN LEGEND**

R = REMOVE  
 R&S = REMOVE AND SALVAGE  
 RET = RETAIN  
 S = SALVAGE  
 N = NEW  
 B-B = BACK TO BACK  
 --- = EXISTING  
 — = NEW

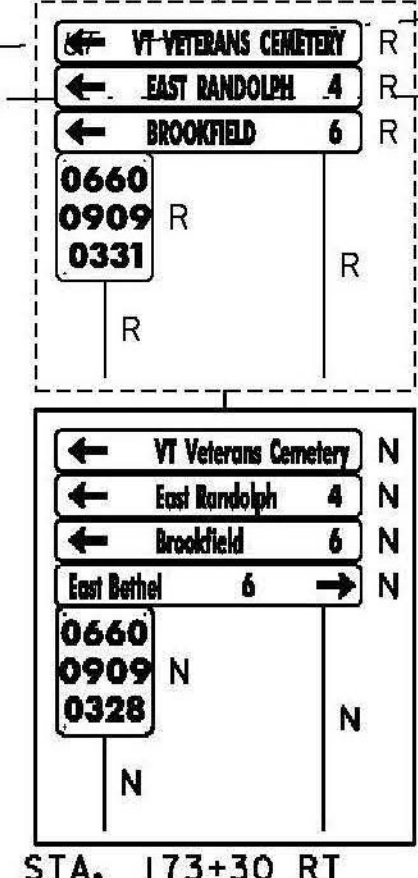

6 INCH UNDERDRAIN PIPE  
 STA. 171+50 - STA. 172+50 LT NA  
 STA. 172+75 - STA. 173+75 RT  
 STA. 172+60 - STA. 174+85 RT

REMOVING SIGNS  
 AS SHOWN - 25

DURABLE 24 INCH STOP BAR (SEE OPTIONS ITEMS)  
 STA. 175+77 - STA. 175+80 RT  
 STA. 176+47 LT

DURABLE LETTER OR SYMBOL (SEE OPTIONS ITEMS)  
 STA. 175+77 RT "STOP"  
 STA. 176+55 LT "STOP"

TEMPORARY 24 INCH STOP BAR, PAINT  
 STA. 175+77 - STA. 137+99 RT  
 STA. 176+47 LT

TEMPORARY LETTER OR SYMBOL, PAINT  
 STA. 175+77 RT "STOP"  
 STA. 176+55 LT "STOP"



PROJECT NAME: RANDOLPH  
 PROJECT NUMBER: STP 2932 (1)

FILE NAME: z10c270.dgn  
 PROJECT LEADER: C. LATHROP  
 DESIGNED BY: B. BRESLEND  
 PROJECT LAYOUT SHEET 27

PLOT DATE: 6/5/2014  
 DRAWN BY: B. BRESLEND  
 CHECKED BY: C. LATHROP  
 SHEET 58 OF 276