

CURVE #110
 DELTA = 6°44'05"
 D = 5°43'46"
 R = 1000.00'
 T = 58.84'
 L = 117.54'
 E = 1.73'

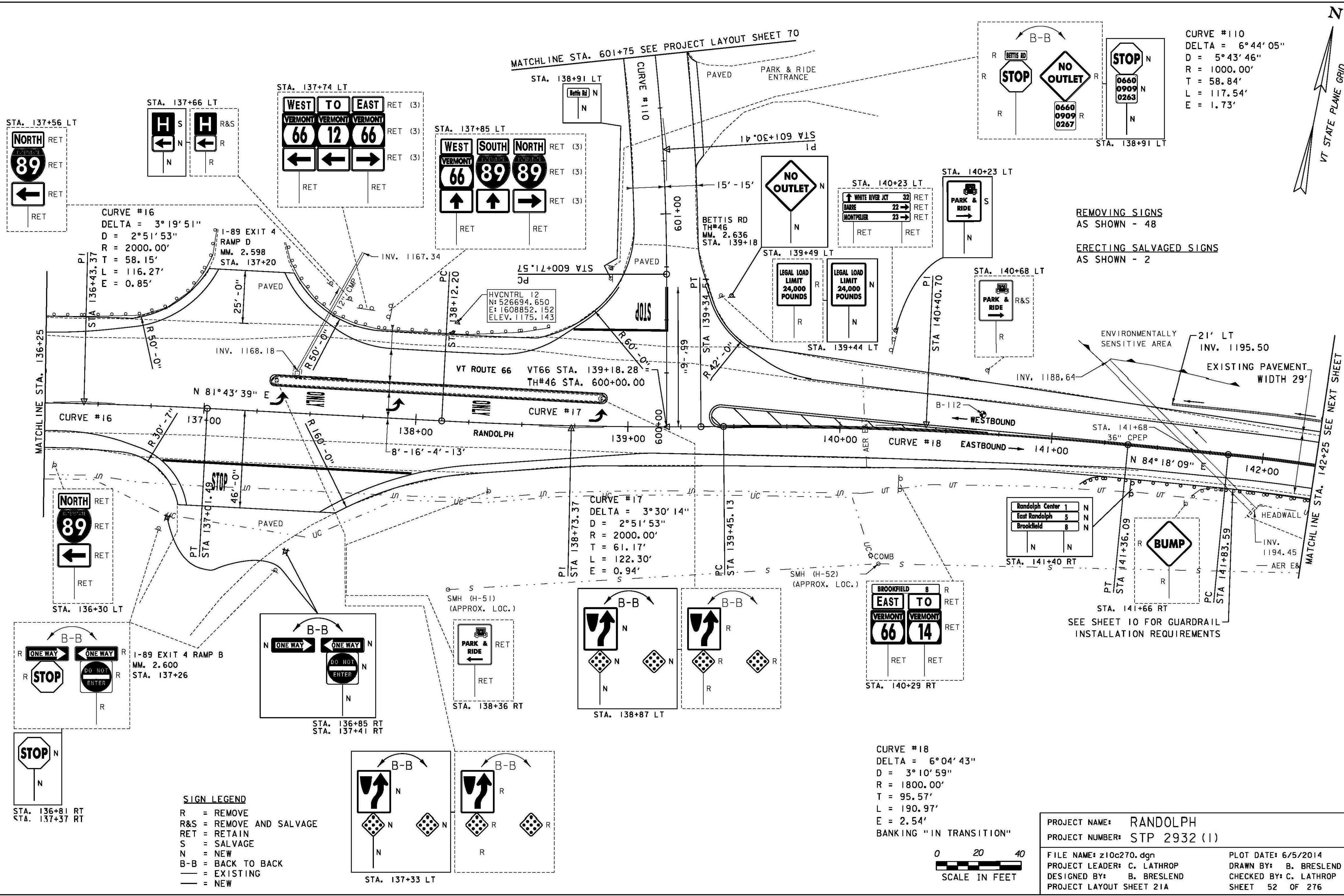

REMOVING SIGNS
 AS SHOWN - 48

ERECTING SALVAGED SIGNS
 AS SHOWN - 2

SEE SHEET 10 FOR GUARDRAIL
 INSTALLATION REQUIREMENTS

SIGN LEGEND
 R = REMOVE
 R&S = REMOVE AND SALVAGE
 RET = RETAIN
 S = SALVAGE
 N = NEW
 B-B = BACK TO BACK
 — = EXISTING
 — = NEW

CURVE #18
 DELTA = 6°04'43"
 D = 3°10'59"
 R = 1800.00'
 T = 95.57'
 L = 190.97'
 E = 2.54'
 BANKING "IN TRANSITION"

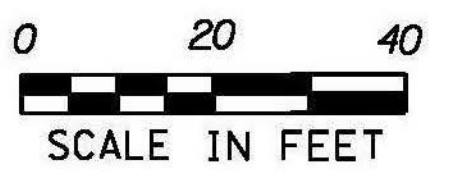

PROJECT NAME: RANDOLPH
 PROJECT NUMBER: STP 2932 (1)
 FILE NAME: z10c270.dgn
 PROJECT LEADER: C. LATHROP
 DESIGNED BY: B. BRESLEND
 PROJECT LAYOUT SHEET 21A
 PLOT DATE: 6/5/2014
 DRAWN BY: B. BRESLEND
 CHECKED BY: C. LATHROP
 SHEET 52 OF 276