

DURABLE 4 INCH WHITE LINE (SEE OPTION ITEMS)
 STA. 66+75 - STA. 72+50 (SOLID LT & RT)
 (WITH EDGE LINE BREAKS AT TH#43)
 STA. 68+38 LT (EDGE LINES AT TH#43)

DURABLE 4 INCH YELLOW LINE, POLYUREA
 STA. 66+75 - STA. 72+50 (SOLID LT & RT)
 (WITH CENTERLINE BREAKS AT TH#43)
 STA. 68+38 LT (CENTERLINE AT TH#43)

MILLED RUMBLE STRIPS
 STA. 66+75 - STA. 72+50 CTR
 (WITH BREAKS AT TH#43)

TEMPORARY 4 INCH WHITE LINE, PAINT
 STA. 66+75 - STA. 72+50 (SOLID LT & RT)
 (WITH EDGE LINE BREAKS AT TH#43)
 STA. 68+38 LT (EDGE LINES AT TH#43)

TEMPORARY 4 INCH YELLOW LINE, PAINT
 STA. 66+75 - STA. 72+50 (SOLID LT & RT)
 (WITH CENTERLINE BREAKS AT TH#43)
 STA. 68+38 LT (CENTERLINE AT TH#43)

REMOVING SIGNS
 AS SHOWN - 4

RELOCATE MAILBOX, SINGLE SUPPORT
 STA. 68+14 RT

REMOVAL AND DISPOSAL OF GUARDRAIL
 STA. 66+75 - STA. 68+26 RT
 STA. 68+57 - STA. 70+44 RT
 STA. 72+41 - STA. 72+50 RT

STEEL BEAM GUARDRAIL, GALVANIZED
 STA. 72+40 - STA. 72+50 RT

ANCHOR FOR STEEL BEAM RAIL
 STA. 72+40 RT

DURABLE 24 INCH STOP BAR (SEE OPTIONS ITEMS)
 STA. 68+13 - STA. 68+39 LT

DURABLE LETTER OR SYMBOL (SEE OPTIONS ITEMS)
 STA. 68+32 LT "STOP"

TEMPORARY 24 INCH STOP BAR, PAINT
 STA. 68+13 - STA. 68+39 LT

TEMPORARY LETTER OR SYMBOL, PAINT
 STA. 68+32 LT "STOP"

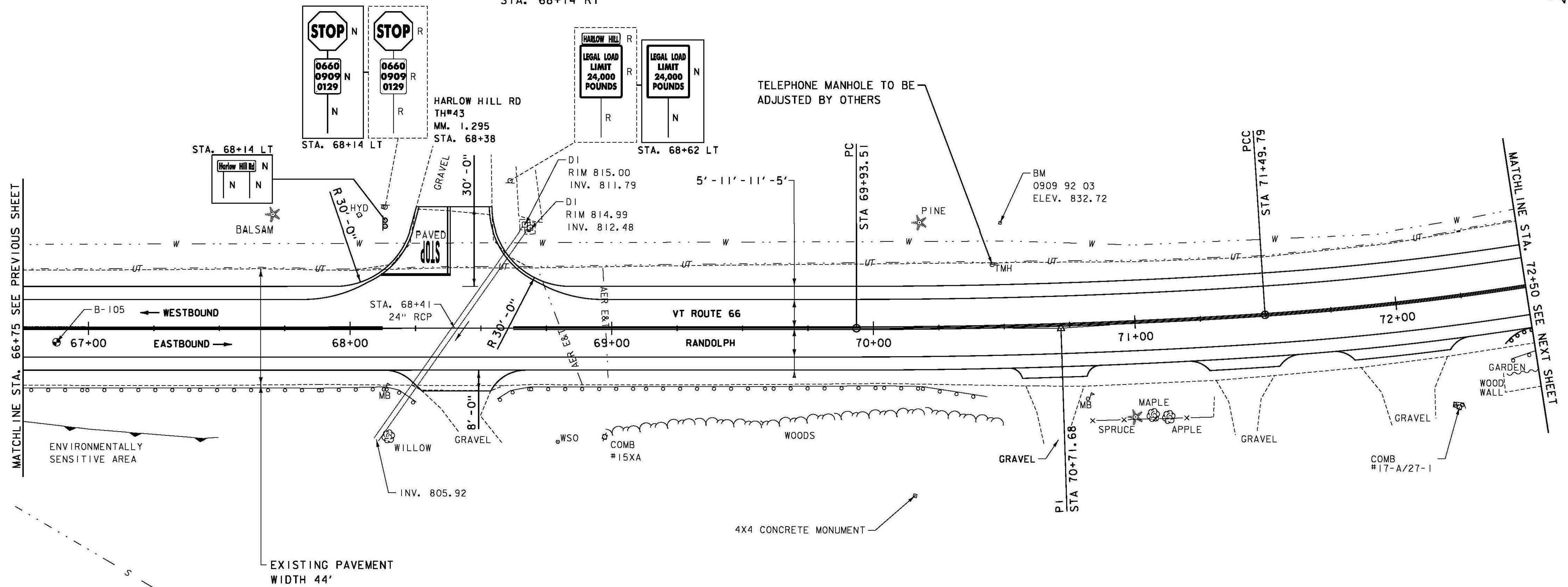

ENVIRONMENTALLY SENSITIVE LOCATIONS:

NO.	LIMITS	POS.	TYPE
1.	STA. 66+75 - STA. 67+50	RT	-

SIGN LEGEND

- R = REMOVE
- R&S = REMOVE AND SALVAGE
- RET = RETAIN
- S = SALVAGE
- N = NEW
- B-B = BACK TO BACK
- = EXISTING
- = NEW

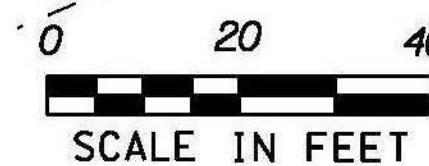

PROJECT NAME: RANDOLPH
 PROJECT NUMBER: STP 2932 (1)

FILE NAME: z10c270.dgn
 PROJECT LEADER: C. LATHROP
 DESIGNED BY: B. BRESLEND
 PROJECT LAYOUT SHEET 9

PLOT DATE: 6/5/2014
 DRAWN BY: B. BRESLEND
 CHECKED BY: C. LATHROP
 SHEET 38 OF 276